

**CENTRAL WEST END CERTIFIED LOCAL HISTORIC DISTRICT**

LINDELL BLVD.

THE PREPARATION OF THIS MAP WAS FINANCED WHOLLY THROUGH A GRANT FROM THE DEPARTMENT OF HOUSING AND URBAN DEVELOPMENT AND THE COMMUNITY DEVELOPMENT AGENCY UNDER THE PROVISIONS OF TITLE I OF THE HOUSING AND COMMUNITY DEVELOPMENT ACT OF 1974 (P.L. 93-383).

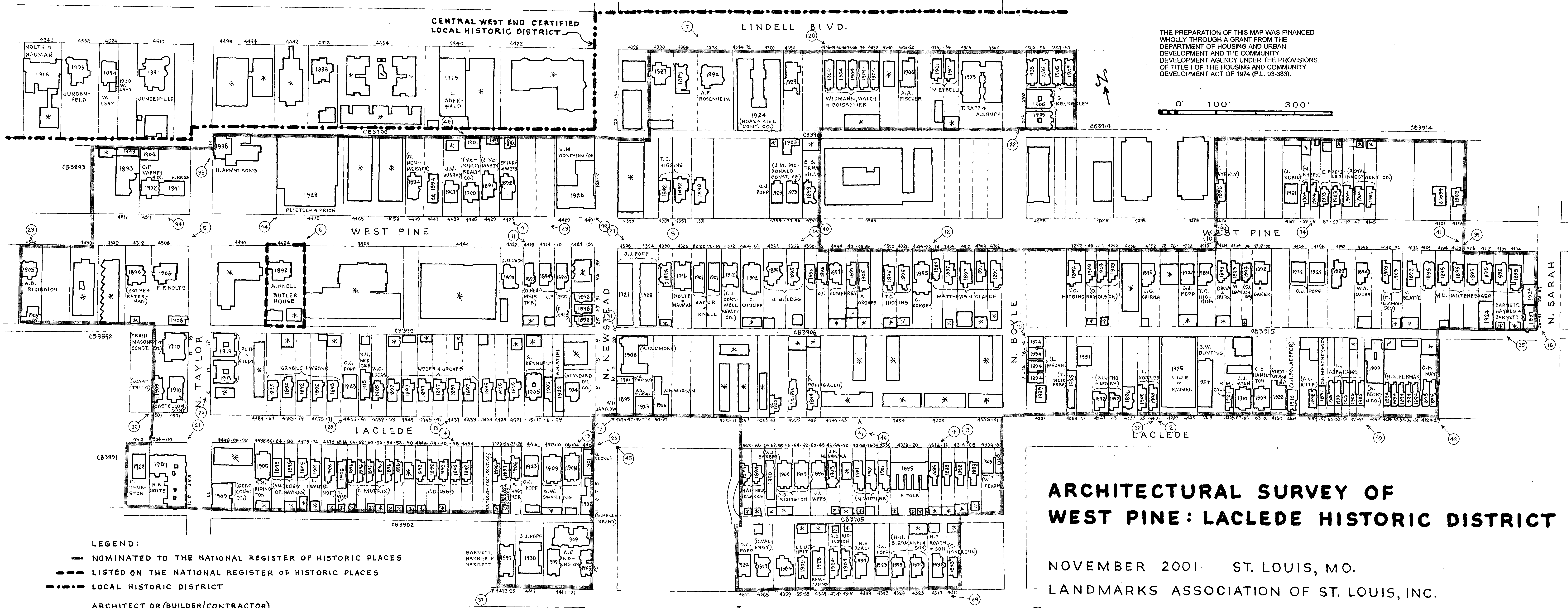
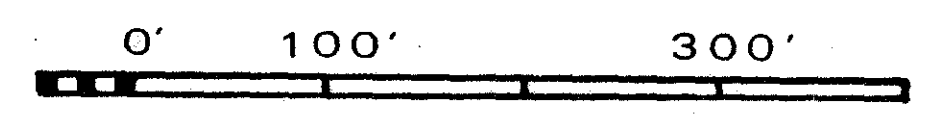

- LEGEND:**
- NOMINATED TO THE NATIONAL REGISTER OF HISTORIC PLACES
  - LISTED ON THE NATIONAL REGISTER OF HISTORIC PLACES
  - ..... LOCAL HISTORIC DISTRICT
  - ARCHITECT OR (BUILDER/CONTRACTOR)
  - \* NON-CONTRIBUTING
  - ◁ PHOTO ANGLE

**ARCHITECTURAL SURVEY OF WEST PINE: LACLEDE HISTORIC DISTRICT**

NOVEMBER 2001 ST. LOUIS, MO.

LANDMARKS ASSOCIATION OF ST. LOUIS, INC.