

FORMER NARROW GAUGE RAILROAD



ARCHITECTURAL SURVEY OF VISITATION PARK

ARCHITECTS & DATES (BUILDERS OR CONTRACTORS)

- 1890 - 99
- 1900 - 09
- 1910 - 19
- 1920 - 29

SEPTEMBER 1986 ST. LOUIS, MISSOURI
 LANDMARKS ASSOCIATION OF ST. LOUIS, INC.
 FOR THE COMMUNITY DEVELOPMENT AGENCY

- ◁ CAMERA ANGLE
- * NON-CONTRIBUTING BUILDINGS:
BUILT SINCE 1936
- LOCAL HISTORIC DISTRICT
- LOCAL HISTORIC LANDMARK

PREPARATION OF THIS MAP WAS FINANCED WHOLLY THROUGH A GRANT FROM THE DEPARTMENT OF HOUSING AND URBAN DEVELOPMENT AND THE COMMUNITY DEVELOPMENT AGENCY OF ST. LOUIS UNDER THE PROVISIONS OF TITLE I OF THE HOUSING AND COMMUNITY DEVELOPMENT ACT OF 1980 (PL96-399)

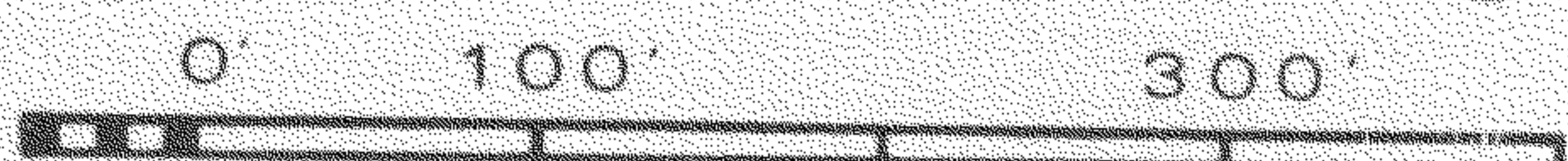

MAP: PAT HAYS BAER

