

Map I  
Survey Boundary and Evaluated Buildings

North St. Joseph Neighborhood Survey, 1993  
St. Joseph, Missouri

WYETH  
PARK  
OVER LOOK →

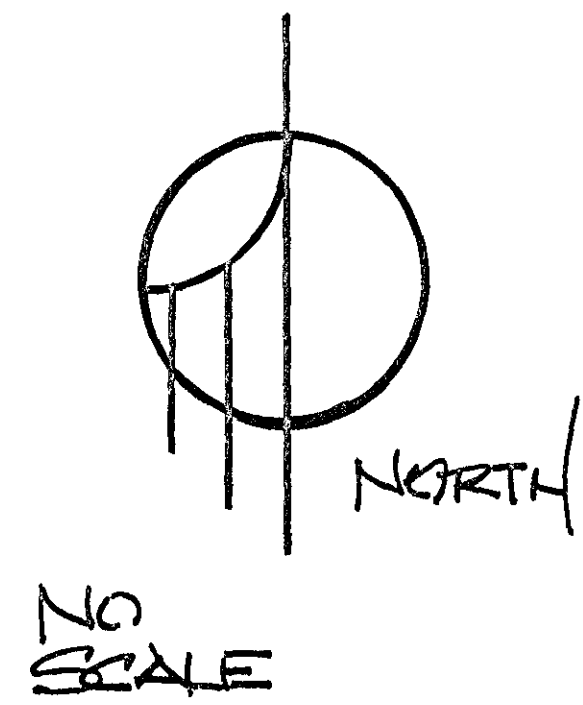

MISSOURI  
RIVER

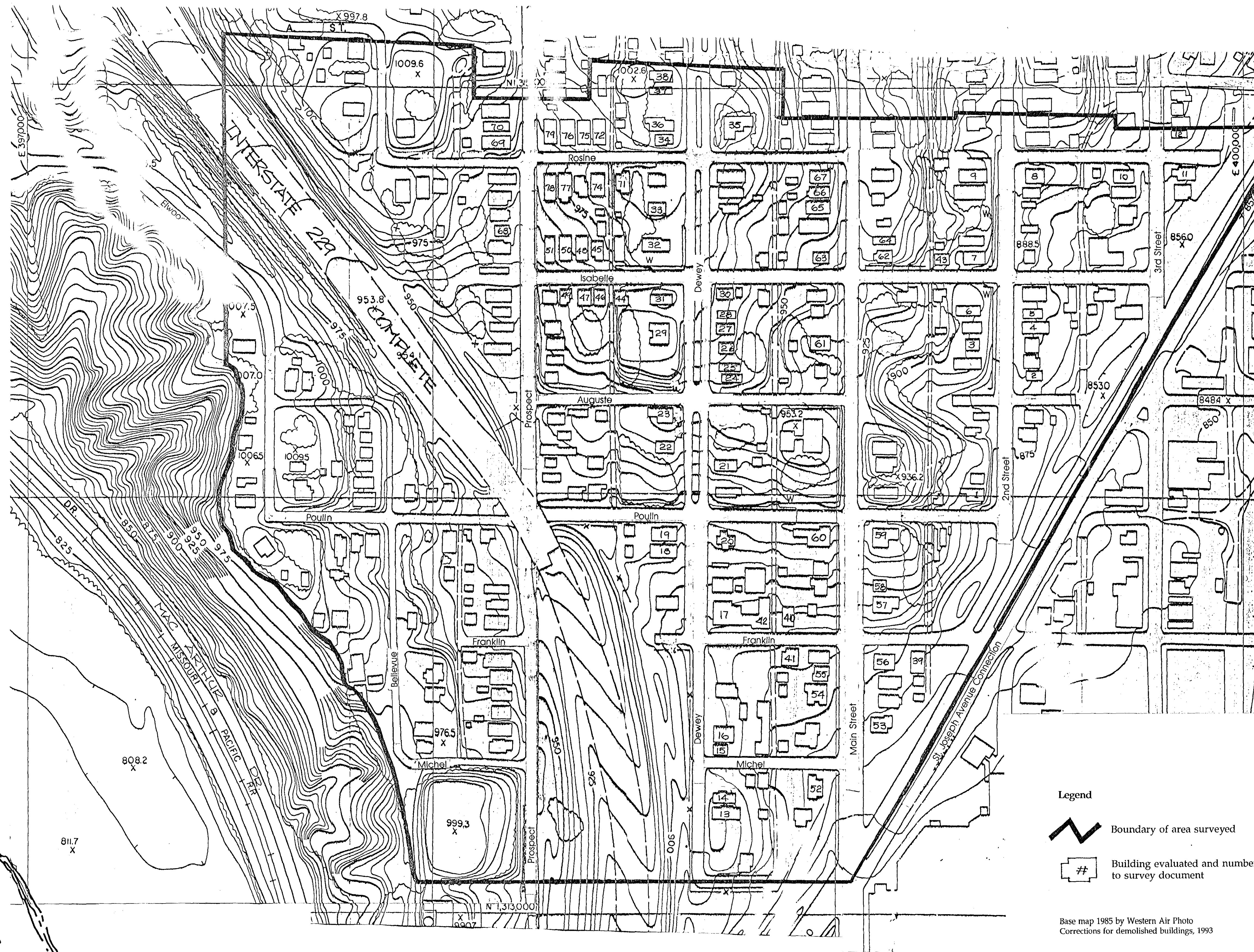

Legend

 Boundary of area surveyed

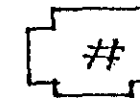
 Building evaluated and number keyed to survey document

Base map 1985 by Western Air Photo  
Corrections for demolished buildings, 1993

Map II  
Evaluation of Eligibility for National Register of Historic Places

North St. Joseph Neighborhood Survey, 1993  
St. Joseph, Missouri

WYETH  
PARK  
OVER LOOK

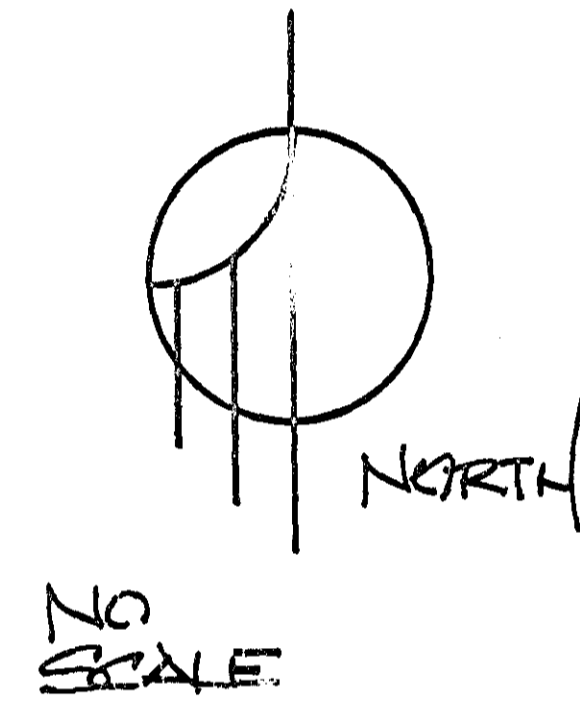



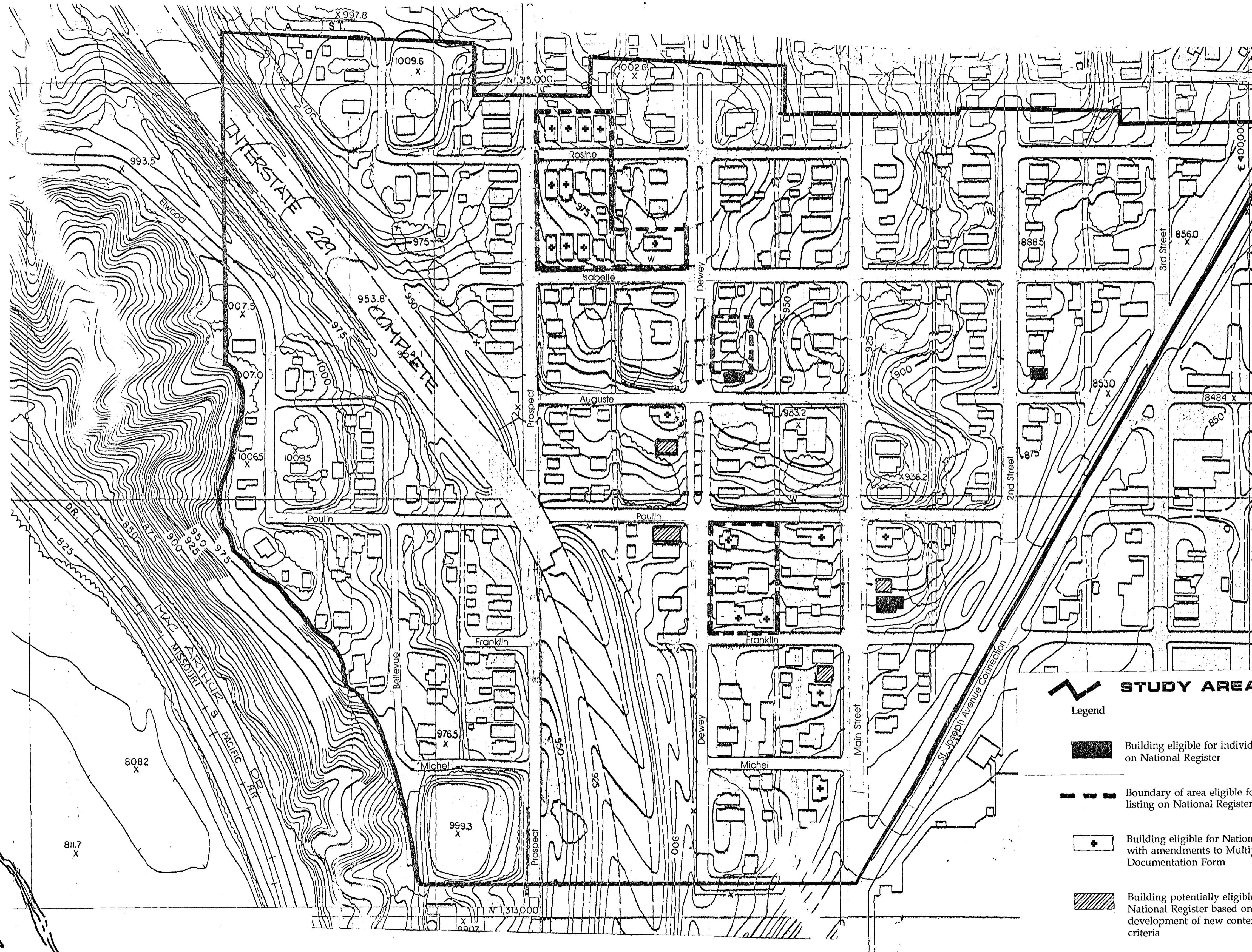

MISSOURI  
RIVER



**STUDY AREA BOUNDARY**

Legend

-  Building eligible for individual listing on National Register
-  Boundary of area eligible for district listing on National Register
-  Building eligible for National Register with amendments to Multiple Property Documentation Form
-  Building potentially eligible for National Register based on development of new context and criteria

Base map 1985 by Western Air Photo  
Corrections for demolished buildings, 1993