

ST. JOSEPH, MISSOURI

SURVEY BLOCK #1

FALL, 1978

NWMSU Historical Survey
Thomas Carneal, Director

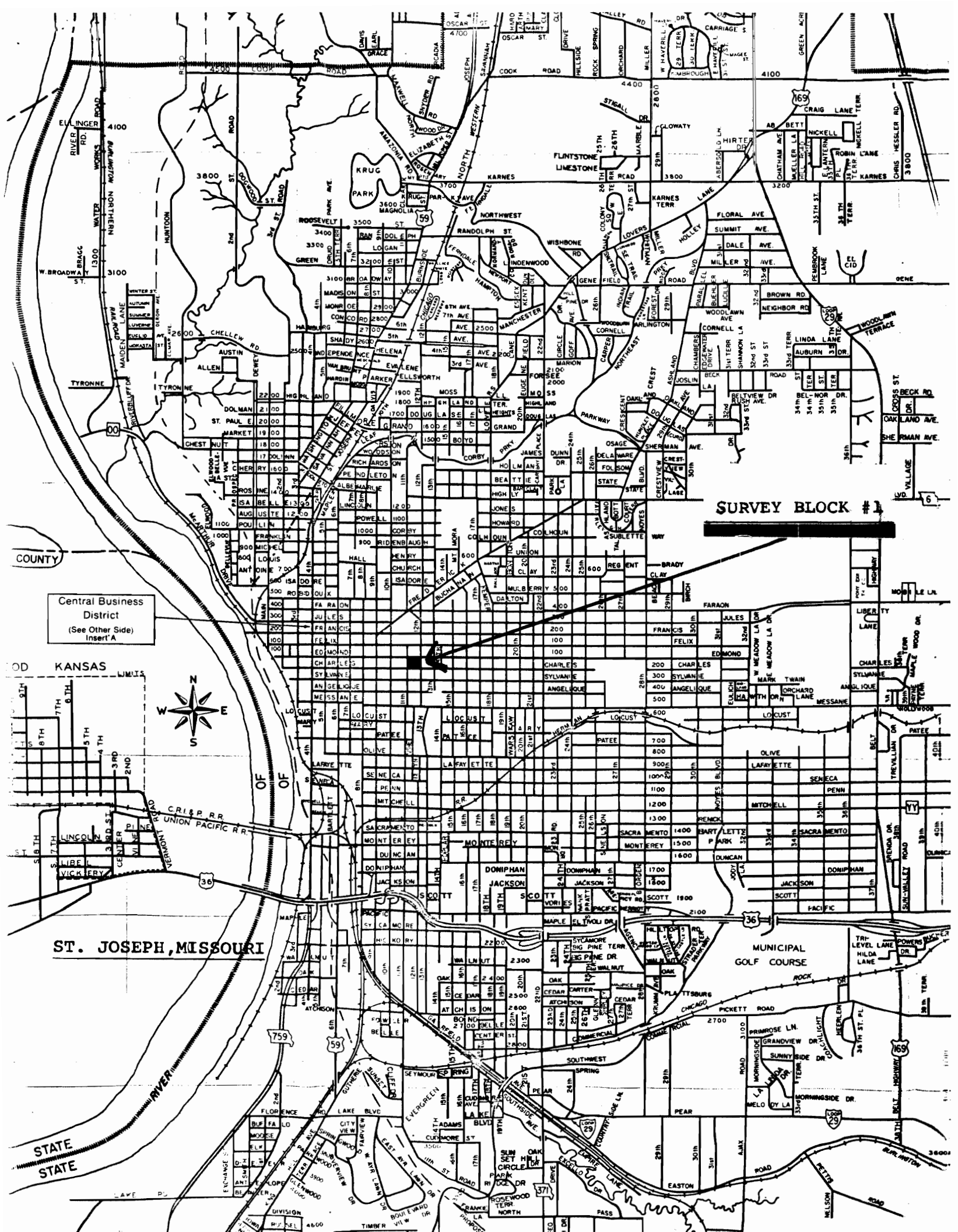

SURVEY BLOCK #1

Central Business District
(See Other Side)
Insert 'A'



ST. JOSEPH, MISSOURI

MUNICIPAL GOLF COURSE

STATE STATE

RECEIVED

Office of Historic
Preservation

ST. JOSEPH, MISSOURI

SURVEY BLOCK#2

FALL, 1978

NWMSU Historical Survey
Thomas Carneal, Director

SURVEY BLOCK #3

This area represents a series of homes constructed at different time periods over the past 130 years. A search of the County Histories and other material suggest that part of the homes could be grouped into a historic district. The homes for possible inclusion are located at: 105 N. 19th, and 119 N. 19th or Community Development numbers A-04-20 and A-04-36. These homes should be attached to the homes in the block immediately to the West as the William T. Harris Historic District. The home at 102 N. 20th has no relationship to the district and stands by itself as a ranch style in an older neighborhood.

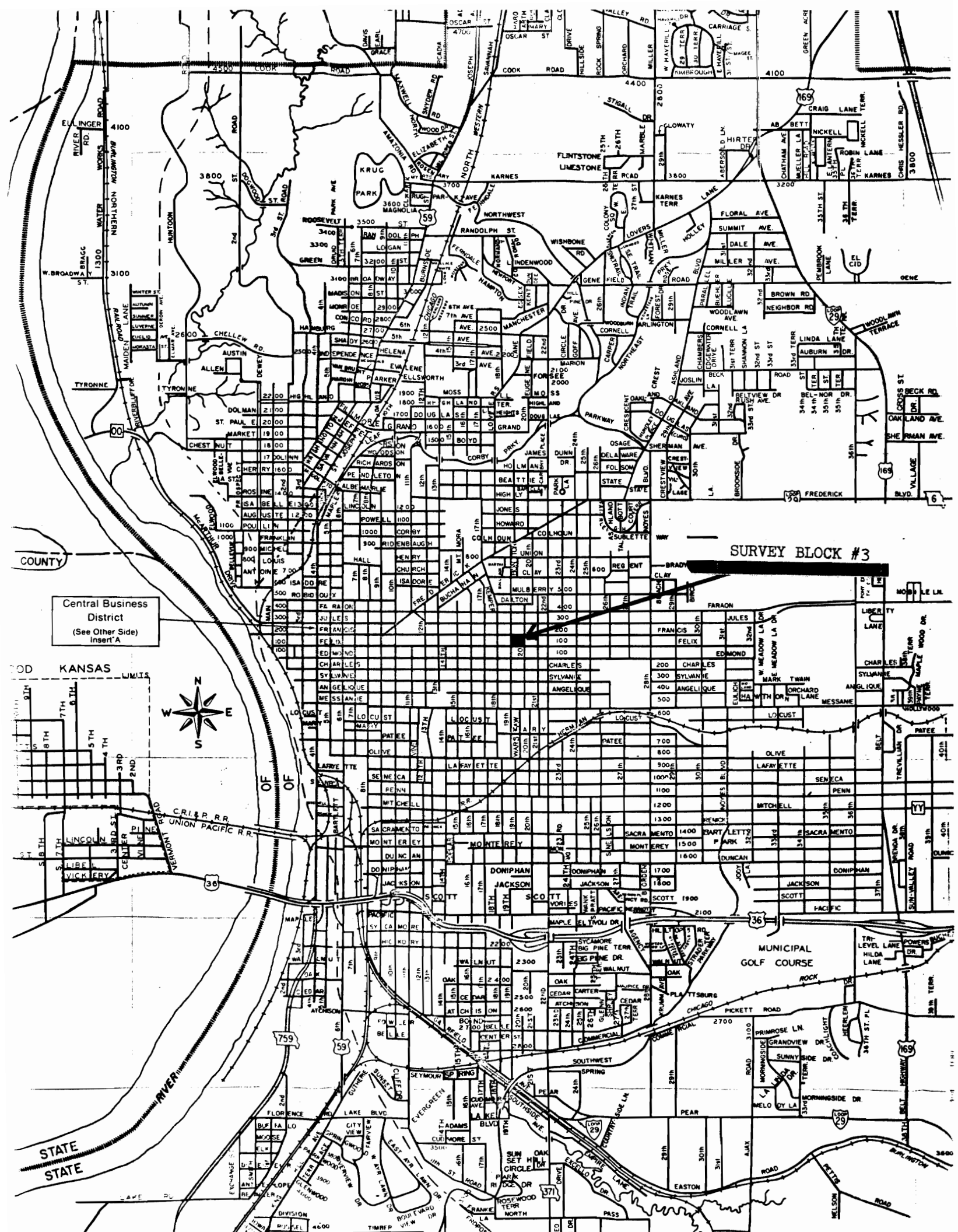

SURVEY BLOCK #3

Central Business District
(See Other Side)
Insert A



MUNICIPAL GOLF COURSE

STATE STATE

ST. JOSEPH, MISSOURI

SURVEY BLOCK #4

JANUARY, 1979

NWMSU Historical Survey

Thomas W. Carneal, Director

SURVEY BLOCK #4

This area represents a series of homes constructed at different time periods over the past 130 years. A search of the County Histories and other material suggest that entire block could be grouped into a historic district with only one intrusion being the fire station at 18th and Felix (A-01-19). These homes should be attached to the homes in the block immediately to the North as the William T. Harris Historic District.

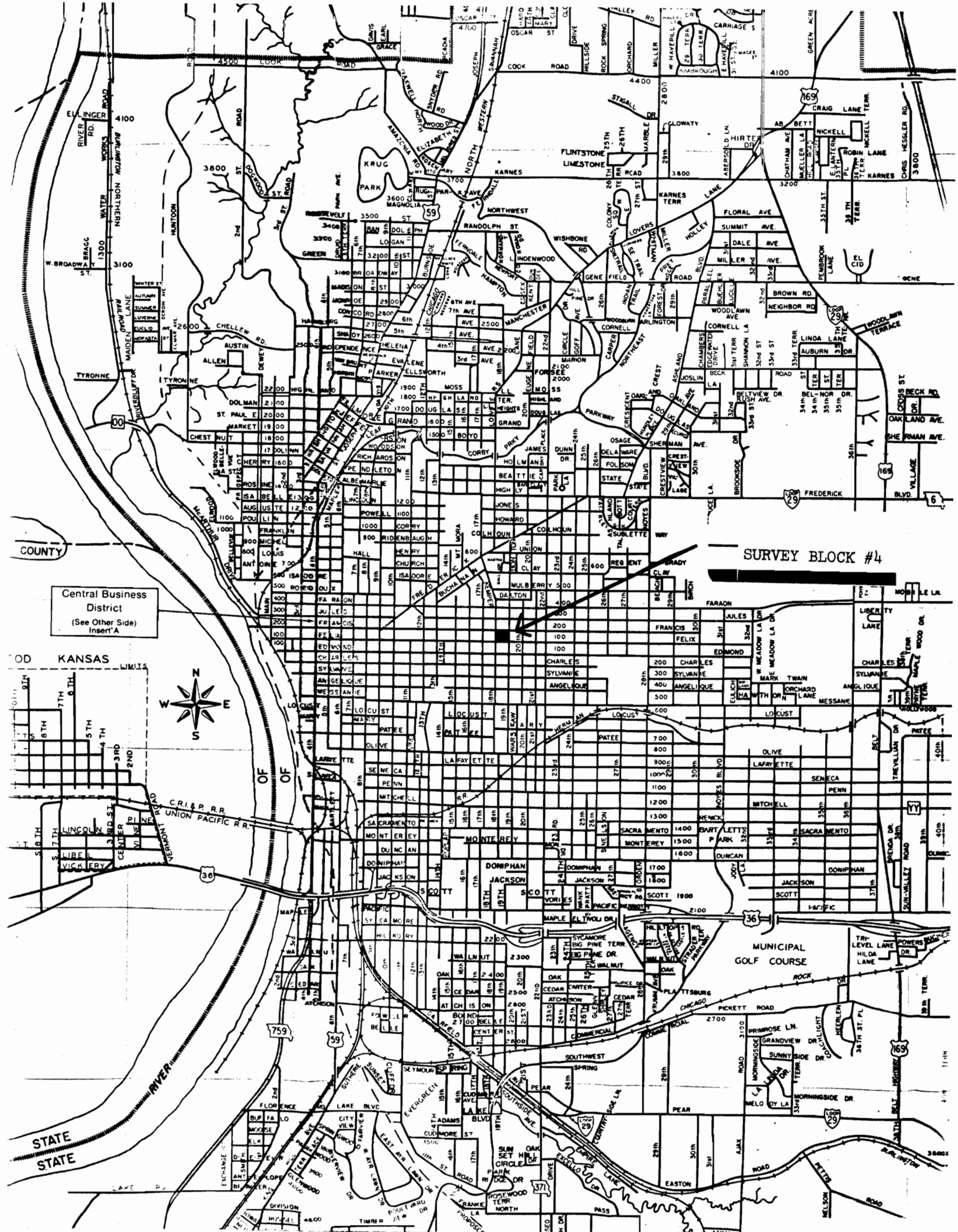

SURVEY BLOCK #4

Central Business District
(See Other Side)
Insert A



MUNICIPAL GOLF COURSE

STATE STATE

ST. JOSEPH, MISSOURI

SURVEY BLOCK #5

JANUARY, 1979

NWMSU Historical Survey

Thomas W. Carneal, Director.

Survey Block #5

This area represents a series of homes constructed at different time periods over the past 100 years. A search of the County Histories and other material indicates the homes at 209 N. 18th (B-01-04); 221 N. 18th (C-01-03); 206 N. 19th (B-01-01); 208 N. 19th (B-01-02); and 1815 Francis (B-01-03) have historic significance and should be connected with the William T. Harris Historic District which is located in the block directly south of both of these structures. The other homes in this block survey represent a variety of styles, but they can be duplicated in several other block surveys. There is not enough symmetry in this block to include it in the William T. Harris Historic District.

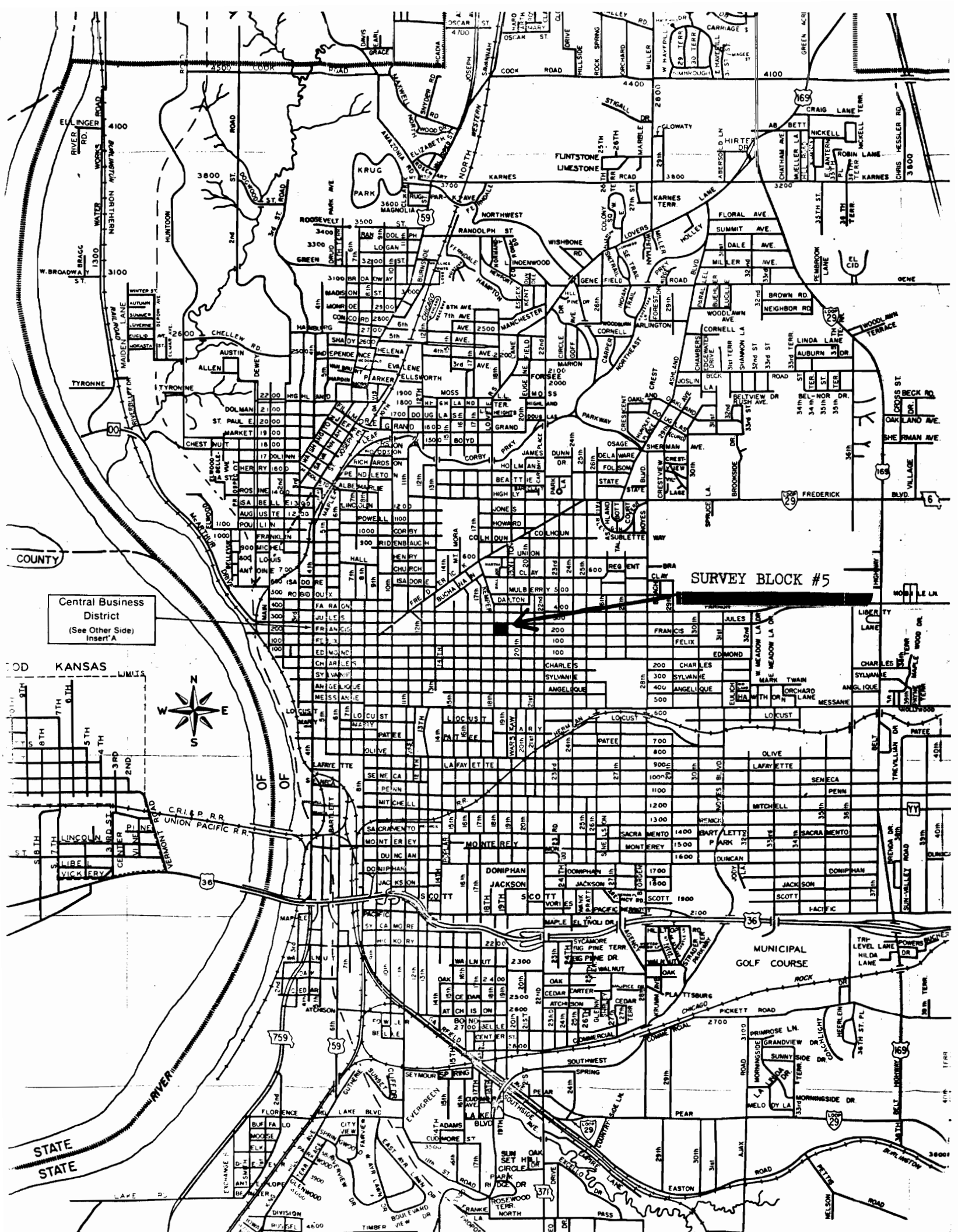

Central Business District
(See Other Side)
Insert A



SURVEY BLOCK #5

MUNICIPAL GOLF COURSE

COUNTY

KANSAS

STATE STATE

759

59

36

169

29

6

169

29

6

ST. JOSEPH, MISSOURI

SURVEY BLOCK #6

JANUARY, 1979

NWMSU Historical Survey

Thomas W. Carneal, Director

SURVEY BLOCK #6

This area represents a series of homes constructed at different time periods over the past 100 years. A search of the County Histories and other material indicates that only the homes at 1716 Francis (C-01-14 or C-47-27) and 1715 Felix (C-01-21) have any significance and should be connected with the William T. Harris Historic District which is located in the block directly East of both of these structures. The other homes in this block survey represent a variety of styles but they can be duplicated in several other block surveys. There is not enough symmetry in this block to include it in the William T. Harris Historic District.

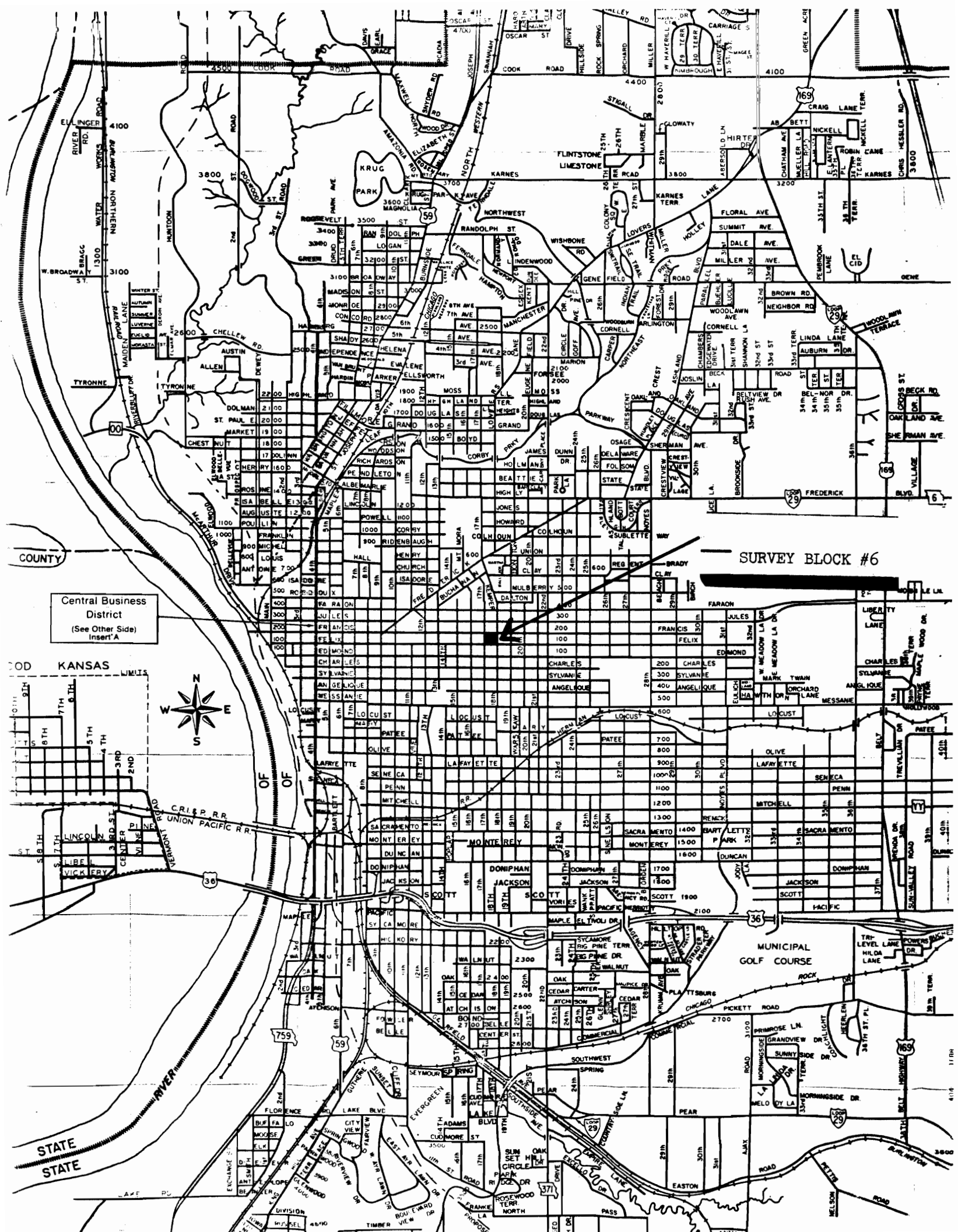

Central Business District
(See Other Side)
Insert A

SURVEY BLOCK #6



COUNTY

KANSAS

STATE STATE

9TH
8TH
7TH
6TH
5TH
4TH
3RD
2ND

LIBERTY
CENTER
VICK FRY
LINCOLN
PLINE
VILLS

STATE STATE
EXCHANGE ST
DIVISION
MUSEL
4670

10TH
9TH
8TH
7TH
6TH
5TH
4TH
3RD
2ND
1ST

EDMUND
FRANCIS
FELIX
JULES
W MEADOW LA DR
MEADOW LA DR

FLORENCE
MOOSE
CITY VIEW
SHAWWOOD
SUNSET
FAIRVIEW
EAST RIVER LAWN DR
BOULEVARD VIEW DR
FRANKE
NORTH
ROSEWOOD
TERRACE
PASS

11TH
10TH
9TH
8TH
7TH
6TH
5TH
4TH
3RD
2ND
1ST

CHARLES
SYLVANIE
ANGELIQUE
PATTEE
LA FAYETTE
SENECA
PENNY
MITCHELL
SACRAMENTO
MONTREALY
DUNN
JACKSON
SCOTT
JACKSON
SCOTT
PACIFIC

ADAMS
CATHMORE ST
LAKE BLVD
KEYMOORE
EVERGREEN
ADAMS
CATHMORE ST
LAKE BLVD
KEYMOORE
EVERGREEN

12TH
11TH
10TH
9TH
8TH
7TH
6TH
5TH
4TH
3RD
2ND
1ST

FRANCIS
FELIX
JULES
W MEADOW LA DR
MEADOW LA DR
MARK TWAIN
ORCHARD LAKE
ANGELIQUE
MESSANE

ADAMS
CATHMORE ST
LAKE BLVD
KEYMOORE
EVERGREEN
ADAMS
CATHMORE ST
LAKE BLVD
KEYMOORE
EVERGREEN

13TH
12TH
11TH
10TH
9TH
8TH
7TH
6TH
5TH
4TH
3RD
2ND
1ST

FRANCIS
FELIX
JULES
W MEADOW LA DR
MEADOW LA DR
MARK TWAIN
ORCHARD LAKE
ANGELIQUE
MESSANE

ADAMS
CATHMORE ST
LAKE BLVD
KEYMOORE
EVERGREEN
ADAMS
CATHMORE ST
LAKE BLVD
KEYMOORE
EVERGREEN

14TH
13TH
12TH
11TH
10TH
9TH
8TH
7TH
6TH
5TH
4TH
3RD
2ND
1ST

FRANCIS
FELIX
JULES
W MEADOW LA DR
MEADOW LA DR
MARK TWAIN
ORCHARD LAKE
ANGELIQUE
MESSANE

ADAMS
CATHMORE ST
LAKE BLVD
KEYMOORE
EVERGREEN
ADAMS
CATHMORE ST
LAKE BLVD
KEYMOORE
EVERGREEN

15TH
14TH
13TH
12TH
11TH
10TH
9TH
8TH
7TH
6TH
5TH
4TH
3RD
2ND
1ST

FRANCIS
FELIX
JULES
W MEADOW LA DR
MEADOW LA DR
MARK TWAIN
ORCHARD LAKE
ANGELIQUE
MESSANE

ADAMS
CATHMORE ST
LAKE BLVD
KEYMOORE
EVERGREEN
ADAMS
CATHMORE ST
LAKE BLVD
KEYMOORE
EVERGREEN

16TH
15TH
14TH
13TH
12TH
11TH
10TH
9TH
8TH
7TH
6TH
5TH
4TH
3RD
2ND
1ST

FRANCIS
FELIX
JULES
W MEADOW LA DR
MEADOW LA DR
MARK TWAIN
ORCHARD LAKE
ANGELIQUE
MESSANE

ADAMS
CATHMORE ST
LAKE BLVD
KEYMOORE
EVERGREEN
ADAMS
CATHMORE ST
LAKE BLVD
KEYMOORE
EVERGREEN

17TH
16TH
15TH
14TH
13TH
12TH
11TH
10TH
9TH
8TH
7TH
6TH
5TH
4TH
3RD
2ND
1ST

FRANCIS
FELIX
JULES
W MEADOW LA DR
MEADOW LA DR
MARK TWAIN
ORCHARD LAKE
ANGELIQUE
MESSANE

ADAMS
CATHMORE ST
LAKE BLVD
KEYMOORE
EVERGREEN
ADAMS
CATHMORE ST
LAKE BLVD
KEYMOORE
EVERGREEN

18TH
17TH
16TH
15TH
14TH
13TH
12TH
11TH
10TH
9TH
8TH
7TH
6TH
5TH
4TH
3RD
2ND
1ST

FRANCIS
FELIX
JULES
W MEADOW LA DR
MEADOW LA DR
MARK TWAIN
ORCHARD LAKE
ANGELIQUE
MESSANE

ADAMS
CATHMORE ST
LAKE BLVD
KEYMOORE
EVERGREEN
ADAMS
CATHMORE ST
LAKE BLVD
KEYMOORE
EVERGREEN

19TH
18TH
17TH
16TH
15TH
14TH
13TH
12TH
11TH
10TH
9TH
8TH
7TH
6TH
5TH
4TH
3RD
2ND
1ST

FRANCIS
FELIX
JULES
W MEADOW LA DR
MEADOW LA DR
MARK TWAIN
ORCHARD LAKE
ANGELIQUE
MESSANE

ADAMS
CATHMORE ST
LAKE BLVD
KEYMOORE
EVERGREEN
ADAMS
CATHMORE ST
LAKE BLVD
KEYMOORE
EVERGREEN

20TH
19TH
18TH
17TH
16TH
15TH
14TH
13TH
12TH
11TH
10TH
9TH
8TH
7TH
6TH
5TH
4TH
3RD
2ND
1ST

FRANCIS
FELIX
JULES
W MEADOW LA DR
MEADOW LA DR
MARK TWAIN
ORCHARD LAKE
ANGELIQUE
MESSANE

ADAMS
CATHMORE ST
LAKE BLVD
KEYMOORE
EVERGREEN
ADAMS
CATHMORE ST
LAKE BLVD
KEYMOORE
EVERGREEN