



Southmoreland Historic District

Designated December 16, 1982
Designation Ordinance #54574

40 0 40 Feet



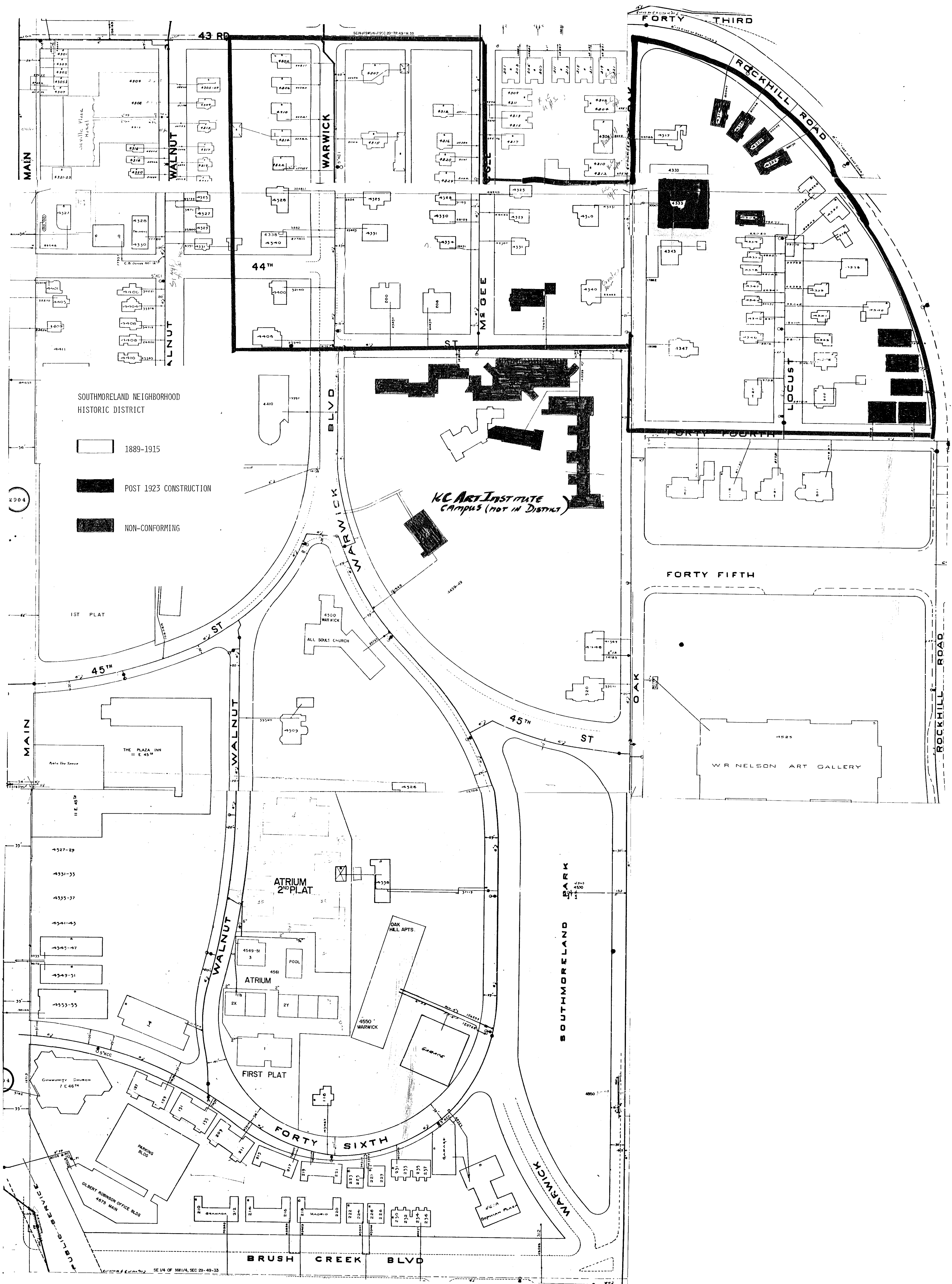

SOUTHMORELAND NEIGHBORHOOD
HISTORIC DISTRICT

- 1889-1915
- POST 1923 CONSTRUCTION
- NON-CONFORMING

*KC ART INSTITUTE
CAMPUS (NOT IN DISTRICT)*

WR NELSON ART GALLERY

ATRIUM
2ND PLAT

ATRIUM

FIRST PLAT

FORTY SIXTH

BRUSH CREEK BLVD

SOUTHMORELAND BARK

2004