

Map of Rocheport
Historic District
1976

Showing listed properties
O marks those properties
demolished since 1976

not all demolished buildings
were described in original
nomination and so are not
listed in the report

Rocheport Historic District

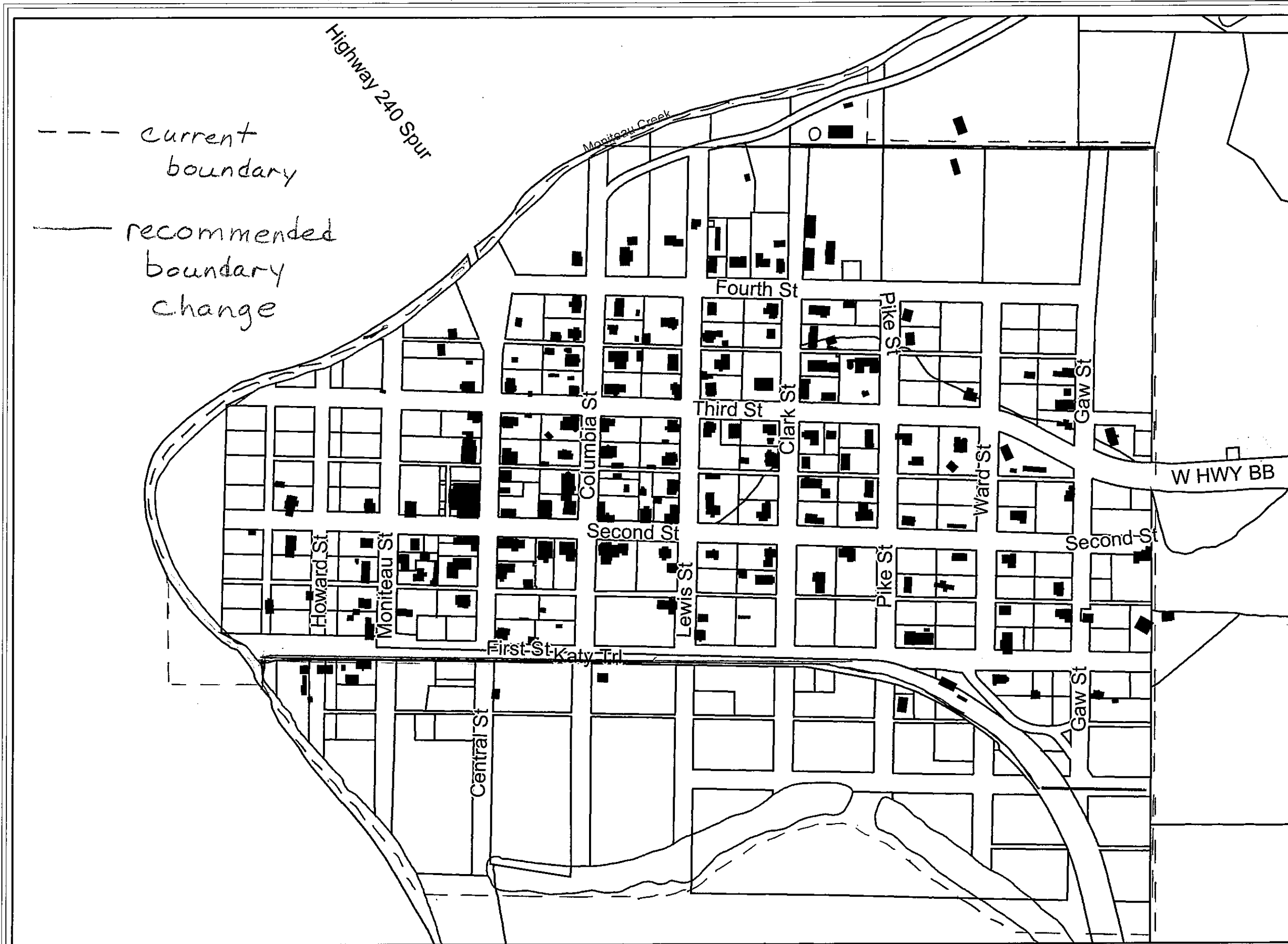

BOONE COUNTY



MISSOURI

THIS MAP IS PREPARED FOR THE INVENTORY OF REAL ESTATE PROPERTY BASE ON THE UTILIZATION OF DEEDS, PLANS AND/OR SUPPORTIVE DATA. THE COUNTY AND COMPANY ASSUME NO LEGAL RESPONSIBILITY FOR INFORMATION DELINEATED HEREON.

Rocheport



1 inch = 400 feet

Highway 240 Spur

Moniteau Creek

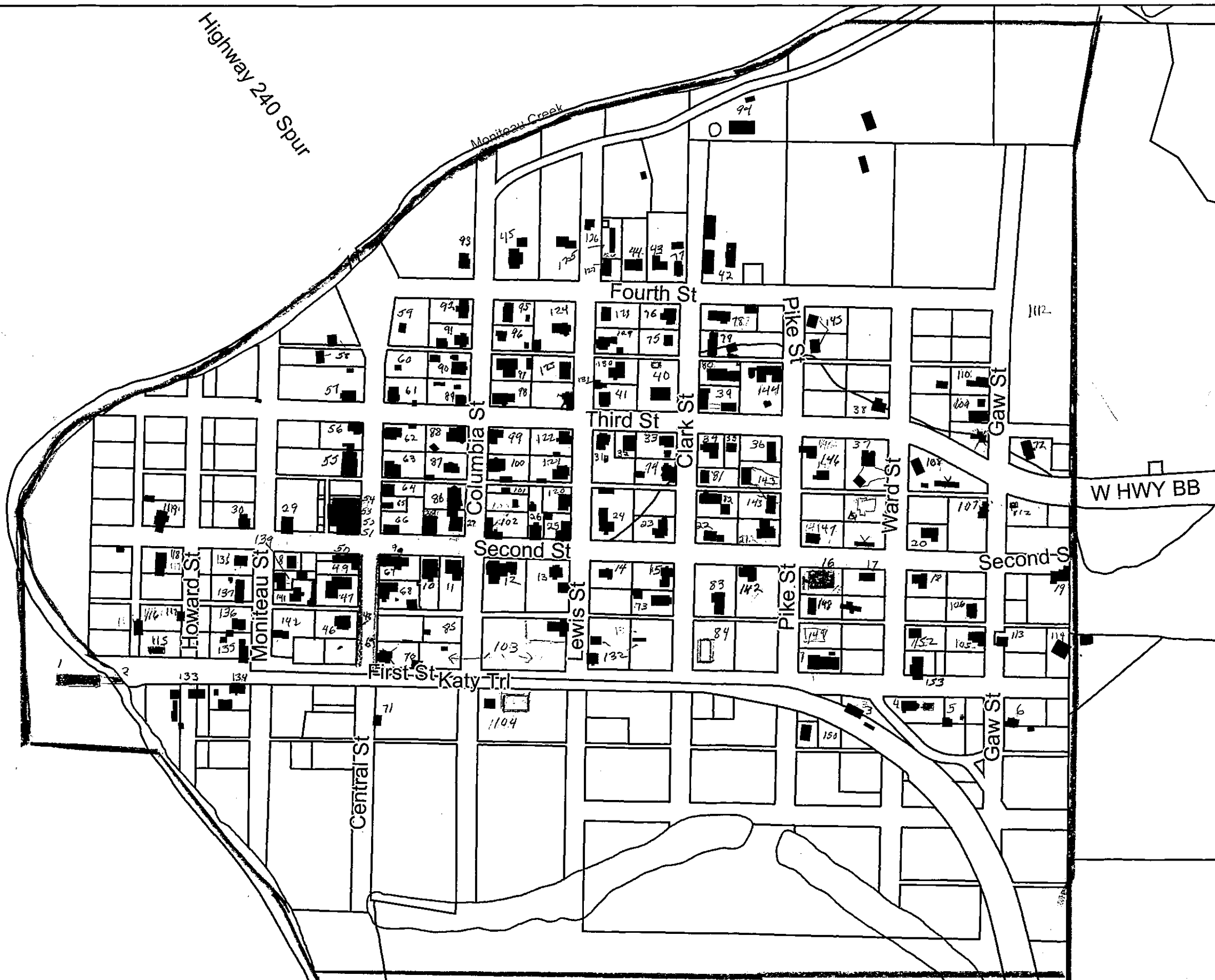

BOONE COUNTY

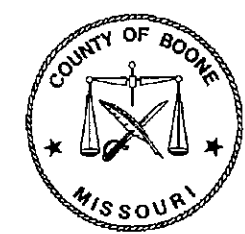

MISSOURI

Rocheport Historic District

X building demolished
 — district boundary

THIS MAP IS PREPARED FOR THE INVENTORY OF REAL ESTATE PROPERTY BASE ON THE UTILIZATION OF DEEDS, PLANS AND/OR SUPPORTIVE DATA. THE COUNTY AND COMPANY ASSUME NO LEGAL RESPONSIBILITY FOR INFORMATION DELINEATED HEREON.

Rocheport



1 inch = 400 feet

Rocheport, Mo. Historic District

- district boundary
- white dot - contributing resource
- black dot - noncontributing resources
- X properties now demolished

Highway 240 Spur

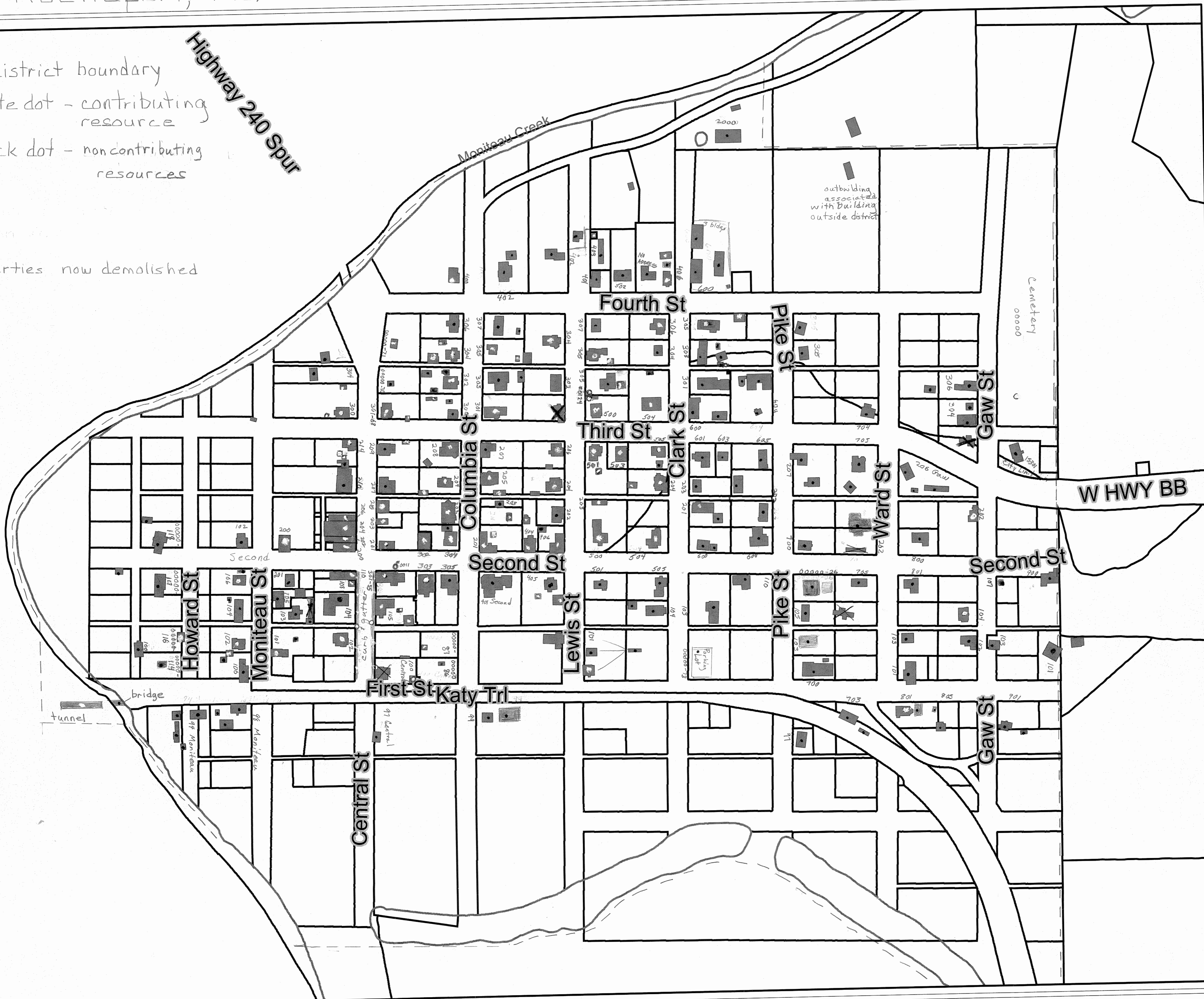

BOONE COUNTY



MISSOURI

THIS MAP IS PREPARED FOR THE INVENTORY OF REAL ESTATE PROPERTY BASE ON THE UTILIZATION OF DEEDS, PLANS AND/OR SUPPORTIVE DATA. THE COUNTY AND COMPANY ASSUME NO LEGAL RESPONSIBILITY FOR INFORMATION DELINEATED HEREON.

Rocheport



1 inch = 400 feet

Rocheport Historic District showing properties that contribute to the 1976 Rocheport Historic District

BOONE COUNTY

numbers correspond to inventory form numbers

Highway 240 Spur

X properties that have been demolished

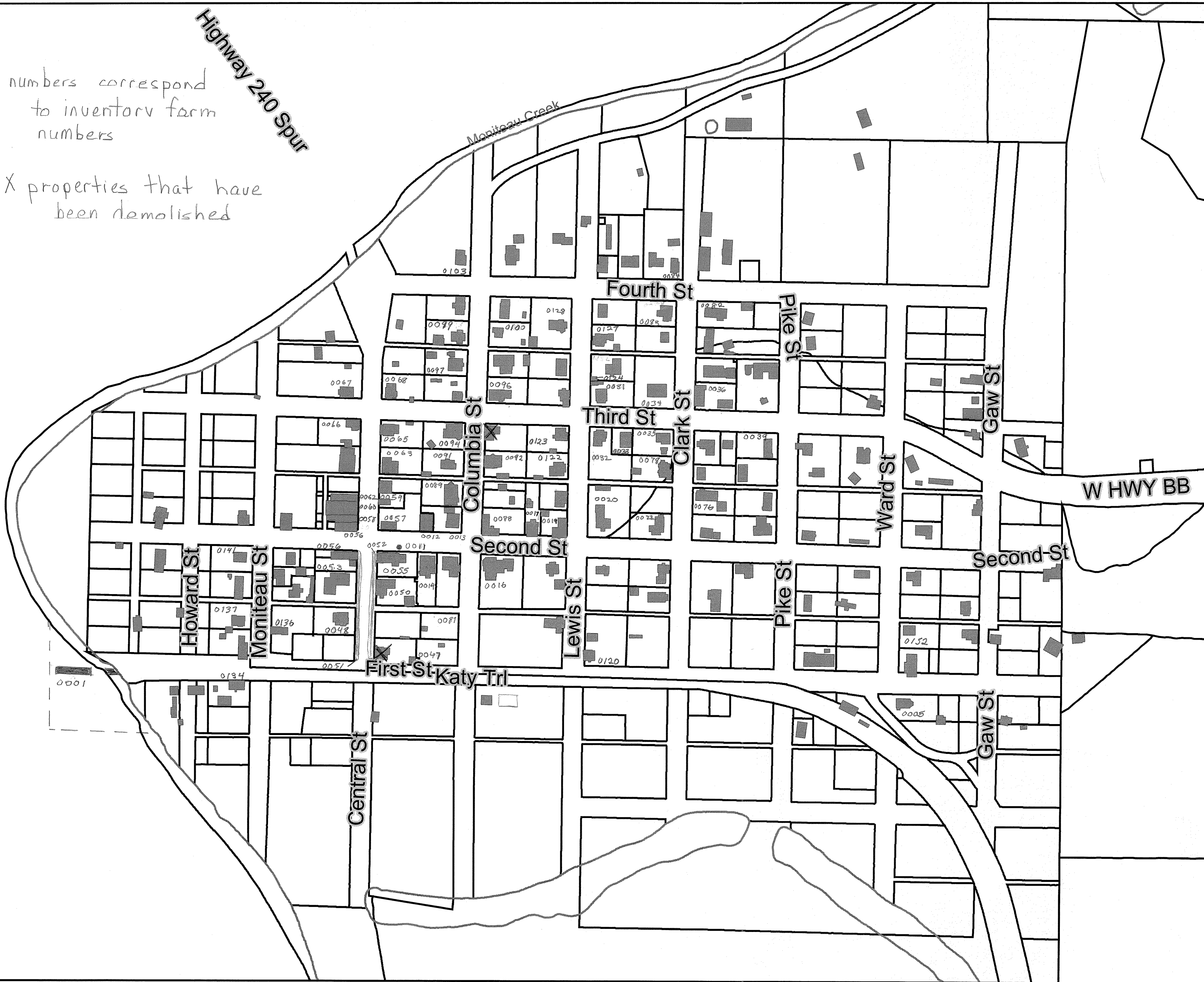

Properties Previously Listed

- 0001-Katy Trail Tunnel, Katy Trail
- 0005-Mt. Nebo Baptist Church, 801 First St.
- 0011-historic marker, Second Street between Central Street and Columbia Street
- 0012-Rocheport Christian Church, 302 Second Street
- 0013-Chinn/Gentry House, 305 Second Street
- 0014-Chambers House, 304 Second Street
- 0016-F. E. Bysfield House, 401 Second Street
- 0017-Williams/Peeler House, 404 Second Street
- 0019-Grossman/Barth House, 406 Second Street
- 0020-Bently/Campbell House, 500 Second Street
- 0022-TUmy House, 504 Second Street
- 0031-B. M. Campbell House, 500 Third Street
- 0032-Crump/Prince/Haines House, 503 Third Street
- 0033-Rocheport Baptist Church, 503 Third Street
- 0034-Rocheport Public School, 504 Third Street
- 0035-Waddell/Rucker/Burroughs House, 506 Third Street
- 0036-Norris/Norris/Sampson House, 600 Third Street
- 0039-Hill/Roby House, 605 Third Street
- 0047-John Burroughs Tin Shop, 101 Central Street
- 0048-Doody/Campbell/McKinsey House, 102 Central Street
- 0050-Knox/Gaw/Slade House, 105 (10500) Central Street
- 0051-curb and gutter, west side Central Street between First Street and Second Street
- 0052-curb and gutter, east side Central Street between First Street and Second Street
- 0053-Leslis Burroughs Barber Shop, 108 Central Street
- 0054-Schell-Wellburn Store, 110 Central Street
- 0055-Topleff/Kaiser/Dimmit House, 301 Central Street
- 0056-Rocheport Bank, 200 Central Street
- 0057-People's Bank of Rocheport, 201 Central Street
- 0058-B. F. Dimmitt Drugstore, 202 Central Street
- 0059-Albert Ward Store, 203 Central Street
- 0060-B. F. Bysfield Memorial Building, 204 Central Street
- 0062-Bysfield Building, 206 Central Street
- 0063-Thomas Pipes House, 207 Central Street
- 0065-Haller/Grossman House, 209 Central Street
- 0066-Grossman/Pipes House, 214 Central Street
- 0067-Sep Sexton House, 300 Central Street
- 0068-Canole/Harper House, 301 Central Street
- 0076-Sep Sexton/Everett Pipes House, 201 Clark Street
- 0078-White/Harris House, 204 Clark Street
- 0082-Sadie Smith House, 305 Clark Street
- 0083-Dodson/Jones House, 306 Clark Street
- 0084-Potts House, 403 Clark Street
- 0087-Swanstone House cellar, 00000 Columbia Street (west side Columbia Street between First and Second)
- 0088-Wilcox/Barth House, 201 Columbia Street
- 0089-Methodist Episcopal Church, South, 202 Columbia Street
- 0091-Methodist Episcopal Church, South, parsonage, 204 Columbia Street
- 0093-Challis/Champion/Chinn House, 205 Columbia Street
- 0094-Slade House, 208 Columbia Street
- 0096-Ed Harrington House, 301 Columbia Street
- 0097-Inman House, 302 Columbia Street
- 0099-Byers House, 304 Columbia Street
- 0100-Rapp House, 305 Columbia Street
- 0103-Payton/DeHaven/Turner House, 400 Columbia Street
- 0120-Boone House, 101 Lewis Street
- 0122-McAllister/Murray House, 204 Lewis Street
- 0123-Matheny House, 206 Lewis Street
- 0124-Ridgeway Icehouse, Lewis Street (east side near Third)
- 0127-Ridgeway House, 305 Lewis Street
- 0128-Scobee House, 304 Lewis Street
- 0136-George Gregory House, 101 Moniteau Street
- 0137-Cox House, 102 Moniteau Street
- 0141-Mullens House, 106 Moniteau Street
- 0152-Wilhite House, 103 Ward Street