

NATIONAL REGISTER OF HISTORIC PLACES
INVENTORY - NOMINATION FORM

(Type all entries - complete applicable sections)

STATE: Missouri	
COUNTY: Linn	
FOR NPS USE ONLY	
ENTRY NUMBER	DATE

1. NAME

COMMON:
General John J. Pershing Boyhood Home

AND/OR HISTORIC:

2. LOCATION

STREET AND NUMBER:
Corner, State and Worlow streets

CITY OR TOWN:
Laclede

STATE Missouri 64651	CODE 24	COUNTY: Linn	CODE 115
-------------------------	------------	-----------------	-------------

3. CLASSIFICATION

CATEGORY (Check One)	OWNERSHIP	STATUS	ACCESSIBLE TO THE PUBLIC
District <input type="checkbox"/> Building <input checked="" type="checkbox"/>	Public <input checked="" type="checkbox"/>	Occupied <input type="checkbox"/>	Yes: Restricted <input checked="" type="checkbox"/>
Site <input type="checkbox"/> Structure <input type="checkbox"/>	Private <input type="checkbox"/>	Unoccupied <input checked="" type="checkbox"/>	Unrestricted <input type="checkbox"/>
Object <input type="checkbox"/>	Both <input type="checkbox"/>	Preservation work In progress <input type="checkbox"/>	No: <input type="checkbox"/>
PRESENT USE (Check One or More as Appropriate)			
Agricultural <input type="checkbox"/>	Government <input type="checkbox"/>	Park <input checked="" type="checkbox"/>	Transportation <input type="checkbox"/> Comments <input type="checkbox"/>
Commercial <input type="checkbox"/>	Industrial <input type="checkbox"/>	Private Residence <input type="checkbox"/>	Other (Specify) <input type="checkbox"/>
Educational <input type="checkbox"/>	Military <input type="checkbox"/>	Religious <input type="checkbox"/>	_____
Entertainment <input type="checkbox"/>	Museum <input checked="" type="checkbox"/>	Scientific <input type="checkbox"/>	_____

4. OWNER OF PROPERTY

OWNERS NAME:
State of Missouri

STREET AND NUMBER:
Missouri State Park Board
P.O. Box 176, 1201 Jefferson Building

CITY OR TOWN:
Jefferson City

STATE: Missouri 65101	CODE 24
--------------------------	------------

5. LOCATION OF LEGAL DESCRIPTION

COURTHOUSE, REGISTRY OF DEEDS, ETC:
County Recorder's Office

STREET AND NUMBER:

CITY OR TOWN:
Linneus

STATE: Missouri 64653	CODE 24
--------------------------	------------

APPROXIMATE ACREAGE OF NOMINATED PROPERTY: .25

6. REPRESENTATION IN EXISTING SURVEYS

TITLE OF SURVEY:
Missouri Historic Sites Catalogue

DATE OF SURVEY: 1963 Federal State County Local

DEPOSITORY FOR SURVEY RECORDS:
State Historical Society of Missouri

STREET AND NUMBER:
Corner, Hitt and Lowry streets

CITY OR TOWN:
Columbia

STATE: Missouri 65201	CODE 24
--------------------------	------------

SEE INSTRUCTIONS

STATE: Missouri
COUNTY: Linn
ENTRY NUMBER
DATE

NATIONAL REGISTER OF HISTORIC PLACES
INVENTORY - NOMINATION FORM

(Continuation Sheet)

STATE	
Missouri	
COUNTY	
Linn	
FOR NPS USE ONLY	
ENTRY NUMBER	DATE

(Number all entries)

GENERAL JOHN J. PERSHING BOYHOOD HOME

6. Missouri State Historical Survey (state)

1968

Missouri State Park Board

P.O. Box 176

1204 Jefferson Building

Jefferson City, Missouri 65101

Code: 24

7. DESCRIPTION

CONDITION	(Check One)					
	Excellent <input type="checkbox"/>	Good <input checked="" type="checkbox"/>	Fair <input type="checkbox"/>	Deteriorated <input type="checkbox"/>	Ruins <input type="checkbox"/>	Unexposed <input type="checkbox"/>
INTEGRITY	(Check One)			(Check One)		
	Altered <input checked="" type="checkbox"/>	Unaltered <input type="checkbox"/>		Moved <input type="checkbox"/>	Original Site <input checked="" type="checkbox"/>	

DESCRIBE THE PRESENT AND ORIGINAL (if known) PHYSICAL APPEARANCE

Modified Gothic Revival style house, facing east, built ca. 1857. Two and one-half story clapboarded frame house painted grey. One-story front porch on facade terminates at "L" block projection from facade (east) which forms gable wall on house front.

Bay window at first floor level of facade "L" projection (east). All window sash are double hung. Eave lines on gable end walls are accentuated by perforated wooden ornament. Wooden pinnacles at the ridge of gable ends. House has nine rooms. Three, one-story rooms, on rear of building, appear to be additions. Stone foundation, with partial basement added later.

Building is constructed primarily of sawn pine. Studs are of native oak. Brick interfill extends only to the second floor. Flooring on ground floor is of 1" wide pine boards, not original. Flooring on second floor is of 5" wide pine boards, original. Interior woodwork is primarily of pine and fir. Walnut stair railing is original.

House is furnished in 1860-1880's furniture, has interpretive museum room on the second floor.

Behind the house are located smoke house, well, fruit cellar, and outside privy. A bronze statue of General Pershing stands to the north of the building and was dedicated on October 20, 1968.

House was acquired by the State of Missouri in 1952 from a private owner who had planned to raze the building.

SEE INSTRUCTIONS

8. SIGNIFICANCE

PERIOD (Check One or More as Appropriate)

- Pre-Columbian 16th Century 18th Century 20th Century
 15th Century 17th Century 19th Century

SPECIFIC DATE(S) (If Applicable and Known) 1866-ca. 1882

AREAS OF SIGNIFICANCE (Check One or More as Appropriate)

- | | | | |
|---|--|--|--|
| Aboriginal <input type="checkbox"/> | Education <input type="checkbox"/> | Political <input type="checkbox"/> | Urban Planning <input type="checkbox"/> |
| Prehistoric <input type="checkbox"/> | Engineering <input type="checkbox"/> | Religion/Philosophy <input type="checkbox"/> | Other (Specify) <input type="checkbox"/> |
| Historic <input type="checkbox"/> | Industry <input type="checkbox"/> | Science <input type="checkbox"/> | _____ |
| Agriculture <input type="checkbox"/> | Invention <input type="checkbox"/> | Sculpture <input type="checkbox"/> | _____ |
| Art <input type="checkbox"/> | Landscape <input type="checkbox"/> | Social/Humanitarian <input type="checkbox"/> | _____ |
| Commerce <input type="checkbox"/> | Architecture <input type="checkbox"/> | Theater <input type="checkbox"/> | _____ |
| Communications <input type="checkbox"/> | Literature <input type="checkbox"/> | Transportation <input type="checkbox"/> | _____ |
| Conservation <input type="checkbox"/> | Military <input checked="" type="checkbox"/> | | _____ |
| | Music <input type="checkbox"/> | | _____ |

STATEMENT OF SIGNIFICANCE (Include Personages, Dates, Events, Etc.)

House was the boyhood home of General John J. Pershing, the Commander in Chief of the American Expeditionary Forces in Europe during World War I. John J. Pershing's father purchased the property in 1866 when the future General was a boy of six.

The Pershing family lived in the house until after 1882.

Pershing graduated from West Point and distinguished himself in the Spanish American War and in the Mexican campaigns against Pancho Villa.

As an outstanding honor, General Pershing was named General of the Armies of the United States by a Special Act of Congress in 1919.

On September 13, 1960, as a part of the nationwide celebration to honor General Pershing and the men who fought under him, the house was dedicated as an Historic Shrine.

SEE INSTRUCTIONS

9. MAJOR BIBLIOGRAPHICAL REFERENCES

1. State Historical Society of Missouri's Historic Sites File, ref. Linn County.
2. Meyer, Duane, The Heritage of Missouri: A History, (St. Louis: State Publishing Co., Inc., 1935) pp. 575, 577.
3. Missouri State Park Board Publication, "General John J. Pershing Boyhood Home", Laclede, Missouri. October 1968.

10. GEOGRAPHICAL DATA

LATITUDE AND LONGITUDE COORDINATES DEFINING A RECTANGLE LOCATING THE PROPERTY			O R	LATITUDE AND LONGITUDE COORDINATES DEFINING THE CENTER POINT OF A PROPERTY OF LESS THAN ONE ACRE		
CORNER	LATITUDE	LONGITUDE		LATITUDE	LONGITUDE	
	Degrees Minutes Seconds	Degrees Minutes Seconds		Degrees Minutes Seconds	Degrees Minutes Seconds	
NW	° ' "	° ' "		39° 47' 17"	93° 10' 08"	
NE	° ' "	° ' "				
SE	° ' "	° ' "				
SW	° ' "	° ' "				

LIST ALL STATES AND COUNTIES FOR PROPERTIES OVERLAPPING STATE OR COUNTY BOUNDARIES

STATE:	CODE	COUNTY	CODE
STATE:	CODE	COUNTY:	CODE
STATE:	CODE	COUNTY:	CODE
STATE:	CODE	COUNTY:	CODE

11. FORM PREPARED BY

NAME AND TITLE:
Martha L. Kusiak, Research Historian

ORGANIZATION State Historical Survey and Planning Office DATE April 10, 1969
Missouri State Park Board

STREET AND NUMBER:
P.O. Box 176, 1201 Jefferson Building

CITY OR TOWN: Jefferson City STATE Missouri 65101 CODE 24

12. STATE LIAISON OFFICER CERTIFICATION

As the designated State Liaison Officer for the National Historic Preservation Act of 1966 (Public Law 89-665), I hereby nominate this property for inclusion in the National Register and certify that it has been evaluated according to the criteria and procedures set forth by the National Park Service. The recommended level of significance of this nomination is:

National State Local

Name Joseph Jaeger, Jr.

Title Director, Missouri State Park Board, and Missouri State Liaison Officer

Date _____

NATIONAL REGISTER VERIFICATION

I hereby certify that this property is included in the National Register.

Chief, Office of Archeology and Historic Preservation

Date _____

ATTEST:

Keeper of The National Register

Date _____

SEE INSTRUCTIONS

Form 10-301
(Dec. 1968)

UNITED STATES DEPARTMENT OF THE INTERIOR
NATIONAL PARK SERVICE

NATIONAL REGISTER OF HISTORIC PLACES

PROPERTY MAP FORM

(Type all entries - attach to or enclose with map)

STATE	Missouri
COUNTY	Linn
FOR NPS USE ONLY	
ENTRY NUMBER	
DATE	

1. NAME			
COMMON: AND/OR HISTORIC:	General John J. Pershing Boyhood Home		
2. LOCATION			
STREET AND NUMBER:			
CITY OR TOWN:	Corner, State and Worlow streets		
STATE:	Jacleda	CODE	COUNTY:
	Missouri 61657	24	Linn
3. MAP REFERENCE			
SOURCE:	Missouri State Park Board Property Map		
SCALE:	not to scale		
DATE:	1961		
4. REQUIREMENTS			
TO BE INCLUDED ON ALL MAPS			
1. Property boundaries where required.			
2. North arrow.			
3. Latitude and longitude reference.			

SEE INSTRUCTIONS

NATIONAL REGISTER OF HISTORIC PLACES
INVENTORY - NOMINATION FORM

(Continuation Sheet)

STATE	
Missouri	
COUNTY	
Linn	
FOR NPS USE ONLY	
ENTRY NUMBER	DATE

(Number all entries)

JOHN J. PERSHING BOYHOOD HOME
LACLEDE, MO.

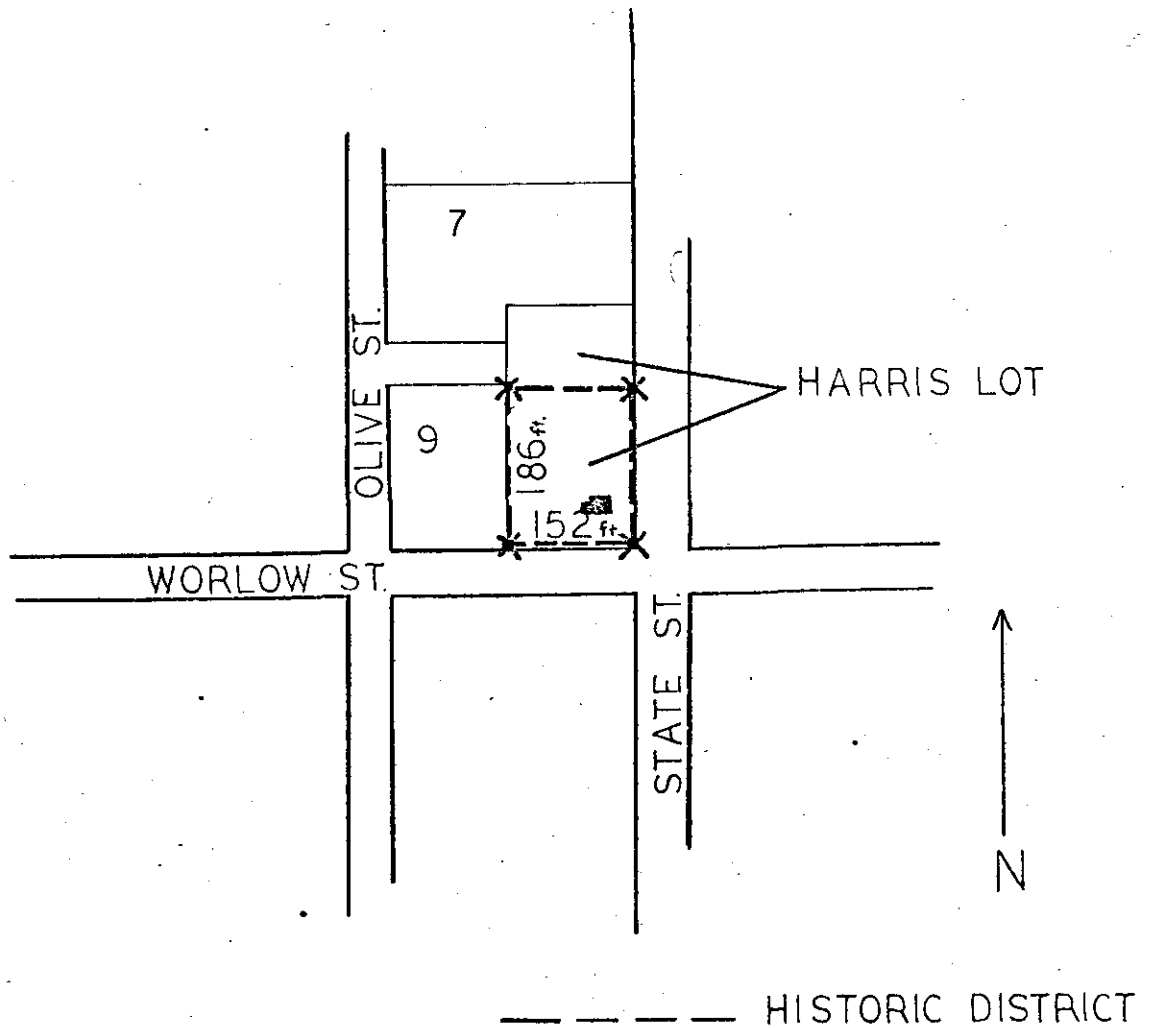

MSPB PROPERTY MAP
F. PHELPS, 9-14-64

MSHS, 4-7-69
Steven Teczar

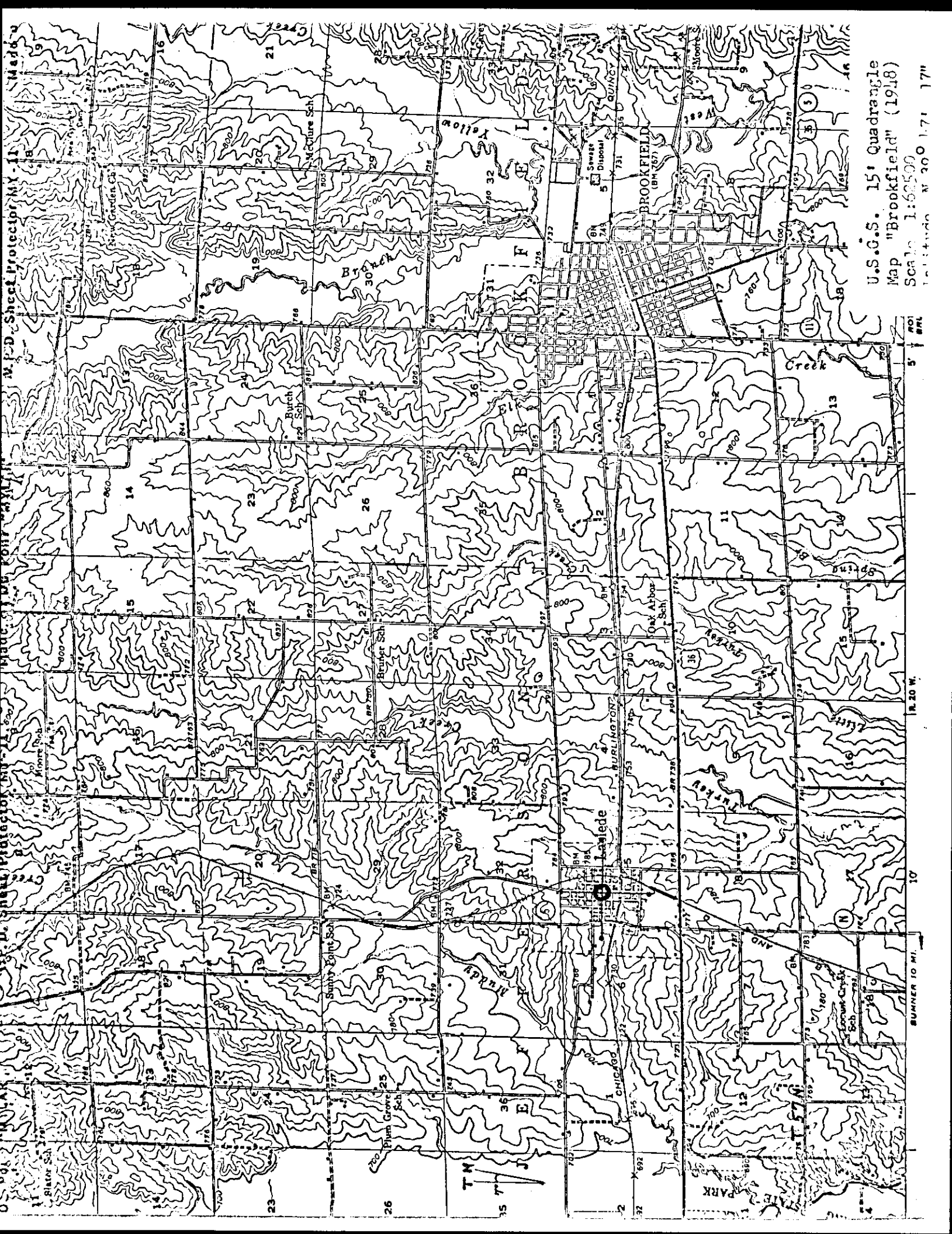

U.S.G.S. 15' Quadrangle
Map "Brookfield" (1948)
Scale 1:62500

U.S.G.S. 15' Quadrangle
Map "Brookfield" (1948)
Scale 1:62500

U.S.G.S. 15' Quadrangle
Map "Brookfield" (1948)
Scale 1:62500

U.S.G.S. 15' Quadrangle
Map "Brookfield" (1948)
Scale 1:62500

U.S.G.S. 15' Quadrangle
Map "Brookfield" (1948)
Scale 1:62500

U.S.G.S. 15' Quadrangle
Map "Brookfield" (1948)
Scale 1:62500

UNITED STATES DEPARTMENT OF THE INTERIOR
NATIONAL PARK SERVICE

NATIONAL REGISTER OF HISTORIC PLACES PROPERTY PHOTOGRAPH FORM

FOR NPS USE ONLY

RECEIVED

DATE ENTERED

SEE INSTRUCTIONS IN HOW TO COMPLETE NATIONAL REGISTER FORMS
TYPE ALL ENTRIES --ENCLOSE WITH PHOTOGRAPH

1 NAME

HISTORIC

General John J. Pershing Boyhood Home

AND/OR COMMON

General John J. Pershing Boyhood Home

2 LOCATION

CITY, TOWN

Laclede

— VICINITY OF

COUNTY

Linn

STATE

Missouri

3 PHOTO REFERENCE

PHOTO CREDIT

Cathy A. Alexander, Assistant
Editor, AASLH

DATE OF PHOTO

September 1975

NEGATIVE FILED AT

Historic Sites Survey, NPS, Washington, D.C.

4 IDENTIFICATION

DESCRIBE VIEW, DIRECTION, ETC. IF DISTRICT. GIVE BUILDING NAME & STREET

East (front) facade

PHOTO NO.

1

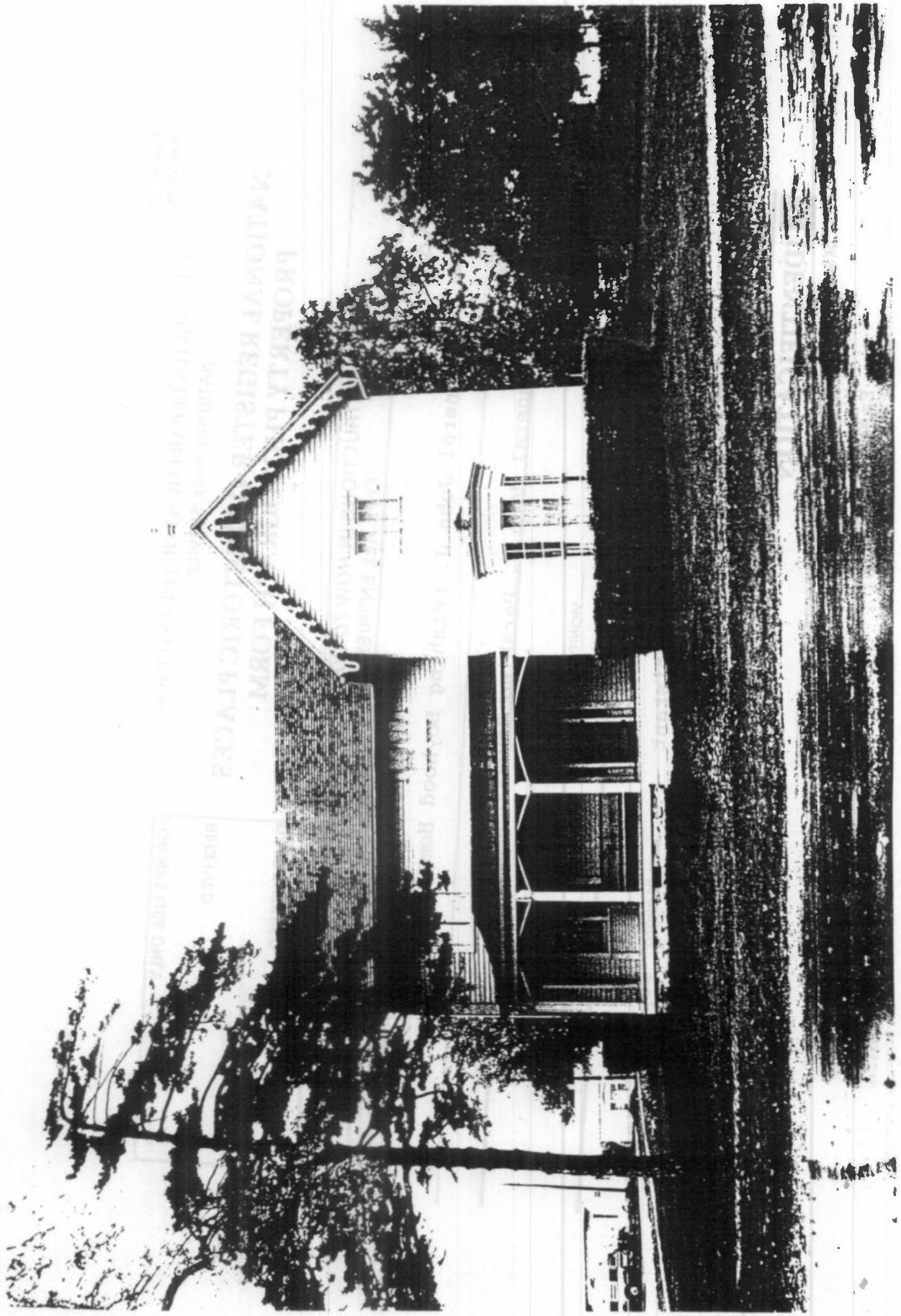

General John J. Pershing Boyhood Home

Laclede, Missouri

Photo: AASLH, 1975

UNITED STATES DEPARTMENT OF THE INTERIOR
NATIONAL PARK SERVICE

NATIONAL REGISTER OF HISTORIC PLACES PROPERTY PHOTOGRAPH FORM

FOR NPS USE ONLY

RECEIVED

DATE ENTERED

SEE INSTRUCTIONS IN HOW TO COMPLETE NATIONAL REGISTER FORMS
TYPE ALL ENTRIES -- ENCLOSE WITH PHOTOGRAPH

1 NAME

HISTORIC General John J. Pershing Boyhood Home

AND/OR COMMON

General John J. Pershing Boyhood Home

2 LOCATION

CITY, TOWN
Laclede

— VICINITY OF

COUNTY
Linn

STATE
Missouri

3 PHOTO REFERENCE

PHOTO CREDIT Cathy A. Alexander, Assistant
Editor, AASLH

DATE OF PHOTO September 1975

NEGATIVE FILED AT Historic Sites Survey, NPS, Washington, D.C.

4 IDENTIFICATION

DESCRIBE VIEW, DIRECTION, ETC. IF DISTRICT. GIVE BUILDING NAME & STREET

South side

PHOTO NO.

2

