

OZARK HISTORIC RESOURCES SURVEY

**An Inventory of Historic Buildings within
Historic City Center of Ozark, Christian County, Missouri
1998-1999**

**Prepared by
Katherine Dowdy
Heritage Research Company
115 East Church Street
Ozark, Missouri 65721**

**Joint funding provided by Historic Preservation Fund Grant Project No. 29-98-13128-477
and by the City of Ozark Historic Preservation Commission**

CONTENTS

Figure 1. Christian County, Missouri. Ozark, Christian County Seat

Figure 2. Ozark USGS Quad, 7.5 min, T27N, R21W, Sections 22, 223, 24, 25, 26, 27. Survey Area Indicated.

Figure 3. 1912 Plat Map of Ozark, Missouri. Survey Area indicated.

Enclosed: Map Showing Buildings Inventoried, by Field Number.

Building Inventories



Figure 1. Christian County, Missouri. Ozark, Christian County seat.

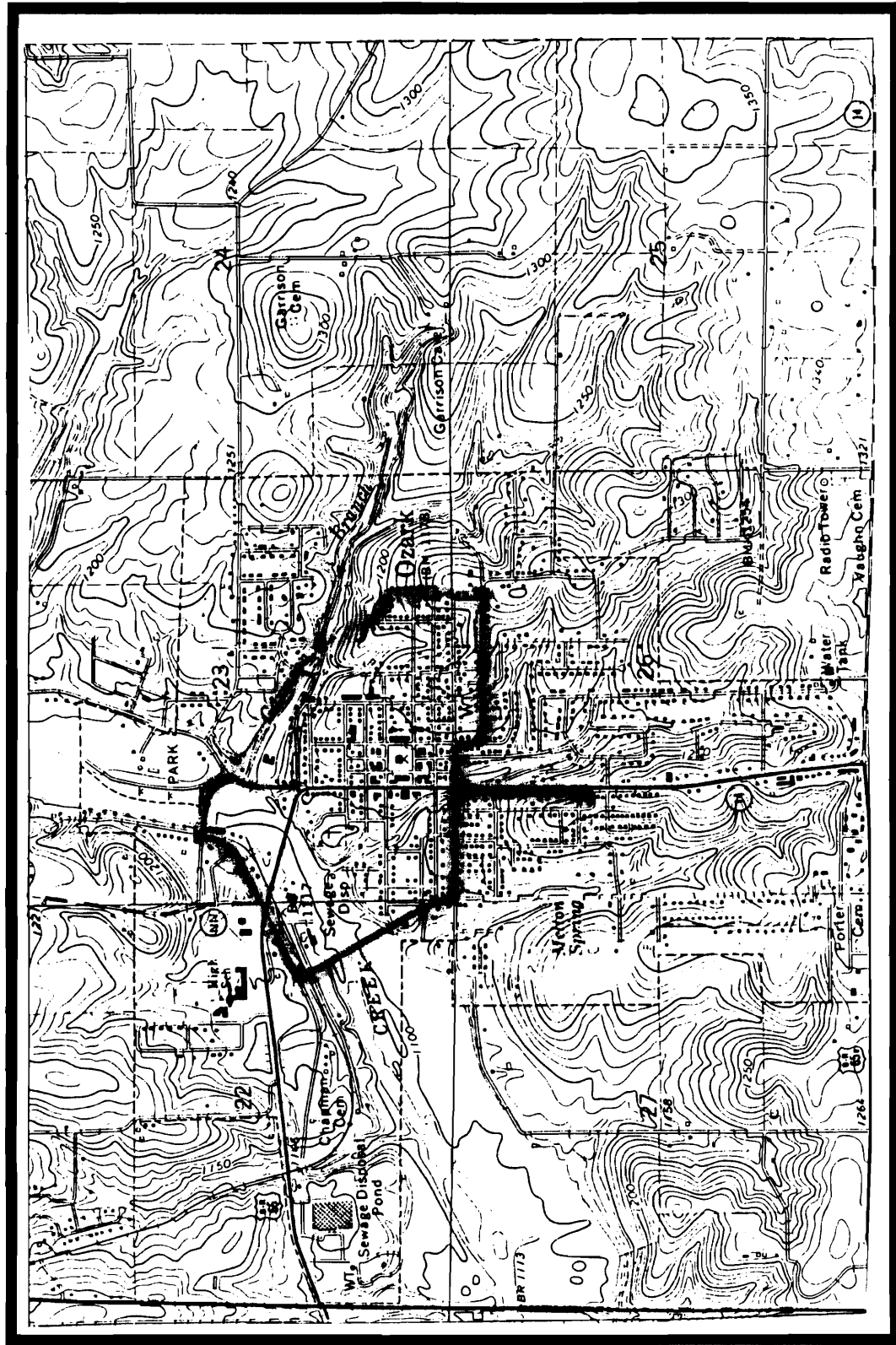

Figure 2. Ozark USGS Quad, 7.5 min, T27N, R21W, Sections 22, 23, 24, 25, 26, 27. Survey Area highlighted.

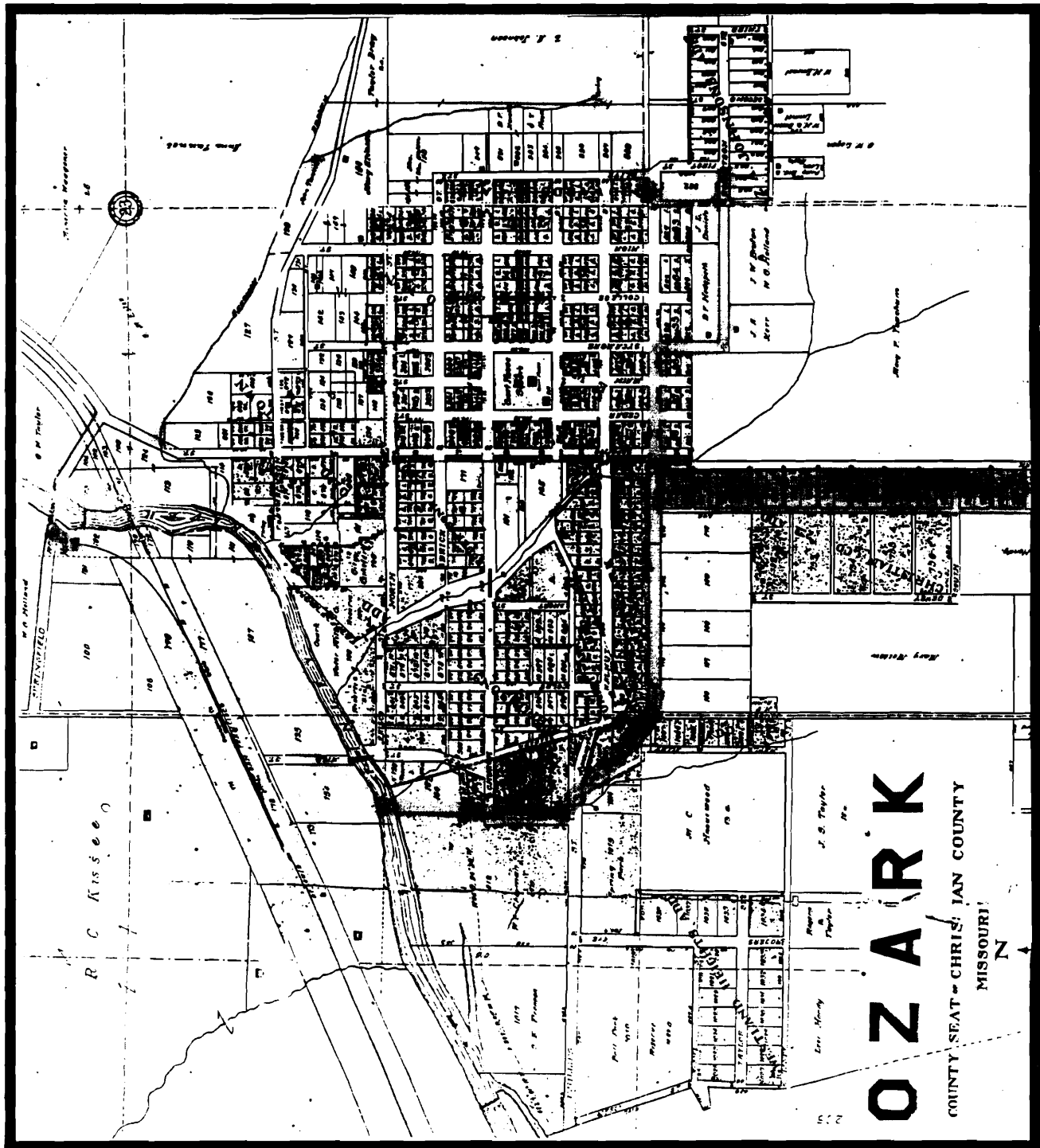

Figure 3. 1912 Plat Map of Ozark, Missouri. Survey Area highlighted.

Final Report
Ozark Historic Resources Survey

State HPF Project No. 29-98-13128-477

RECEIVED
AUG 09 1999

HISTORIC PRESERVATION
PROGRAM

Introduction

The Ozark Historic Preservation Commission received a Historic Preservation Fund grant to conduct a survey of the city's cultural resources within its core historic development area. The results of this survey will help clarify how the city of Ozark developed, and how its architectural heritage expresses and represents the historic development of this typically rugged Ozark mountain town.

The Ozark Historic Preservation Commission is mandated to consider the effects of growth on historic neighborhood preservation, downtown economic viability, and potential downtown abandonment. This survey represents a first step toward such an evaluation by identifying the cultural resources that are significant or representative of the city's historic development. Through documentation of the significance and integrity of these historic structures local government officials, property owners, tourists, and the community as a whole may better understand the value of historic architecture, and subsequently, the wisdom of its preservation and enhancement.

To introduce the intent and scope of the survey to Ozark citizens, an initial public meeting was held in the City Hall on 10 March 1998. The survey plan was presented, with its purpose, procedure, and how it might affect property owners and the community discussed. The final survey results were presented to the public on 01 July 1999 at the regular monthly session of the Ozark Historic Preservation Commission.

Objectives

Historic resources were identified and evaluated for potential eligibility of listing on the National Register of Historic Places. The criteria used in selection for survey initially was based on the Secretary of the Interior's Standards for Evaluation which very generally consists of a fifty-year age requirement, on the historical integrity of each site or structure, and historical significance. The information garnered through the survey will provide a better understanding of the social, economic, cultural trends, and growth patterns associated with the development of Ozark. The survey is an opportunity for the Commission to enhance the community's education and understanding of the benefits of historic preservation in Ozark.

Geographical Survey Boundaries

The city was surveyed in 1835, and land officially offered for homesteading in 1838. A city square was designated in what is known as "old town," and the first lots sold for residential and commercial

south of the original. Historic structures and development patterns have been identified using historic plat maps of Ozark, Sanborn Insurance maps, and the literature. The planned layout and development of the city are well illustrated by the extant historic structures and neighborhoods that are the subjects of this survey.

The survey area encompasses the downtown square and neighborhoods radiating for several blocks in all directions from the square, including the Ozark Mill, spillway, and bridge located on the Finley River; and a Prohibition Era gambling “speakeasy.” Other sites outside the core development area were considered for inclusion in the survey, but while many are architecturally significant, they were determined to represent developments separate and distinct from the context of the historic city center. These may be recorded as an addendum by the City at later time. Cemeteries were considered in the survey plan, but are not listed in the final because they are of local significance only, and do not merit national significance.

Methodology

Through the study of historical city development plans and field reconnaissance, 221 sites and structures initially were identified for survey and documentation, but 40 buildings or sites were deleted from the final list due to the loss of integrity. The survey was organized into two research components: archival and site investigation. The buildings identified in the initial field study were researched in the city and county archives, and in the literature. They were evaluated and then recorded on survey forms, which includes a photograph of each structure. The current photographic documentation was produced with small format photography. This documentation includes at least one black and white 5X7 print of each structure. Archival data were researched in the following resources:

Tax Assessor records
Sanborn Insurance Maps
Ozark Plat Maps
City and County records

Christian County Historical Society Museum
Christian County Library History Collection
Literature

Brief History of Ozark

The city of Ozark is a typical development of pre-Civil War times in the rugged Ozark Mountain region. Its isolation from the larger and more prosperous towns of the Missouri and the Mississippi rivers suited the most independent of pioneers searching for available western land. These were hearty pioneers who migrated primarily from the states of Virginia, Tennessee, Ohio, and Kentucky. They settled along the Finley and James rivers and tributary creeks, preferring the rocky slopes and bottom lands to the grasslands of the Springfield Plateau nearby. There were at least two periods of major migration between the 1830s and the 1850s, and from the post Civil War period through the early to mid-20th century. Before 1830, pioneer settling was sparse and few structural remains exist today.

Ozark settlers primarily made their living by subsistence farming, cattle ranching, and marginal lead and zinc mining. The arrival of the Ozark branch of the St. Louis and San Francisco Railroad in 1882 resulted in increased timber sales for some land owners. Because labor for timber harvesting

1882 resulted in increased timber sales for some land owners. Because labor for timber harvesting was provided primarily by Swedish and Irish immigrants, boarding houses and hotels experienced a booming business during the construction years. It also meant the easy transport of goods in and out of Ozark. Ozark became a departure point for shipping livestock north, and at one time was the largest beef shipping point on the Frisco Railroad system. Later, large amounts of produce such as blackberries, strawberries, and canned tomatoes were distributed out of Ozark on the rail system.

One industry unchanged by the arrival of the railroad was the freight wagon business. The rugged Ozark terrain made train travel slow. A wagon team could make the trek to Springfield in comparable time, and would bring you back in the same day. The train made only one trip per day from Springfield to Ozark. Those who traveled to Springfield on the train, were obligated to stay the night until the next day's train returned.

Ozark was established in 1848 and became the seat of Christian County in 1859. Except the mill and associated businesses along the river, substantial construction in Ozark's center did not take place until after the end of the Civil War. The area around the Ozark Mill represents the first commercial district in Ozark.

After the Civil War, construction increased again, but it was not until the prosperity of the late 1890s that the substantial commercial district developed in downtown Ozark. This construction era continued through the early 1920s. Most of the structures that make up the current commercial downtown, including the Christian County courthouse were constructed during this period. Most of the buildings that make up the current residential neighborhoods in the downtown area were built between the 1890s and the 1930s. Another active historic building era was from post-World War II through 1950.

Mention must be made here about a well-known secret society of Ozark men, the Baldknobbers. This was an infamous group who, nonetheless, contributed to Ozark's history and significance. The Baldknobbers were a post-Civil War vigilante group that took on the cause to restore peace and proper behavior to the community by physically punishing—and always in the dark of night—those who the group believed to have behaved badly. They wrought punishment on those who allegedly mistreated wives, drank, cursed, or committed theft. The Baldknobbers were not mere criminals without strong family or community ties, but were well known citizens of Christian County who were determined to make the area a safe and decent place to live. Their actions, however, soon took on a more criminal element than those upon whom they administered punishment. Their reign of domestic terror culminated with the public hanging of three of its leaders on the Ozark Courthouse Square in 1889. Thousands traveled to this tiny Ozark town to witness the execution, including newspaper reporters from as far away as St. Louis and Kansas City.

Survey Results

The historic development of Ozark is based on subsistence farming in the early years, and eventually with livestock and agricultural farming associated with the convenience of railroad service. Much of Ozark's structural history is typical of a modest agriculturally based community, evident in buildings constructed between mid-1860s and the late 1940s. It developed steadily after the end of the Civil War, benefitted economically, albeit briefly, with the arrival of the railroad, then

decades have once again produced steady and substantial growth. An index of buildings follows the end of this report, organized by construction dates.

The structural categories include the following:

- One hundred forty-six (146) **residential** dwellings;
- Twenty-two (22) **commercial** buildings located primarily on or near the town square;
- Five (5) **industrial** buildings;
- Four (4) **public** buildings;
- Four (4) **religious** buildings.

The author was hard pressed to find historic buildings possessing high degrees of historical integrity. Generally, if a historic building retained its massing, facade, and its physical elements (footprints) were basically intact, then it was considered a contributing structure to the historic street scape. Artificial siding represents the most serious and widespread integrity issue in historic Ozark. In fact, many buildings listed on the local Register of Historic Places are clad in artificial siding. In such cases, the author deferred to the local Commission's designations. There are some buildings with artificial siding that suffered greater degradation than others. Often, gable ends were embellished with design configurations using the new siding, and this was deemed an unacceptable violation of buildings' historical integrity.

National Register Evaluations

There are at least four individual buildings eligible for National Register status, and they are as follows:

- Christian County Courthouse (Field No. 3-29.1), deemed eligible but never nominated;
- WPA Community Building (Field No. 3-23.1) on the southeast side of the square;
- WPA Public School building (Field No. 3-37.1) on North 4th Avenue;
- Riverside Inn, located two miles north of city center (Field No. 14-0.0.14);
- Ozark Mill (3-2.1), located on North 4th Street on the Finley River.

There are some historic districts within the survey area that might be considered for local and national historic district nomination, and they are as follows:

- Ozark Courthouse Square, including buildings facing the courthouse;
- Farmer and Jackson streets, east from 3rd Street to North 4th Avenue;
- North 2nd Avenue, north from Hall Street to East Farmer Street; and,
- Neighborhood west of South 3rd Street incorporating West Walnut, West Elm, West Church to 9th Street, and North 6th and North 8th streets.

Conclusion

To make more effective use of historic resources, it is necessary to integrate preservation into community planning activities. This survey was designed to provide some needed information for more effective use of the community's resources. This survey will contribute to the preservation efforts of the Ozark community by providing city planners with a detailed listing and description of significant structures and potential historic districts.

The City Historic Preservation Commission may use the survey data to increase public awareness, education, and for listing buildings or districts on the City Historic Register. The survey and inventory information will enhance the Commission's advisory role with the City Planning and Zoning Commission. Planning and Zoning will, in turn, have usable data for more informed and effective planning. The City Tourism Board and the Community Development Authority will use the data to plan and develop Ozark's economic potential based on the most significant historic resources.

Bibliographic Sources:

Christian County Centennial, Inc.

1959 Christian County: Its First 100 Years. Written and published by Christian County Centennial Committee, Ozark, Missouri.

Christian County Tax Assessor

n.a. Christian County Tax Records. Christian County Courthouse, Ozark, Missouri.

Collier, William N.

1946 Ozark and Vicinity in the Nineteenth Century. Published by the author, Ozark, Missouri.

Doss, Mary (Brown)

1979 Ozark: Now & Then: History 1895-1965. Published by author, Ozark, Missouri.

Gordon-Van Tine Company

1992 117 House Designs of the Twenties. Republication of *Gordon-Van Tine Homes*, 1923. NY: Dover Press, Inc.

Harris, Cyril M.

1998 American Architecture: An Illustrated Encyclopedia. NY: W. W. Norton & Company.

Jester, Thomas C., editor

1995 Twentieth-Century Building Materials: History and Conservation. McGraw-Hill Companies.

McAlester, Virginia and Lee McAlester

1996 A Field Guide to American Houses. NY: Alfred A. Knopf, Inc.

Rafferty, Milton D.

1980 The Ozarks: Land and Life. Norman: University of Oklahoma Press.

Sanborn Map

- 1900 Ozark, Christian County, Missouri, July 1900. New York: Sanborn-Perris Map Company.
- 1906 Ozark, Christian County, Missouri, October 1906. New York: Sanborn Map Company.
- 1914 Ozark, Christian County, Missouri, October 1914. New York: Sanborn Map Company.
- 1930 Ozark, Christian County, Missouri, August 1930. New York: Sanborn Map Company.

Sears, Roebuck and Co.

- 1990 Sears, Roebuck Home Builder's Catalog: The Complete Illustrated 1910 Edition. NY: Dover Publications, Inc.

Sears, Roebuck and Co.

- 1991 Small Houses of the Twenties: The Sears, Roebuck 1926 House Catalog. Unabridged Reprint. NY: Dover Publications, Inc.

Sizemore, Jean

- 1994 Ozark Vernacular Houses: A Study of Rural Homeplaces in the Arkansas Ozarks, 1830-1930. Fayetteville: University of Arkansas Press.

Stevenson, Katherine Cole and H. Ward Jandl

- 1986 Houses by Mail: A Guide to Houses from Sears, Roebuck and Company. Washington, DC: Preservation Press, The National Trust for Historic Preservation.

Vaughan, James R., J.J. Gideon, and W.H. Pollard

- 1893 *A History of Christian County, Missouri. From an old manuscript prepared by James R. Vaughan, J.J. Gideon, and W.H. Pollard and read by the former at a Celebration at Ozark, Missouri, July 4th, 1876.* Published by E.E. Patterson, Ozark Missouri.

Walker, Lester

- 1997 American Shelter. Woodstock, NY: The Overlook Press.

Williams, John Eutsler

- 1988 By-Gone Days: Ozark in the Ozarks of Missouri. Published by author.

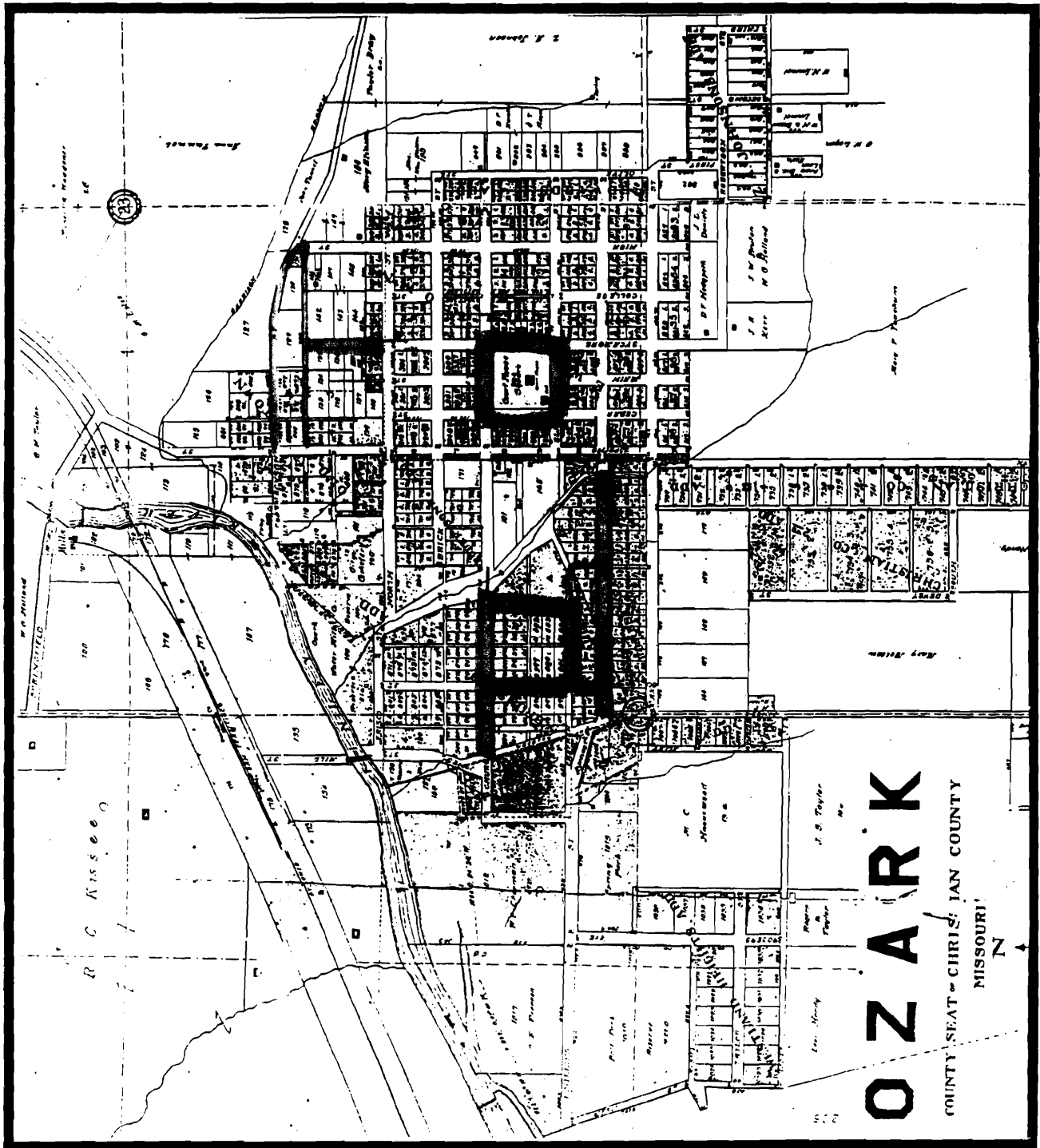

Highlighted: Potential Historic Districts

OZARK HISTORIC RESOURCES SURVEY

	ADDRESS	FIELD NO.	CONST DATE	PARCEL NO.	BUILDING OWNERS
1	NORTH 4TH STREET	3-2.1	1833	11.06.23.003.002.001	BASS PRO SHOPS
2	NORTH 2nd STREET 107	3-15.8	1850	11.06.23.003.015.008	COREY J. SCHNEIDER
3	NORTH 3RD STREET 602	3-1.6	1855	11.06.23.003.001.006	JERRY WAYNE COWAN
4	SOUTH 3RD AVENUE 205	3-31.5	1858	11.06.23.003.031.005	SHARON RYSTED
5	SOUTH 2ND AVENUE 302	2-1.5	1860	11.07.26.002.001.005	G.O. PIERCE & DAVID LEE
6	WEST HALL 402	3-5.4	1860	11.06.23.003.005.004	ROBERT CONRAD
7	SOUTH 1ST STREET 101	3-20.1	1863	11.06.23.003.020.001	JACK FARTHING
8	EAST CHURCH STREET 302	3-28.2	1870	11.06.23.003.028.002	RUSSELL D. HARDIN
9	SOUTH 9TH STREET 205	4-4.11	1872	11.05.22.004.004.011	CHARLES & CONNIE POWELL
10	WEST WALNUT STREET 503	3-11.5	1877	11.06.023.003.011.005	GLEN & BARBARA SHIPLEY
11	EAST HALL 208	3-26.1	1878	11.06.23.003.026.001	SHAD & MICHELLE GAMEL
12	SOUTH 3RD STREET 304	2-3.3	1880	11.07.26.002.003.003	RUSSELL & JEANNIE WHITSON
13	NORTH 2ND STREET 117	3-15.6	1880	11.06.23.003.015.006	PEARL BRUTON
14	NORTH 2ND STREET 119	3-15.7	1880	11.06.23.003.015.007	JONATHAN & LISA LANE
15	NORTH 2nd STREET 209	3-16.2	1880	11.06.23.003.016.002	CHLORENE HEDGEPEETH
16	SOUTH 1ST STREET 106	3-23.3	1880	11.06.23.003.023.003	GERALD & LOLA GARRISON
17	NORTH 2ND AVENUE 201	3-28.6-5	1880	11.06.23.003.028.006-5	KEN DAVIS
18	SOUTH 3RD STREET 107	3-8.1	1880	11.06.23.003.008.001	CHLORENE HEDGEPEETH
19	WEST CHURCH STREET 101	3-19.5	1882	11.06.23.003.019.005	OZARK BUSINESS SERVICES
20	WEST CHURCH STREET 901	4-4.2	1883	11.06.23.004.004.002	MARK & LINDA PERRY
21	NORTH 2ND STREET 115	3-15.5	1888	11.06.23.003.015.005	ROYCE FESSENDEN
22	NORTH 2nd STREET 101	3-15.9	1888	11.06.23.003.015.009	JONATHAN & LISA LANE
23	WEST WALNUT STREET 304	3-12.3	1890	11.06.023.003.012.003	JENNIE FARTHING
24	WEST WALNUT STREET 306	3-12.4	1890	11.06.023003.012.004	CAMPBELL FAMILY
25	SOUTH 3RD STREET 507	2-17.4	1894	11.07.26.002.017.004	JOHN E. WILLIAMS
26	EAST CHURCH STREET 101-103	3-24.2-4	1897	11.06.23.003.024.02-4	LARRY LISTER (101); KATHERINE DOWDY (105)
27	EAST WALNUT STREET 206	3-31.1	1898	11.06.23.003.031.001	LOYCE BILYEU
28	SOUTH 5TH AVENUE 305	2-1.10	1900	11.07.26.002.001.010	BOB & JOYCE BRUMLEY
29	SOUTH 2ND AVENUE 308	2-1.7	1900	11.07.26.002.001.007	JOHN & CHLORENE HEDGEPEETH
30	EAST ROBERTSON 202	2-25.4	1900	11.07.26.002.025.004	BARBARA & MARVEL MILLS
31	NORTH 4TH STREET 803	2-3.10	1900	11.06.23.002.003.010	PATRICIA BALMER
32	WEST WALNUT STREET 303	3.11.1	1900	11.06.023.003.011.001	ERNEST & RUBY YATES
33	NORTH 8TH STREET 106	3-10.10	1900	11.06.23.003.010.010	CHARLES & TEXIE JO DUNN
34	NORTH 6TH STREET 103	3-10.13	1900	11.06.23.003.010.013	RUTH FORGEY
35	WEST CHURCH STREET 604	3-10.2	1900	11.06.23.003.010.022	RUTH HUCKABY

OZARK HISTORIC RESOURCES SURVEY

	ADDRESS	FIELD NO.	CONST DATE	PARCEL NO.	BUILDING OWNERS
36	NORTH 8TH STREET 109	3-10.5	1900	11.06.23.003.010.005	ELIZABETH ANDERSON DILLON
37	WEST WALNUT STREET 513	3-11.10	1900	11.06.023.003.011.010	MARY RUTH RAINEY
38	WEST WALNUT STREET 509	3-11.8	1900	11.06.023.003.011.008	JOHN & AUDRE DUNNING
39	WEST WALNUT STREET 511	3-11.9	1900	11.06.023.003.011.009	DONALD & JOSEPHINE YOUNG
40	WEST WALNUT STREET 512	3-12.10	1900	11.06.023.003.012.010	AMY SWEARINGIN
41	WEST WALNUT STREET 804	3-12.13	1900	11.06.023.003.012.013	NED WILKINSON
42	WEST WALNUT STREET 508	3-12.9-1	1900	11.06.023.003.012.009-1	DELORIS HERDRICK
43	WEST BRICK STREET 101	3-18.2	1900	11.06.23.003.018.002	JANIS K. RIGGINS/HALINA WILSON
44	WEST ELM STREET 103	3-20.2	1900	11.06.23.003.020.002	PATRICK & MARILYN FLETCHER
45	WEST ELM STREET 109	3-20.3	1900	11.06.23.003.020.003	GARY ACKER
46	SOUTH 2ND AVENUE 203	3-22.1	1900	11.06.23.003.022.001	GRACE BAPTIST CHURCH
47	EAST BRICK STREET 101	3-25.2	1900	11.06.23.003.025.002	SARAH FORGEY
48	EAST CHURCH STREET 203	3-27.4	1900	11.06.23.003.027.004	MARILYN SHIPMAN
49	EAST CHURCH STREET 205	3-27.5	1900	11.06.23.003.027.005	MARILYN SHIPMAN
50	NORTH 4th AVENUE 408	3-37.3	1900	11.06.23.003.037.003	ALLAN & LINDA SCHILTER
51	NORTH 2ND AVENUE 404	3-38.7	1900	11.06.23.003.038.007	CHARLES & JULIE WATSON
52	NORTH 2ND AVENUE 409	3-39.1	1900	11.06.23.003.039.001	ELIZABETH FORRESTER
53	EAST FARMER 207	3-40.6	1900	11.06.23.003.040.003	RAY & MAXINE PAINTER
54	NORTH 6TH STREET 108	3-9.4	1900	11.06.23.003.009.004	JOHNNY RAY HOLZSCHUBER
55	SOUTH 9TH STREET 201	4-10.1	1900	11.05.22.004.004.010-1	WESLEY & JEANETTE DORAN
56	EAST ELM STREET 406	4-12.2	1900	11.06.23.004.012.002	THOMAS & MARTHA TAYLOR
57	WEST CHURCH STREET 900	4-4.12	1900	11.06.23.004.004.012	KLEIN & PAM CLAVERT
58	EAST ELM STREET 402	3-35.2	1902	11.06.23.003.035.002	MARVIN & TERRY MERRITT
59	SOUTH 6TH AVENUE 204	4-14.7	1902	11.06.23.004.014.007	DANIEL BROUGHTON & AMY STEPHENS
60	WEST WALNUT STREET 309	3-11.3	1903	11.06.023.003.011.003	KAREN KELTNER
61	NORTH 2ND AVENUE 408	3-38.5	1903	11.06.23.003.038.005	LARRY & CARMEN EIB
62	SOUTH 3RD STREET 901	2-12.7	1905	11.07.26.002.012.007	ROBERT & RUBY BAIRD
63	WEST CHURCH STREET 109	3-19.3	1905	11.06.23.003.019.003	BLAINE & LAURA CASH
64	NORTH 6TH AVENUE 108	4-10.4	1905	11.06.23.004.010-4	SHARON & DUANE HOOK
65	EAST ELM STREET 301	3-28.12	1907	11.06.23.003.028.012	JO ANNE SAKAOKA
66	EAST ELM STREET 208	3-30.1	1907	11.06.23.003.030.001	DISCIPLES OF CHRIST CHURCH
67	WEST CHURCH STREET 103-105	3-19.4	1909	11.06.23.003.019.004	STEVE & SUSAN MARLER
68	NORTH 6TH STREET 104	3-9.1	1909	11.06.23.003.009.001	ROBERT WILSON
69	WEST WALNUT STREET 305	3-11.2	1910	11.06.023.003.011.002	GWEN SWEARINGIN
70	WEST WALNUT STREET 505	3-11.6	1910	11.06.023.003.011.006	BEVERLY JESSIP

OZARK HISTORIC RESOURCES SURVEY

	ADDRESS	FIELD NO.	CONST DATE	PARCEL NO.	BUILDING OWNERS
71	EAST BRICK STREET 305	3-26.7	1910	11.06.23.003.026.007	PANSY GROVES
72	WEST CHURCH STREET 605	3-4.10	1910	11.06.23.003.004.010	DONALD & ANITA DETHEROW
73	SOUTH 6TH AVENUE 202	4-14.6	1910	11.06.23.004.014.006	TODD & PENNY BEELER
74	EAST CHURCH STREET 406	4-11.1	1911	11.06.23.004.011.001	PATRICK & PHYLLIS STEWART
75	WEST CHURCH STREET 904	4-4.4	1911	11.05.22.004.004.004	MARK & SUSAN BRYANT
76	SOUTH 6TH AVENUE 308	1-4.6	1912	11.07.26.001.004.006	GERALD GARRISON
77	NORTH 8TH STREET 105	3-10.7	1912	11.06.23.003.010.007	FREDERICK JOHN & CAROL DUTSMAN
78	WEST CHURCH STREET 803	3-4.4	1913	11.06.23.003.004.004	GARY RAINEY
79	NORTH 2ND STREET 105	3-15.8-1	1914	11.06.23.003.015.008	COREY J. SCHNEIDER
80	SOUTH 3RD STREET 106	3-15.8-2	1914	11.06.23.003.015.008	COREY J. SCHNEIDER
81	McCRACKEN ROAD	3-2.1.1	1914	11.06.23.003.002.001	CITY OF OZARK
82	EAST CHURCH STREET 105	3-24.4	1914	11.06.23.003.024.004	KATHERINE DOWDY
83	EAST CHURCH STREET 304	3-28.1	1914	11.06.23.003.028.001	EDWARD LYNN/JEANNE FULLER
84	EAST CHURCH STREET 202	3-28.4	1914	11.06.23.003.028.004	CHRISTIAN CO. HISTORICAL SOCIETY
85	NORTH 2ND AVENUE 410	3-38.4	1914	11.06.23.003.038.004	GARY & ELIZABETH LONG
86	EAST HALL 203	3-38.9	1914	11.06.23.003.038.009	RADIE & MARILYN BUNN
87	SOUTH 3RD STREET 105	3-8.6	1914	11.06.23.003.008.006	OZARK BUSINESS SERVICES
88	EAST CHURCH STREET 201	3-27.3-2	1919	11.06.23.003.027.003-2	FREE WILL BAPTIST CHURCH
89	EAST ROBERTSON 502	1-6.6	1920	11.07.26.001.006.006	JOHN & JEWEL ROGERS
90	10TH AVENUE 401	1-8.1	1920	11.07.26.001.008.001	NAN PITTS
91	SOUTH 3RD STREET 501	2-17.3	1920	11.07.26.002.017.003	MARY M. STONE
92	SOUTH 3RD STREET 707	2-17.8	1920	11.07.26.002.017.008	LILLIE VAN HORN
93	WEST JACKSON STREET 103	3-1.12	1920	11.06.23.003.001.012	AMOS & LEONA SMITH
94	WEST JACKSON STREET 301	3-1.14	1920	11.06.23.003.001.014	W. H. & MERLE ARMITAGE
95	NORTH 8TH STREET 104	3-10.11	1920	11.06.23.003.010.011	PATRICK & DORCAS SEARS
96	WEST CHURCH STREET 702	3-10.3	1920	11.06.23.003.010.003	WARD & VIRGINIA DAY
97	WEST ELM STREET 204	3-14.2	1920	11.06.23.003.014.002	WILBUR WILSON
98	WEST WALNUT STREET 102	3-21.1	1920	11.06.23.003.021.001	PHILLIP & PAMELA SCHROEDER
99	WEST CHURCH STREET 100	3-29.1	1920	11.06.23.003.029.001	CHRISTIAN COUNTY (COURTHOUSE)
100	EAST WALNUT STREET 406	3-33.1	1920	11.06.23.003.033.001	TERRENCE & SHELLY OETIT
101	NORTH 4TH AVENUE 404	3-37.1-2	1920	11.06.23.003.037.001	OZARK R-6 SCHOOLS OFFICE
102	EAST HALL 207	3-38.11	1920	11.06.23.003.038.011	NELLIE GRIDER
103	WEST CHURCH STREET 601	3-4.12	1920	11.06.23.003.004.012	MICHAEL E. WHEAT
104	WEST HALL 308	3-5.3	1920	11.06.23.003.005.003	LARRY BLADES
105	WEST CHURCH STREET 306	3-8.3	1920	11.06.23.003.008.003	STEVE & SHIRLEY JENSEN

OZARK HISTORIC RESOURCES SURVEY

	ADDRESS	FIELD NO.	CONST DATE	PARCEL NO.	BUILDING OWNERS
106	NORTH RIVERSIDE ROAD 2629	14-0.0-14	1923	11.06.14.000.000.014	ERIC ENGLE
107	WEST JACKSON STREET 305	3-1.18	1923	11.06.23.003.001.018	ORVILLE DAVIDSON
108	NORTH 4TH AVENUE 406	3-37.2	1923	11.06.23.003.037.002	ANITA & JOHN WERNER
109	WEST WALNUT STREET 504	3-12.7	1924	11.06.023.003.012.007	ADAMS FUNERAL HOME
110	NORTH 2ND AVENUE 305	3-25.1	1924	11.06.23.003.025.001	DANA & TIMOTHY McCORMICK
111	NORTH 3RD STREET 401	3-3.14	1925	11.06.23.003.003.014	M. L. CAMPBELL FAMILY
112	WEST CHURCH STREET 704	3-10.4	1928	11.06.23.003.010.004	BILL SCOTT
113	EAST OAK STREET 404	2-1.11	1929	11.07.26.002.001.011	CITY OF OZARK
114	McCRACKEN ROAD 402	2-4.1	1929	11.06.23.002.004.001	BASS PRO OUTDOOR WORLD
115	EAST ROBERTSON 701	1-3.5	1930	11.07.26.001.003.005	PEARL BRUMLEY & CAROL JEAN JOHNSON
116	EAST ROBERTSON 702	1-8.12	1930	11.07.26.001.008.012	RICHARD WISSEL
117	SOUTH 3RD STREET 803	2-12.9	1930	11.07.26.002.012.009	RONALD & RUTH SPARGO
118	WEST JACKSON STREET 203	3-1.10	1930	11.06.23.003.001.010	FRANK & MITZI LORENZ
119	WEST JACKSON STREET 201	3-1.8	1930	11.06.23.003.001.008	THOMAS & VERGIE ABNEY
120	NORTH 6TH STREET 101	3-10.12	1930	11.06.023.003.010.012	DONALD & SONYA BROWN
121	WEST WALNUT STREET 803	3-11.11	1930	11.06.023.003.011.011	BILLY & RUTH ANN HANKS
122	EAST CHURCH STREET 305	3-27.6	1930	11.06.23.003.027.006	ROGER, DAVID, JERRY GROVES
123	WEST HALL 307	3-3.11	1930	11.06.23.003.003.011	HARLAND & DONNA SCHROEDER
124	NORTH 3RD STREET 403	3-3.17	1930	11.06.23.003.003.017	DALCIE RAINEY
125	NORTH 3RD STREET 411	3-3.20	1930	11.06.23.003.003.020	BILL & SUZANNE VANYIG
126	EAST WALNUT STREET 402	3-33.2	1930	11.06.23.003.033.002	D. & E. KELLY and R. BAIRD
127	EAST OAK 401	3-33.3	1930	11.06.23.003.033.003	JOHN R. WALKER
128	EAST CHURCH STREET 402	3-36.1	1930	11.06.23.003.036.001	MARY SHUBERT
129	NORTH 4TH AVENUE 405	3-38.13	1930	11.06.23.003.038.013	DONALD & MARY WILCOX
130	WEST FARMER 212	3-38.2	1930	11.06.23.003.038.002	ALFRED & SUE BERRY
131	NORTH 3RD STREET 306	3-39.7	1930	11.06.23.003.039.007	PATRICK ROBERTSON
132	WEST CHURCH STREET 701	3-4.9	1930	11.06.23.003.004.009	DEAN & MARY ADAMS
133	SOUTH 6TH AVENUE 201	4-10.7	1930	11.06.23.004.010.007	FRED & MABLE BADLEY
134	EAST ELM STREET 407	4-11.3	1930	11.06.23.004.011.003	KEVIN & LORI ENNIS
135	EAST ELM STREET 408	4-12.1	1930	11.06.23.004.012.001	WADE WASSON
136	SOUTH 6TH AVENUE 305	1-5.1	1931	11.07.26.001.005.001	ELISE CRAIN
137	WEST CHURCH STREET 804	3-10.6	1932	11.06.23.003.010.006	KELLY & VICKI WALLANDER
138	EAST WALNUT STREET 202	3-31.3	1932	11.06.23.003.031.003	THELMA HALL
139	EAST ROBERTSON 609	1-4.8	1934	11.07.26.001.004.008	JOHN & PHYLLIS DONNELLY
140	EAST ELM STREET 101	3-23.1	1934	11.06.23.003.023.001	CITY OF OZARK

OZARK HISTORIC RESOURCES SURVEY

	ADDRESS	FIELD NO.	CONST DATE	PARCEL NO.	BUILDING OWNERS
141	EAST WALNUT STREET 205	3-30.6	1935	11.06.23.003.030.006	WILLIAM & MARIE ARMITAGE
142	NORTH 4TH AVENUE 407	3-38.14	1935	11.06.23.003.038.014	M. RUTH MARLEY, DAVID WILCOX
143	WEST CHURCH STREET 801	3-4.5	1937	11.06.23.003.004.005	SUZANNE L. BLANSIT
144	EAST JACKSON STREET 604	4-10.2	1938	11.06.23.004.010.002	JOHN & CULAH NIXON
145	SOUTH 6TH AVENUE 304	1-4.5	1939	11.07.26.001.004.005	MICHAEL & THADINE HARTLEY
146	SOUTH 3RD STREET 903	2-12.6	1940	11.07.26.002.012.006	LEONARD & MELANIE NOVACINSKI
147	EAST ROBERTSON 314	2-26.2	1940	11.07.26.002.026.002	VERNA DAISY ANDRUS
148	EAST ROBERTSON 306	2-26.3-1	1940	11.07.26.002.026.003.001	HUBA & TONY SWAYNE
149	WEST CHURCH STREET 602	3-10.1	1940	11.06.23.003.010.001	MARY WETER
150	WEST WALNUT STREET 501	3-11.4	1940	11.06.023.003.011.004	WALTER & CLETA SUTER
151	SOUTH 2ND STREET 207	3-13.2	1940	11.06.23.003.013.002	ROGER BENNETT & TIMOTHY JEAN
152	WEST ELM STREET 208	3-14.3	1940	11.06.23.003.014.003	CHARLOTTE & EVAN DUNCAN
153	NORTH 2ND STREET 304	3-18.1	1940	11.06.23.003.018.001	BLANCHE BERBERIA
154	EAST BRICK STREET 206	3-27.3-1	1940	11.06.23.003.027.003-1	TERESA WILSON
155	EAST WALNUT STREET 203	3-30.5	1940	11.06.23.003.030.005	THELMA FLAKE
156	EAST WALNUT STREET 204	3-31.2	1940	11.06.23.003.031.002	OPAL M. ALLEN
157	EAST WALNUT STREET 304	3-32.2	1940	11.06.23.003.032.002	STEVE A. MAPLES
158	NORTH 4TH AVENUE 404	3-37.1	1940	11.06.23.003.037.001	OZARK NORTH ELEMENTARY
159	NORTH 2ND AVENUE 402	3-38.8-1	1940	11.06.23.003.038.008-1	MICHAEL & EDIE GROVES
160	WEST HALL 101	3-39.10	1940	11.06.23.003.039.010	RAMONA K. RICHARDS
161	NORTH 3RD STREET 404	3-39.6	1940	11.06.23.003.039.006	BILLY & RUTH ANN HANKS
162	NORTH 2ND AVENUE 403	3-39.9-2	1940	11.06.23.003.039.009-2	ROBYN MEDEARIS
163	EAST FARMER 211	3-40.3	1940	11.06.23.003.040.003	DANIEL GARRISON
164	WEST ELM STREET 501	3-9.3	1940	11.06.23.003.009.003	MAXINE BILYEU
165	SOUTH 6TH AVENUE 302	1-4.4	1944	11.07.26.001.004.004	DON & LUCY ELLIOT
166	EAST ROBERTSON 608	1-6.2	1945	11.0726.001.006.002	CECIL & DANNY CLINTON
167	EAST HALL 206	3-26.2	1945	11.06.23.003.026.002	TINA LUCILLE CORNOG
168	EAST HALL 204	3-26.3	1945	11.06.23.003.026.003	WILLIAM & JULIE ANDERSON
169	EAST HALL 205	3-38.10	1945	11.06.23.003.038.010	DAVID & BETTY JENKS/PATRICIA HUGHES
170	EAST FARMER 209	3-40.5	1945	11.06.23.003.040.005	SCOTTIE & PAMELA SNIDER
171	EAST FARMER 205	3-40.7	1945	11.06.23.003.040.007	RAY & MAXINE PAINTER
172	SOUTH 6TH AVENUE 206	4-14.8	1947	11.06.23.004.014.008	DONALD & MARY ANN HARPER
173	EAST ROBERTSON 606	1-6.3	1948	11.07.26.001.006.003	PAUL & PEGGY BEDWELL
174	EAST FARMER 102	3-39.3	1948	11.06.23.003.039.003	KATHRYN PARSON
175	EAST FARMER 203	3-40.8	1948	11.06.23.003.040.008	JOSEPH H. & MABLE HORNER

OZARK HISTORIC RESOURCES SURVEY

	ADDRESS	FIELD NO.	CONST DATE	PARCEL NO.	BUILDING OWNERS
176	EAST FARMER 201	3-40.9	1948	11.06.23.003.040.009	SANDRA INGENTHRON
177	EAST ROBERTSON 604	1-6.4	1949	11.07.26.001.006.004	SHARON RYSTED
178	NORTH 3RD STREET 412	3-39.4	1949	11.06.23.003.039.004	HANKS HOME CENTER
179	SOUTH 2ND AVENUE 303-305	2-24.2	1950	11.07.26.002.024.002	TIMOTHY & LESLIE KILPATRICK
180	SOUTH 3RD AVENUE 106	3-34.3	1950	11.06.23.003.034.003	CLEARBROOK LAND CO.
181	NORTH 2ND STREET 121	3-15.1	1959	11.06.23.003.015.001	JOHN & JANE HARPOLE