

Normal-Sprigg Historic District Survey

Bellevue Street to Terrace Drive

Cape Girardeau, Missouri

Conducted by
Students of the Historic Preservation Program
Southeast Missouri State University

Spring, 2009

Linda Brott
Thomas Eiceman
Karl Emch
Edward Farrell
Marla Ives
Eric Kulengowski
Anthony Machiran

Wilson Newman
Stephanie Palmer
Lauren Pollien
Megan Ritterbusch
Kasey Skelton-Eiceman
Jennifer Topper

Survey Coordinator: Kasey Skelton-Eiceman

HP 588: Legal and Economic Principles of Historic Preservation
Dr. Steven J. Hoffman

Normal-Sprigg Local Historic District Survey

Bellevue Street to Terrace Drive

Students in the Legal and Economic Principles of Historic Preservation class (HP 588), under the guidance of Dr. Steven Hoffman, conducted an architectural survey of residential buildings in the Normal-Sprigg Local Historic District in Cape Girardeau, Missouri. The main purpose of this survey was to construct an inventory of the buildings in the neighborhood immediately adjacent to Southeast Missouri State University for the Historic Preservation Commission of Cape Girardeau.

The area surveyed is bounded by Terrace Drive on the north, Pacific Street on the West, Sprigg Street on the East, and Bellevue on the south.

The proposed Boulevard Historic District is architecturally significant as an excellent example of an early to mid-twentieth century neighborhood housing Cape Girardeau's expanding middle class from the early twentieth century until the present day. The Normal Sprigg District retains its character as a distinctive neighborhood comprised of homes built in a variety of twentieth century architectural styles along streets lined with mature trees. South of Normal Avenue the building stock is older and the neighborhood is characterized by its straight streets and sidewalks, and its similar architectural styles, rooflines, and building heights. North of Normal Avenue, the streets are curvilinear and do not have sidewalks, and represent more modern styles, including a number of midcentury modern ranch style homes.

The predominant styles represented in this neighborhood include Tudor Revival, Colonial Revival, Dutch Colonial, Neoclassical Revival, and Ranch. Other early twentieth century

American styles represented in this neighborhood are the Queen Anne style and the American Foursquare. These are the dominant housing styles favored by America's middle class families from the early years of the twentieth century through the 1950s. Although there are several infill apartment buildings that are incompatible intrusions, the neighborhood retains its historic look and feel, and contains several landmark structures. In addition to a landmark quality NeoClassical Revival home (702 North Street) and a Gothic Revival church (300 N. Ellis), the district is also home to a National Register listed property, the Oliver-Leming House (740 North Street, listed 9/12/1980).

The neighborhood as a whole retains its integrity and successfully conveys the look and feel of an early- to mid-twentieth century residential neighborhood.

2009 Historic Preservation Survey

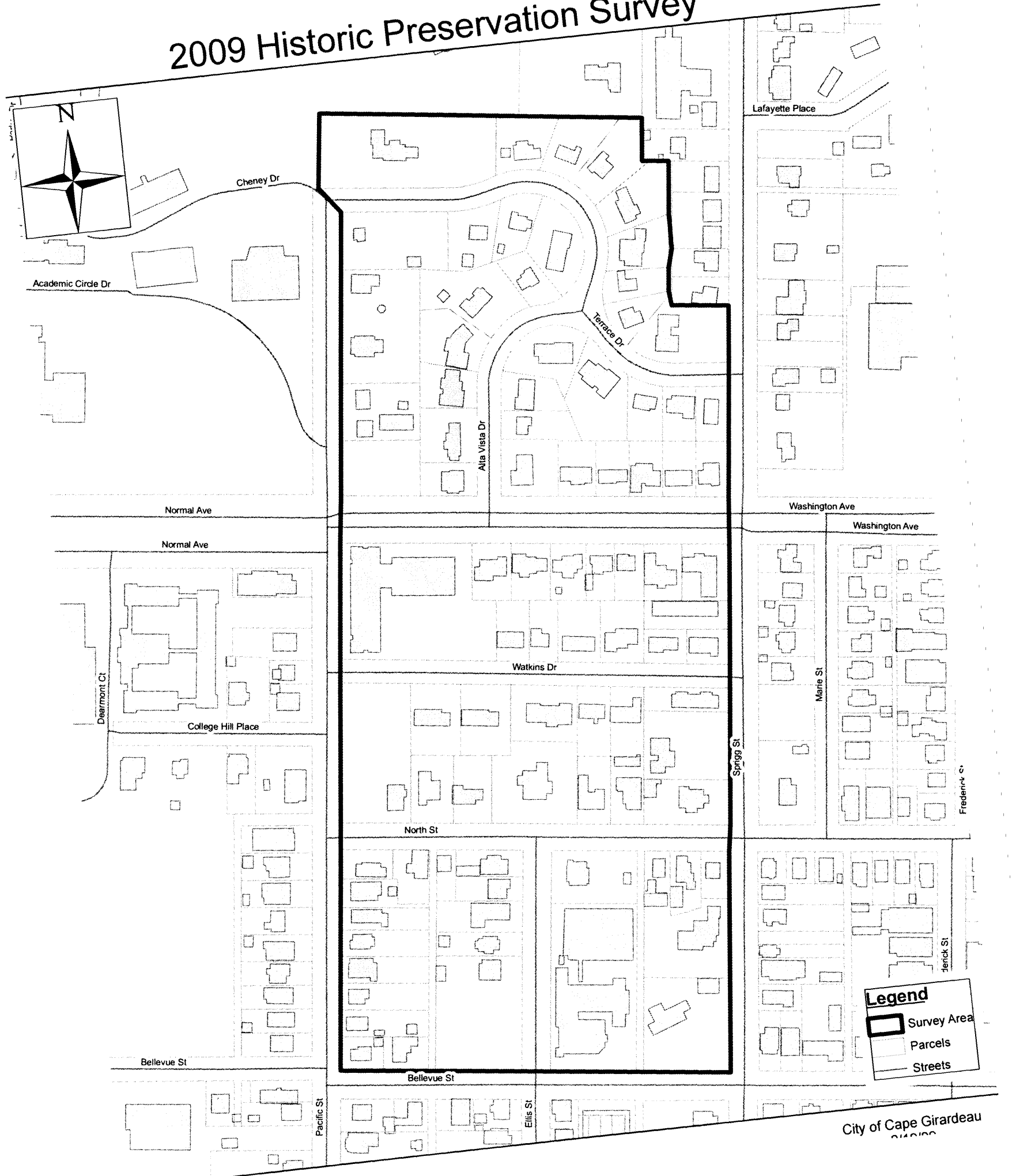
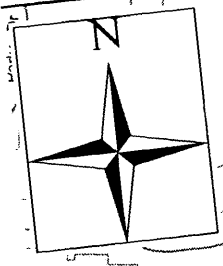

Legend

- Survey Area
- Parcels
- Streets

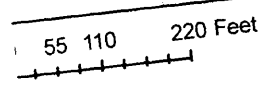

City of Cape Girardeau
2010

Methodology

At the request of the Cape Girardeau Historic Preservation Commission, in the Spring of 2009, students in HP 588: Legal and Economic Principles of Historic Preservation extended their Historic Resource Survey to include the neighborhood adjacent to Southeast Missouri State University and Capaha Park. The Commission asked the class to survey the area bounded by Terrace Drive on the north, Pacific Street on the West, Sprigg Street on the East, and Bellevue on the south. Archival research and reconnaissance survey was utilized to survey, photograph, and inventory the buildings in this entire area. Due to the limited time available, only a reconnaissance level survey could be conducted by this class, which will assist the city in future Preservation Planning.

Students worked in teams of three each, with each team assigned ten to twenty buildings. Flyers were posted to inform business as well as homeowners of the survey. The students documented their assigned buildings which, included taking photographs, researching the history of the building with the use of property tax records, and filling out State of Missouri Historic Resource Survey forms based on observations of the building from the street.

This information was compiled, photocopied, and bound. One copy was presented to the Historic Preservation Commission of Cape Girardeau, one copy deposited in the Regional Archives of Southeast Missouri State University, and one copy retained by the Historic Preservation Program, Department of History, Southeast Missouri State University. Upon completion of the survey of the entire district, the original forms and photographs will be forwarded to the State Office of Historic Preservation, Department of Natural Resources in Jefferson City, MO.

Acknowledgments

We would like to thank the following for their invaluable help and assistance, without which this survey could not have been completed:

- ◇ Cape Girardeau County employees for their help with the Property Tax Records of the many buildings included in this survey.
- ◇ District property owners for their cooperation and assistance.
- ◇ The staff of University Printing and Duplicating for their help duplicating and binding the final report.
- ◇ Employees of Cape Girardeau City Hall, especially Sarah Wallace and Richard Reinhardt, for providing assistance and maps of the survey area.
- ◇ Cape Girardeau Historic Preservation Commission for providing assistance and support for continuing survey work in Cape Girardeau.