

NATIONAL REGISTER OF HISTORIC PLACES
INVENTORY - NOMINATION FORM

SITE FILE COPY

(Type all entries complete applicable sections)

STATE:	Missouri
COUNTY:	St. Louis
FOR NPS USE ONLY	
ENTRY DATE	

1. NAME

COMMON:	Myers, John B., House
AND/OR HISTORIC:	

2. LOCATION

STREET AND NUMBER:			
180 Dunn Road			
CITY OR TOWN:		CONGRESSIONAL DISTRICT:	
Florissant		#9 - Hon. William L. Hungate	
STATE	CODE	COUNTY:	CODE
Missouri	63031	St. Louis	189

3. CLASSIFICATION

CATEGORY (Check One)	OWNERSHIP	STATUS	ACCESSIBLE TO THE PUBLIC
<input type="checkbox"/> District <input checked="" type="checkbox"/> Building <input type="checkbox"/> Site <input type="checkbox"/> Structure <input type="checkbox"/> Object	<input type="checkbox"/> Public <input checked="" type="checkbox"/> Private <input type="checkbox"/> Both	Public Acquisition: <input type="checkbox"/> In Process <input type="checkbox"/> Being Considered	<input type="checkbox"/> Occupied <input checked="" type="checkbox"/> Unoccupied <input checked="" type="checkbox"/> Preservation work in progress
PRESENT USE (Check One or More as Appropriate)			
<input type="checkbox"/> Agricultural <input type="checkbox"/> Commercial <input type="checkbox"/> Educational <input type="checkbox"/> Entertainment	<input type="checkbox"/> Government <input type="checkbox"/> Industrial <input type="checkbox"/> Military <input type="checkbox"/> Museum	<input type="checkbox"/> Park <input type="checkbox"/> Private Residence <input type="checkbox"/> Religious <input type="checkbox"/> Scientific	<input type="checkbox"/> Transportation <input checked="" type="checkbox"/> Other (Specify) <u>unoccupied</u> <input type="checkbox"/> Comments

4. OWNER OF PROPERTY

OWNER'S NAME:	Historic Florissant Inc.		
STREET AND NUMBER:	603 Rue St. Denis		
CITY OR TOWN:	STATE:	CODE	
Florissant	Missouri	63031	29

5. LOCATION OF LEGAL DESCRIPTION

COURTHOUSE, REGISTRY OF DEEDS, ETC.:			
Office of the Recorder of Deeds, St. Louis County Courthouse			
STREET AND NUMBER:			
7900 Forsyth Boulevard			
CITY OR TOWN:	STATE	CODE	
Clayton	Missouri	63105	29

6. REPRESENTATION IN EXISTING SURVEYS

TITLE OF SURVEY:			
1. Historic American Buildings Survey			
DATE OF SURVEY:	<input checked="" type="checkbox"/> Federal	<input type="checkbox"/> State	<input type="checkbox"/> County
1967			<input type="checkbox"/> Local
DEPOSITORY FOR SURVEY RECORDS:			
Library of Congress			
STREET AND NUMBER:			
CITY OR TOWN:	STATE:	CODE	
Washington, D.C.	n.a.	08	

SEE INSTRUCTIONS

STATE: Missouri
COUNTY: St. Louis
ENTRY NUMBER:
DATE:
FOR NPS USE ONLY

7. DESCRIPTION

CONDITION	(Check One)					
	<input type="checkbox"/> Excellent	<input checked="" type="checkbox"/> Good	<input type="checkbox"/> Fair	<input type="checkbox"/> Deteriorated	<input type="checkbox"/> Ruins	<input type="checkbox"/> Unexposed
	(Check One)			(Check One)		
	<input checked="" type="checkbox"/> Altered	<input type="checkbox"/> Unaltered	<input type="checkbox"/> Moved	<input checked="" type="checkbox"/> Original Site		

DESCRIBE THE PRESENT AND ORIGINAL (if known) PHYSICAL APPEARANCE

The John B. Myers House, 180 Dunn Road, Florissant, Missouri, is a two-story, five-bay, 12-room, Classic Revival-style residence. L-shaped in plan, the house has a two-story rear (north) wing attached to the north wall of the main (south) portion. A portico dominates the main (south) facade. A one-story bay is attached to the west facade of the south portion.

EXTERIOR

Over-all dimensions

The house measures roughly 55' 3" by 39' 9". The main (south) portion is approximately 39' 9" by 31' 3"; the rear (north) wing measures 16' 3" by 24'.

Construction materials and colors

Basic construction materials are stone and brick: rough-cut, random-laid stone blocks for the foundations and bricks painted white and laid in common bond for the walls. The portico; window shutters, frames, and mullions; doors and doorway frames; and cornices are of wood painted white. The wood brackets and cast-iron rosette medallions of the cornice are painted dark green. Smooth-cut stone blocks form the window lintels and sills. Asphalt shingles cover the roofs. Wood shingles sheathe the wood-frame west bay and rear (east) entrance.

Openings

Windows. Rectangular-shaped, two-over-two light, double-hung sash windows occur on the first and second stories. Each is trimmed by a lintel and slipsill. Those on the east facade are blind and shuttered. Each side of the three-sided west bay has a rectangular, twelve-over-twelve light sash window. Basement windows are filled by rectangular-shaped, two-light sash and trimmed by a lintel.

Doorways. Main, rear, and basement entrances are on the south, east, and north facades respectively.

The main entrance, located in the center bay of the south facade, is filled by a double-leaf, wood and glass (three lights over a single panel) door topped by a one-light, rectangular transom. An Egyptian Revival-style surround trims the doorway.

Chimneys

Four chimneys service the Myers House. They are positioned flush with the wall surface at each end of the east and west facades of the south portion. All are of brick and have a single stack.

Porches

A two-story, three-bay, pedimented portico is centered across the south facade of the main portion. Paired square columns with molded capitals and

SEE INSTRUCTIONS

8. SIGNIFICANCE

PERIOD (Check One or More as Appropriate)

- Pre-Columbian | 16th Century | 18th Century | 20th Century
 15th Century | 17th Century | 19th Century

SPECIFIC DATE(S) (If Applicable and Known) 1867-70

AREAS OF SIGNIFICANCE (Check One or More as Appropriate)

- | | | | |
|--|---|--|---|
| <input type="checkbox"/> Aboriginal | <input type="checkbox"/> Education | <input type="checkbox"/> Political | <input type="checkbox"/> Urban Planning |
| <input type="checkbox"/> Prehistoric | <input type="checkbox"/> Engineering | <input type="checkbox"/> Religion/Philosophy | <input checked="" type="checkbox"/> Other (Specify) |
| <input type="checkbox"/> Historic | <input type="checkbox"/> Industry | <input type="checkbox"/> Science | <u>prominent original</u> |
| <input type="checkbox"/> Agriculture | <input type="checkbox"/> Invention | <input type="checkbox"/> Sculpture | <u>owners/builders</u> |
| <input checked="" type="checkbox"/> Architecture | <input type="checkbox"/> Landscape Architecture | <input type="checkbox"/> Social/Humanitarian | _____ |
| <input type="checkbox"/> Art | <input type="checkbox"/> Literature | <input type="checkbox"/> Theater | _____ |
| <input type="checkbox"/> Commerce | <input type="checkbox"/> Military | <input type="checkbox"/> Transportation | _____ |
| <input type="checkbox"/> Communications | <input type="checkbox"/> Music | | _____ |
| <input type="checkbox"/> Conservation | | | _____ |

STATEMENT OF SIGNIFICANCE

The John B. Myers House, 180 Dunn Road, Florissant, Missouri, demonstrates the remarkable persistence of the Classical Revival style of architecture into the Victorian era.¹ Noteworthy for its elaborate detailing (ornate, two-story portico and extensive interior wall treatments), the house has survived in a relatively unaltered condition.

Previous owners

The most noted previous owners were the original owners/builders John B. and Adelaide Motten Myers.

In 1867 Myers purchased fifty acres of land less than a mile south of the old French town of St. Ferdinand (now Florissant). He had come to Missouri from Pottstown, Pennsylvania, and according to probate records had substantial land holdings in Calhoun County, Illinois. Myers was married to Adelaide Motten, a native of Alsace-Lorraine. They had three children: John, Jr.; Salena; and Zelda (born 16 days after her father's death in 1869).²

At John B. Myers' death, only the foundations and framework for the upper stories of the house were finished; Mrs. Myers is credited with completing the construction following her husband's plans.³

The survey of Missouri's historic sites is based on the selection of sites as they relate to theme studies in Missouri history as outlined in the "Missouri State Historic Preservation Plan." The John B. Myers House is, therefore, being nominated to the National Register of Historic Places as an example of the "Architecture" theme.

FOOTNOTES

1. Historic American Buildings Survey: John B. Myers House, MO-1183, Summer, 1967, Sheet 1.
2. Probate Court of St. Louis, Missouri, Probate File #8755; and Historic American Buildings Survey: John B. Myers House, MO-1183, Summer, 1967, Sheet 1.

SEE INSTRUCTIONS

9. MAJOR BIBLIOGRAPHICAL REFERENCES

1. Davison, Mrs. Rosemary. Personal telephone conversation. October 30, 1974.
2. _____. Personal telephone conversation. November 1, 1974.
3. Historic American Buildings Survey: John B. Myers House, MO-1183, Summer, 1967, Sheets 1-10.

10. GEOGRAPHICAL DATA

LATITUDE AND LONGITUDE COORDINATES DEFINING A RECTANGLE LOCATING THE PROPERTY			LATITUDE AND LONGITUDE COORDINATES DEFINING THE CENTER POINT OF A PROPERTY OF LESS THAN TEN ACRES									
CORNER	LATITUDE		LONGITUDE		OR	LATITUDE		LONGITUDE				
	Degrees	Minutes	Seconds	Degrees		Minutes	Seconds	Degrees	Minutes	Seconds		
NW	°	'	"	°	'	"	38°	46'	35"	90°	20'	14"
NE	°	'	"	°	'	"						
SE	°	'	"	°	'	"						
SW	°	'	"	°	'	"						

APPROXIMATE ACREAGE OF NOMINATED PROPERTY: approximately one (1) acre

LIST ALL STATES AND COUNTIES FOR PROPERTIES OVERLAPPING STATE OR COUNTY BOUNDARIES

STATE:	CODE	COUNTY	CODE
STATE:	CODE	COUNTY:	CODE
STATE:	CODE	COUNTY:	CODE
STATE:	CODE	COUNTY:	CODE

11. FORM PREPARED BY

NAME AND TITLE: 1. Nancy B. Breme, Research Associate

ORGANIZATION: Department of Natural Resources, State Historical Survey and Planning Office DATE: November 1, 1974

STREET AND NUMBER: P.O. Box 176

CITY OR TOWN: Jefferson City STATE: Missouri 65101 CODE: 29

12. STATE LIAISON OFFICER CERTIFICATION

NATIONAL REGISTER VERIFICATION

As the designated State Liaison Officer for the National Historic Preservation Act of 1966 (Public Law 89-665), I hereby nominate this property for inclusion in the National Register and certify that it has been evaluated according to the criteria and procedures set forth by the National Park Service. The recommended level of significance of this nomination is:

National State Local

Name _____
James L. Wilson

Title Director, Department of Natural Resources, and State Historic Preservation Officer

Date _____

I hereby certify that this property is included in the National Register.

Director, Office of Archeology and Historic Preservation

Date _____

ATTEST:

Keeper of The National Register

Date _____

SEE INSTRUCTIONS

**NATIONAL REGISTER OF HISTORIC PLACES
INVENTORY - NOMINATION FORM**

(Continuation Sheet)

STATE Missouri	
COUNTY St. Louis	
FOR NPS USE ONLY	
ENTRY NUMBER	DATE

(Number all entries)

6. #1 MYERS, JOHN B., HOUSE
2. 100 Historic Buildings in St. Louis County
1970 (county)
Historic Buildings Commission
St. Louis Department of Parks and Recreation
Clayton, Missouri 63105 Code: 29
3. Florissant City Survey
1974 (local)
City Hall
955 Rue St. Francois
Florissant, Missouri 63031 Code: 29
4. Missouri State Historical Survey
1974 (state)
Department of Natural Resources
P.O. Box 176
Jefferson City, Missouri 65101 Code: 29

**NATIONAL REGISTER OF HISTORIC PLACES
INVENTORY - NOMINATION FORM**

(Continuation Sheet)

STATE Missouri	
COUNTY St. Louis	
FOR NPS USE ONLY	
ENTRY NUMBER	DATE

(Number all entries)

7. #1

MYERS, JOHN B., HOUSE

pedestals support the second-story floor and the pediment. Balustrades connect the column pedestals.

Roofs

A truncated hip roof is over the south portion of the house; gable roofs cover the portico and rear wing.

Decorative features

Decorative details include: 1) lintels and sills (previously described); 2) a portico (mentioned above); 3) a boxed cornice with brackets and freize decorated by medallions; and 4) the boxed cornice with brackets of the west bay.

INTERIOR

Basement

The full basement has three rooms: two under the south portion and one under the rear wing. The south rooms (each measuring approximately 28' 6" by 13' 6") are to either side of a central hall running in a north/south direction. The north room measures about 13' 3" x 22' 6". Ceiling heights are 8' 6" and 7' 6" in the south and north rooms respectively. All interior walls are of stone finished with plaster; floors are of concrete. The basement houses the furnace, provides storage space, and serves as a meeting place for fund raising activities ("cellar parties").

First floor

Six major rooms comprise the first floor: four in the south portion and two in the rear wing. The south rooms are arranged two to either side of a center hall running in a north/south direction. Each is approximately 14' 6" by 14' 6". North rooms include a kitchen and flower room. A bath opens off the north end of the center hall.

All rooms have painted plaster walls. Those on the east side of the south portion have "frescoes" on the ceilings, cornices, and doors. Most rooms have individual fireplaces with wood mantels and original equipment for Franklin-type stoves. Random-width flooring and Classic-style wood baseboards and window and doorway trim occur in all rooms. Doorways are filled by four-panel wood doors with two-light, rectangular transoms above.

Access to the second floor is by a straight-run stairway along the east wall of the center hall. The newel post and balusters are of walnut.

NATIONAL REGISTER OF HISTORIC PLACES
INVENTORY - NOMINATION FORM

(Continuation Sheet)

STATE Missouri	
COUNTY St. Louis	
FOR NPS USE ONLY	
ENTRY NUMBER	DATE

(Number all entries)

7. #2

MYERS, JOHN B., HOUSE

Second floor

The second floor room arrangement echoes that of the first floor; most rooms have the same dimensions. The interior finishing is also similar: painted plaster walls, fireplaces in each room (an exception is the northernmost north room), and Classic-style trim.

Attic

Access to the attic is by a straight-run stairway similar to the first to second floor stairs in design and location. The unfinished attic is over the main portion of the house.

ALTERATIONS

Alterations include:

1. addition of "frescoes" on the ceilings, cornices, and doors of various rooms throughout the house (1886)¹
2. removal of "frescoes" in many rooms
3. replacement of the original tin roof with asphalt shingles
4. removal of a fifth chimney from the north wing
5. bricking in of the northernmost rear wing second floor doorway
6. addition of the west bay
7. removal of widow's walk on truncated hip roof of the main (south) portion
8. removal of rear two-story gallery and addition of enclosed entrance and two baths.

Local researchers date most of these alterations as occurring after 1930.²

CONDITION

The Myers House is in good structural condition; repairs to the portico are nearing completion.

SITE

The house, which is atop a knoll overlooking I-270, faces south. Once part of a 50-acre farm,³ today approximately one acre remains with the house. Many trees surround the house obscuring it from Dunn Road travelers.

The property is surrounded by: a tavern/restaurant (originally an out-building of the house) on the north; Interstate I-270 on the south; acreage under commercial development on the west; and the Reubens and Coco restaurants on the east.

NATIONAL REGISTER OF HISTORIC PLACES
INVENTORY - NOMINATION FORM

(Continuation Sheet)

STATE	Missouri	
COUNTY	St. Louis	
FOR NPS USE ONLY		
ENTRY NUMBER		DATE

(Number all entries)

7. #3

MYERS, JOHN B., HOUSE

PRESENT STATUS

Prior to 1974, the Myers House was slated for demolition to allow for the construction of the Interbelt Highway 725 in St. Louis County. Following much opposition by proponents for the retention of the historic house, Missouri State Highway Department officials redesigned the roadway to avoid the house. This redesigning was dependent upon the securement of permanent guarantees that the house would be preserved in the future; such deed restrictions have been filed.

The current owners of the Myers House, Historic Florissant Inc., anticipate a full-scale restoration of the home; work has already begun under the supervision of a restoration contractor.⁴

FOOTNOTES

1. Historic American Buildings Survey: John B. Myers House, MO-1183, Summer, 1967, Sheet 1.
2. Statement by Mrs. Rosemary Davison, personal telephone conversation, November 1, 1974. (Mrs. Davison is the City Clerk for Florissant, Missouri, and the coordinator of the Florissant City Survey, a sub-survey of the State Historical Survey and Planning Office.)
3. Historic American Buildings Survey: John B. Myers House, MO-1183, Summer, 1967, Sheet 1.
4. St. Louis [Missouri] Post-Dispatch, August 19, 1974, p. 1B; and statement by Mrs. Rosemary Davison, personal telephone conversation, October 30, 1974.

**NATIONAL REGISTER OF HISTORIC PLACES
INVENTORY - NOMINATION FORM**

(Continuation Sheet)

STATE	
Missouri	
COUNTY	
St. Louis	
FOR NPS USE ONLY	
ENTRY NUMBER	DATE

(Number all entries)

8. #1

MYERS, JOHN B., HOUSE

3. Statement by Mrs. Rosemary Davison, personal telephone conversation,
November 1, 1974.

SITE FILE COPY
NATIONAL HISTORIC PLACES
INVENTORY NOMINATION FORM

(Continuation Sheet)

STATE Missouri	
COUNTY St. Louis	
FOR NPS USE ONLY	
ENTRY NUMBER	DATE

(Number all entries)

8. #2

MYERS, JOHN B., HOUSE

"The John B. Myers House built in the late 1860's is one of the few remaining examples of Palladian [Classic Revival] residential types from the Victorian period. The elegant two-story portico with its coupled columns, bracketed details under a classical pediment, is unique in the Midwest. The house plan is also a classic example of its type with large high-ceiling rooms and attached kitchen wing. The full basement with rugged stone walls, brick arches under partition walls, the mantelpieces, frescoes and other details show that this house was no ordinary farmhouse. The site itself, atop a high knoll, provides a favored view to the south and sets this house apart from any other in the county."⁴

Two residences similar to the Myers House were built during the 1860's in the St. Louis area: the Dr. J.R. Hereford House, Ferguson,⁵ (current condition not verified) and the James Clemens, Jr. House, 1849 Cass Avenue, St. Louis.⁶ The Clemens House (1863) is the most elaborate of the three, its simple Classic design ornamented with Renaissance Revival details (quoins, bracketed sills, complete entablatures over windows and doorways). Cast-iron double porch columns support the two-story portico. The facial features of Mrs. Clemens, who died before the house was built, appear in cast iron above each window and in plaster and marble inside. The Hereford House (1869), on the contrary, is almost a carbon copy of the Myers House -- wood frame construction having been substituted for brick. The high degree of similarity between the two houses, even in the detailing, suggests that the same architect/builder may have been employed by Myers and Hereford. It should also be noted that Dr. Hereford had lived in Florissant prior to moving to Ferguson⁷ and, therefore, may have been familiar with the Myers House, having its design copied for his own home.

FOOTNOTES

4. Buford L. Pickens, personal correspondence with David Baum, February 8, 1974. (Mr. Pickens is an architectural historian and a member of the St. Louis County Historic Buildings Commission; Mr. Baum is the current president of the Florissant Landmarks Commission.)
5. William L. Thomas, History of St. Louis County, Missouri, Vol. I (St. Louis-Chicago-Philadelphia: The S.J. Clarke Publishing Co., 1911), p. 294.
6. George McCue, The Building Art in St. Louis: Two Centuries (St. Louis: American Institute of Architects, St. Louis Chapter, 1967), p. 85.
7. Thomas, p. 294.

**NATIONAL REGISTER OF HISTORIC PLACES
INVENTORY - NOMINATION FORM**

(Continuation Sheet)

STATE	
Missouri	
COUNTY	
St. Louis	
FOR NPS USE ONLY	
ENTRY NUMBER	DATE

(Number all entries)

9. #1 MYERS, JOHN B., HOUSE

3. Kramer, Gerhardt. A Tour of North St. Louis County, October 29, 1967,
ed. Mrs. Jean S. Goodson. St. Louis: Landmarks Association of St. Louis,
Missouri, 1967, p. 6.

4. Pitzman, Julius. Pitzman's New Atlas of the City and County of St. Louis,
Missouri. Philadelphia: A.B. Holcombe & Co., 1878, p. 67.

5. Probate Court of St. Louis, Missouri. Probate File #8755.

UNITED STATES DEPARTMENT OF THE INTERIOR
NATIONAL PARK SERVICE
SITE FILE COPY
NATIONAL REGISTER OF HISTORIC PLACES
INVENTORY - NOMINATION FORM

STATE	
Missouri	
COUNTY	
St. Louis	
FOR NPS USE ONLY	
ENTRY NUMBER	DATE

(Continuation Sheet)

(Number all entries)

9. #2 MYERS, JOHN B., HOUSE

6. McCue, George. The Building Art in St. Louis: Two Centuries.
St. Louis: American Institute of Architects, St. Louis Chapter, 1967.

7. Pickens, Buford L. Personal correspondence with David Baum. February 8,
1974.

8. St. Louis [Missouri] Globe-Democrat, January 16, 1974, pp. 1N-2N.

9. Thomas, William L. History of St. Louis County, Missouri. Vol. I.
St. Louis-Chicago-Philadelphia: The S.J. Clarke Publishing Co., 1911.

**NATIONAL REGISTER OF HISTORIC PLACES
INVENTORY - NOMINATION FORM**

(Continuation Sheet)

STATE	
Missouri	
COUNTY	
St. Louis	
FOR NPS USE ONLY	
ENTRY NUMBER	DATE

(Number all entries)

11. #1

MYERS, JOHN B., HOUSE

2. Sheila Andrew, Secretary
Florissant City Survey (sub-survey of the State
Historical Survey and Planning Office)
955 Rue St. Francois
Florissant, Missouri 63031

Code: 29

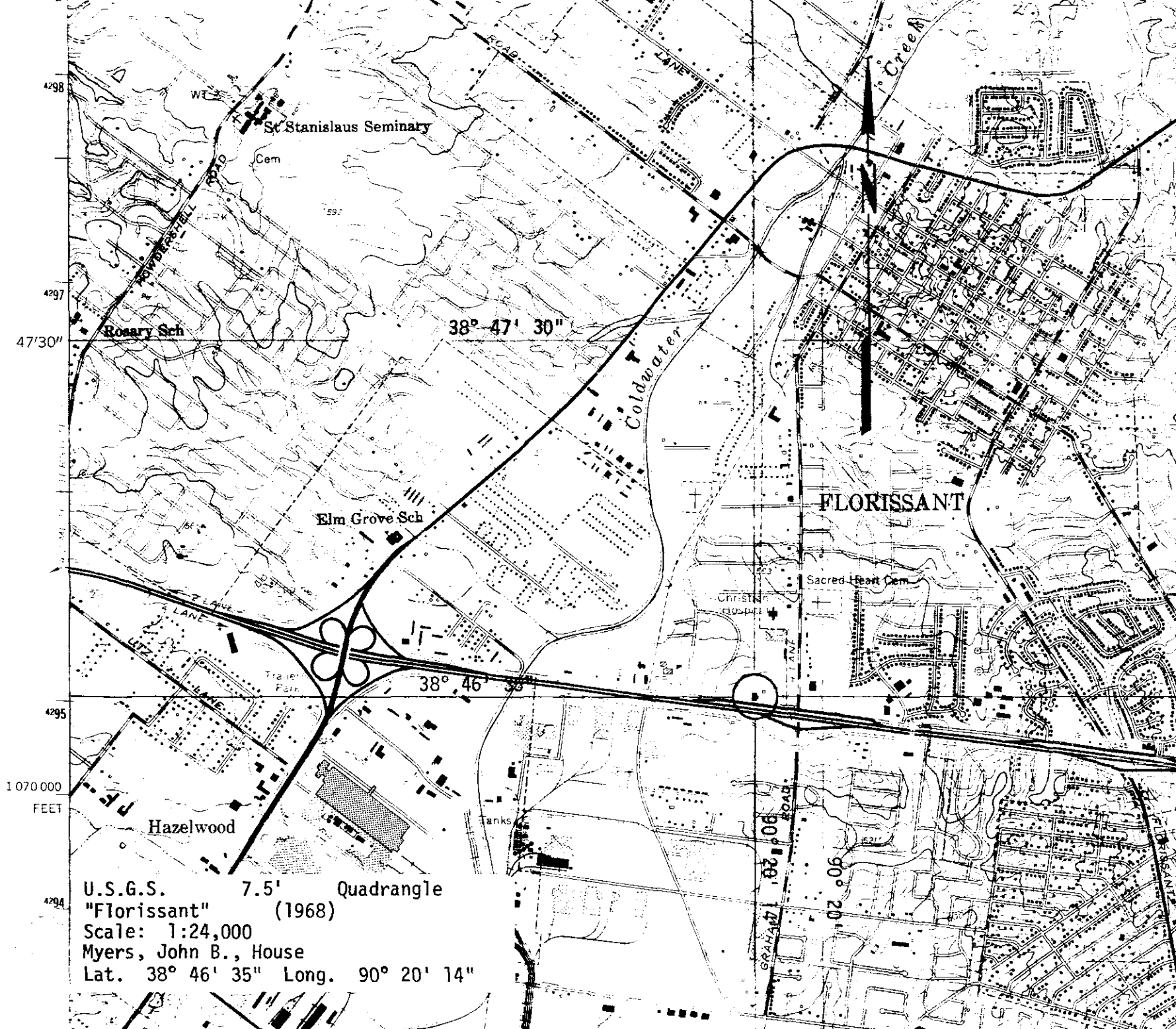

4298
4297
47'30"
4295
1 070 000
FEET
4294

St Stanislaus Seminary

Rosary Sch

38° 47' 30"

Elm Grove Sch

FLORISSANT

Sacred Heart Cem

Hazelwood

U.S.G.S. 7.5' Quadrangle
"Florissant" (1968)
Scale: 1:24,000
Myers, John B., House
Lat. 38° 46' 35" Long. 90° 20' 14"

Photo Log:

Name of Property: **Myers, John B., House**

City or Vicinity: **Florissant**

County: **St. Louis County** State: **MO**

Photographer: **Nancy B. Breme**

Date

Photographed: **Nov. 1974**

Description of Photograph(s) and number, include description of view indicating direction of camera:

1 of 7. SE corner; view facing NW with the primary (S) façade on the left and the E façade on the right. All E façade windows are blind.

2 of 7. SW corner; view looking NE with the primary (S) façade on the right and the W façade to the left.

3 of 7. View looking SW with the main (S) portion on the left and the rear (N) wing on the right. Non-original baths and enclosed rear entrance span the E façade on the rear wing.

4 of 7. W façade; view facing NE. S façade portico is to the extreme right.

5 of 7. Interior view showing the NW corner of the SW room of the main (S) portion. Restoration of the room is nearing completion.

6 of 7. Interior view showing the SE corner of the NE room of the main (S) portion. Remnants of the ceiling and wall "frescoes" completed in 1886 remain; ceiling medallion of plaster typical of those found in other first floor rooms. Restoration plans call for the retention of these details.

7 of 7. Main (S) entrance; view looking N. An Egyptian Revival style surround frames the doorway. The double leaf, glass and wood door is topped by a two light transom.













