

# The Morgan Oak-Highway 74 Survey Part II

## Frederick Street to Pacific Street

Cape Girardeau, Missouri

Conducted by  
Students of the Historic Preservation Program  
Southeast Missouri State University

Spring, 2005

Kelly Almond  
Lauren Buchtman  
William Gatlin  
Adam Kerr

Garret Kremer-Wright  
Robyn Mainor  
Laura Stubblefield  
Elizabeth Vandeven

Survey Coordinator: William Gatlin

Assistant Survey Coordinators: Allison Marshaus, Adrianna  
Salazar, Sarah Zaragosa, Christine Williams,

HP 588: Legal and Economic Principles of Historic Preservation  
Dr. Steven J. Hoffman

# **Morgan Oak – Highway 74 Survey**

## **Part II**

### **Frederick Street to Pacific Street**

Students in the Legal and Economic Principles of Historic Preservation class (HP 588), under the guidance of Dr. Steven Hoffman, conducted an architectural survey of homes in the Morgan Oak – Highway 74 Historic District in Cape Girardeau, Missouri.. The main purpose of this survey was to construct an inventory of the residential buildings in the neighborhood for the Historic Preservation Commission of Cape Girardeau.

The area surveyed in Part II extends from Frederick Street on the east, Pacific Street on the west, Morgan Oak Street on the north and Highway 74 on the south, and completes the survey of the Morgan Oak – Highway 74 Historic District.

The Morgan Oak – Highway 74 historic district is representative of the kinds of neighborhoods built in Cape Girardeau during the late nineteenth and early twentieth centuries. This neighborhood contains many fine examples of dwellings built by Cape's lower and middle classes during this period, including houses in the Queen Anne, Craftsman Bungalow, American Four Square, and vernacular house styles. The area as a whole has retained its integrity despite a number of houses with significant alteration and the intrusion of several noncontributing properties.

## **Methodology**

At the request of the Cape Girardeau Historic Preservation Commission, in the Spring of 2004, students in HP 588: Legal and Economic Principles of Historic Preservation extended their Historic Resource Survey to include the historic neighborhoods south of Morgan Oak. The Commission asked the class to survey the area bounded by Pacific Street on the West, Fountain Street on the East, extending from Highway 74 on the South to Morgan Oak on the North. Archival research and reconnaissance survey indicate this entire area as having strong potential as a historic district. Due to the limited time available, only a portion of the district can be surveyed in any given semester.

Students worked in teams of two each, with each team assigned ten to twenty buildings. Each team distributed flyers to homeowners in the neighborhood to inform them of the survey. The students documented their assigned buildings, including taking photographs, researching the history of the building with the use of property tax records and filling out State of Missouri Historic Resource Survey forms based on observations of the building from the street.

This information was compiled, photocopied, and bound. One copy was presented to the Historic Preservation Commission of Cape Girardeau, one copy deposited in the Regional Archives of Southeast Missouri State University, and one copy retained by the Historic Preservation Program, Department of History, Southeast Missouri State University. Upon completion of the survey of the entire district, the

original forms and photographs will be forwarded to the State Office of Historic Preservation, Department of Natural Resources in Jefferson City, MO.

20

FREDETRICK

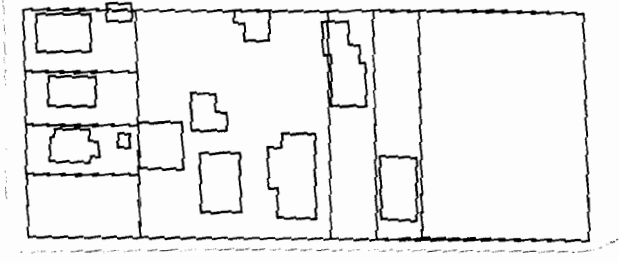

SPRIGG

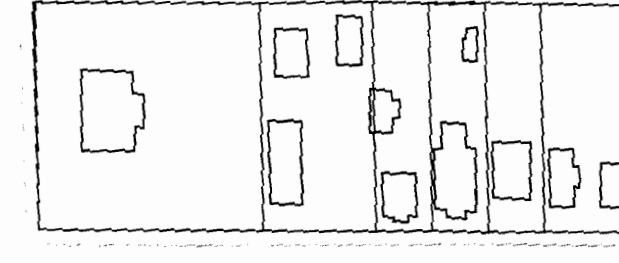

ELLIS

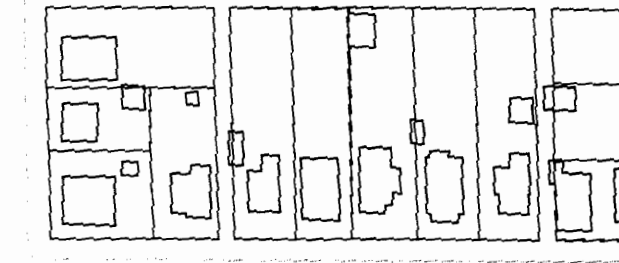

PACIFIC



3

AVE.

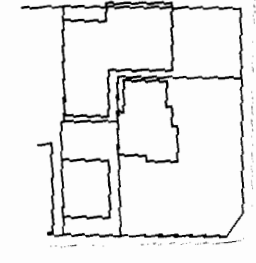
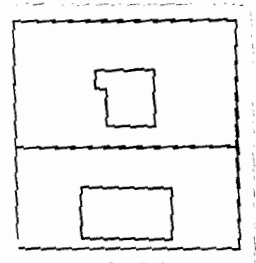
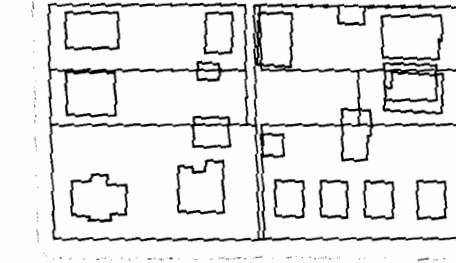
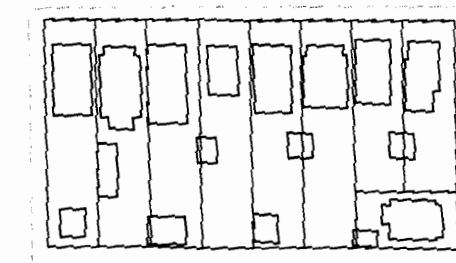

OAK



MORGAN

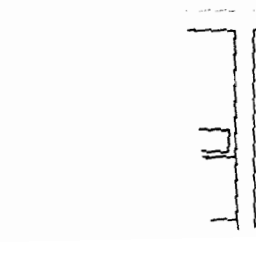

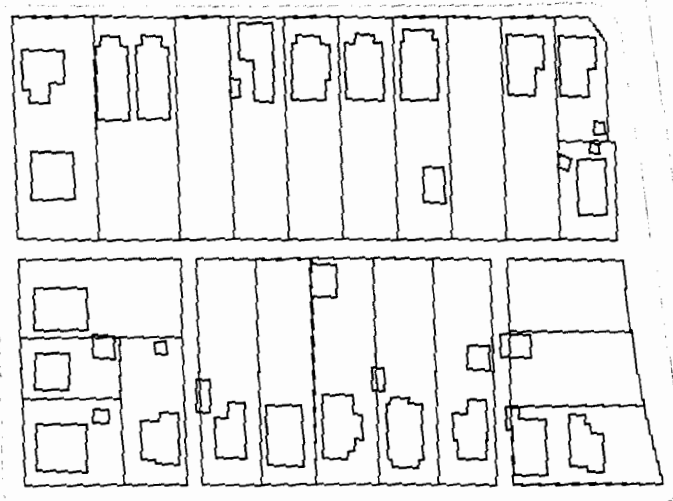
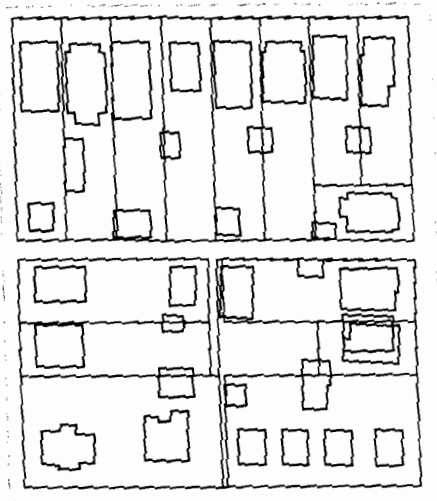
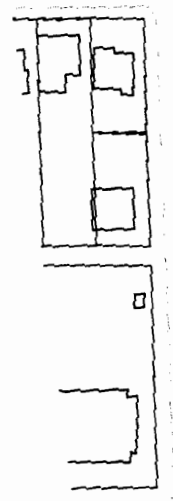
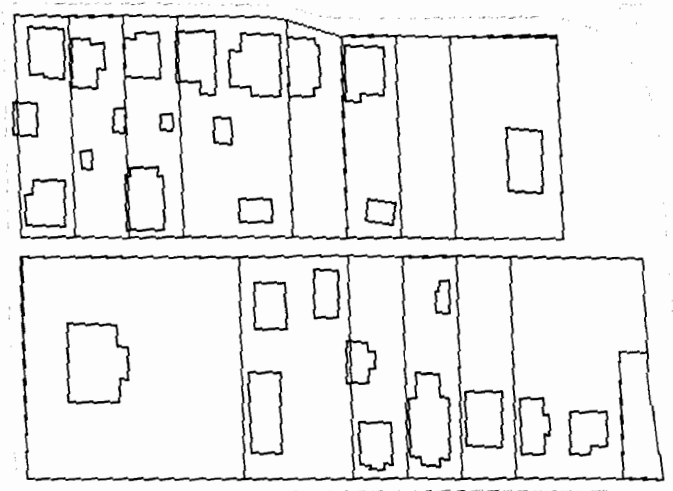
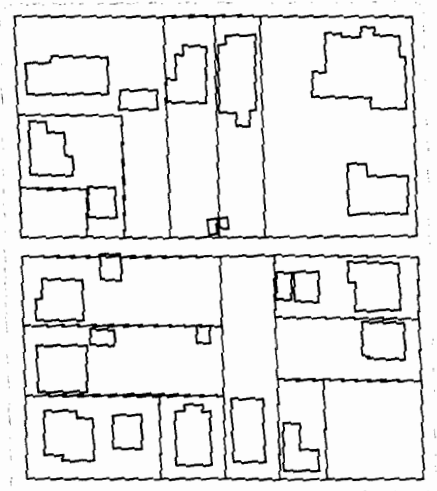
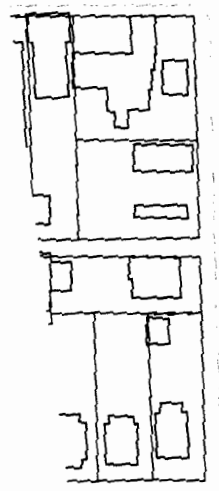
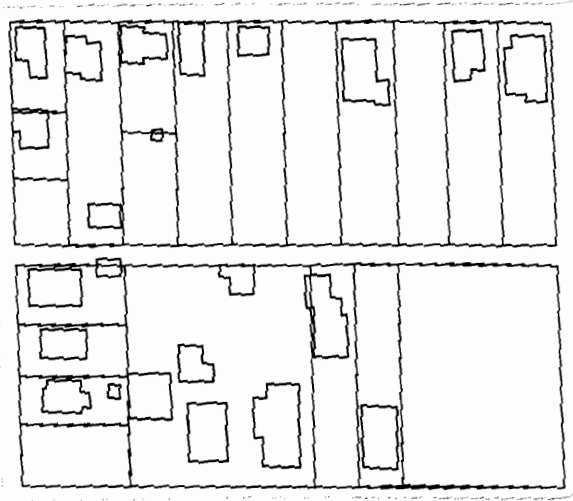
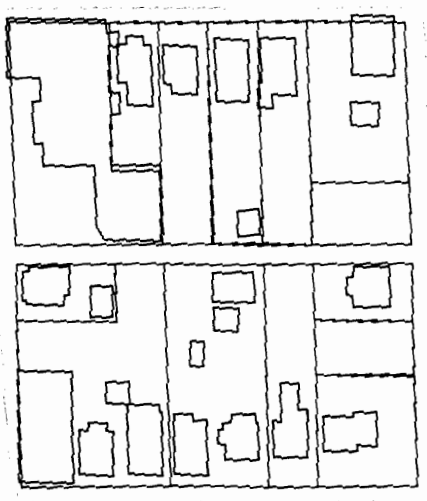
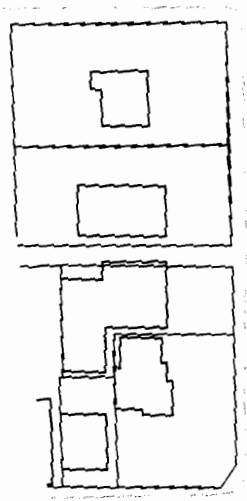

## **Acknowledgments**

The staff of University Printing and Duplicating for all their help in developing all the photographs included in this survey, and well as duplicating and binding the final report.

Cape Girardeau County Employees: For helping with the Property Tax Records of the many buildings included in this survey.

District Homeowners: For their cooperation and assistance.

Employees of Cape Girardeau City Hall, especially Ms. Brenda Schloss, for providing assistance and maps of the survey area.

Cape Girardeau Historic Preservation Commission: For providing assistance and support for continuing survey work in Cape Girardeau.