

The Morgan Oak-Highway 74 Survey Part I

Fountain Street to Sprigg Street

Cape Girardeau, Missouri

Conducted by
Students of the Historic Preservation Program
Southeast Missouri State University

Spring, 2004

Michael Culler
Julie Elgin
Margaret Harmon
Lacey Illers

Kim Leazenby
Eric McNeal
Pam Watson

Survey Coordinator: Doug Gasek

Assistant Survey Coordinators: Lisa Graham, Sarah
Kliethermes, and Sarah Kate Parker

HP 588: Legal and Economic Principles of Historic Preservation
Dr. Steven J. Hoffman

Morgan Oak – Highway 74 Survey

Part 1

Fountain Street to Sprigg Street

Students in the Legal and Economic Principles of Historic Preservation class (HP 588), under the guidance of Dr. Steven Hoffman, conducted an architectural survey of homes in the Morgan Oak – Highway 74 Historic District in Cape Girardeau, Missouri.. The main purpose of this survey was to construct an inventory of the residential buildings in the neighborhood for the Historic Preservation Commission of Cape Girardeau.

The area surveyed in Part I extends from Fountain Street on the east, Sprigg Street on the west, Morgan Oak Street on the north and Highway 74 on the south.

The Morgan Oak – Highway 74 historic district is representative of the kinds of neighborhoods built in Cape Girardeau during the late nineteenth and early twentieth centuries. This neighborhood contains many fine examples of dwellings built by Cape's lower and middle classes during this period, including houses in the Queen Anne, Craftsman Bungalow, American Four Square, and vernacular house styles. The area as a whole has retained its integrity despite a number of houses with significant alteration and the intrusion of several noncontributing properties.

Methodology

At the request of the Cape Girardeau Historic Preservation Commission, in the Spring of 2004, students in HP 588: Legal and Economic Principles of Historic Preservation extended their Historic Resource Survey to include the historic neighborhoods south of Morgan Oak. The Commission asked the class to survey the area bounded by Pacific Street on the West, Fountain Street on the East, extending from Highway 74 on the South to Morgan Oak on the North. Archival research and reconnaissance survey indicate this entire area as having strong potential as a historic district. Due to the limited time available, only a portion of the district can be surveyed in any given semester.

Students worked in teams of two each, with each team assigned ten to twenty buildings. Each team distributed flyers to homeowners in the neighborhood to inform them of the survey. The students documented their assigned buildings, including taking photographs, researching the history of the building with the use of property tax records and filling out State of Missouri Historic Resource Survey forms based on observations of the building from the street.

This information was compiled, photocopied, and bound. One copy was presented to the Historic Preservation Commission of Cape Girardeau, one copy deposited in the Regional Archives of Southeast Missouri State University, and one copy retained by the Historic Preservation Program, Department of History, Southeast Missouri State University. Upon completion of the survey of the entire district, the

original forms and photographs will be forwarded to the State Office of Historic Preservation, Department of Natural Resources in Jefferson City, MO.

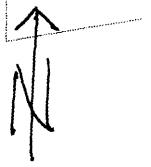
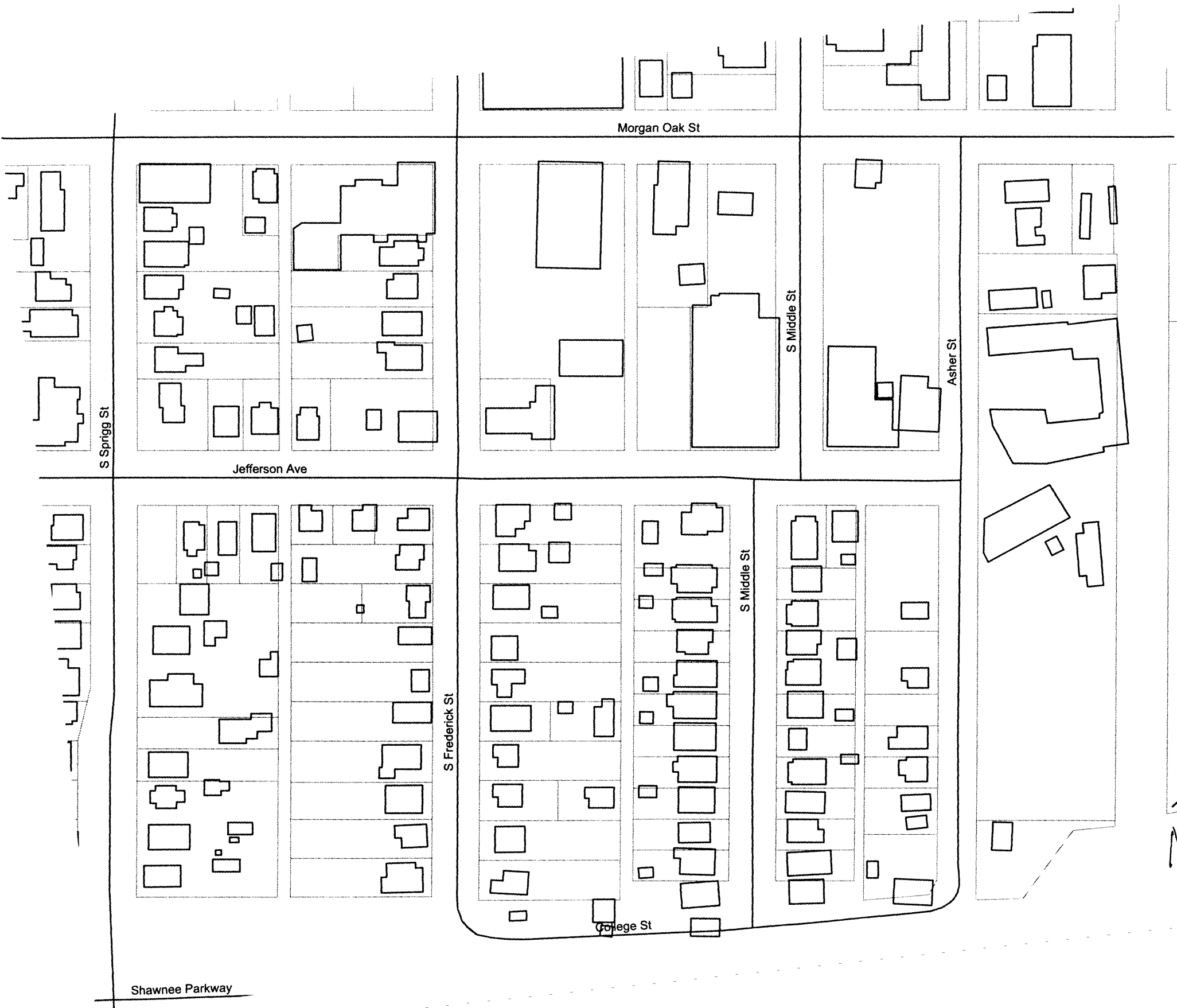

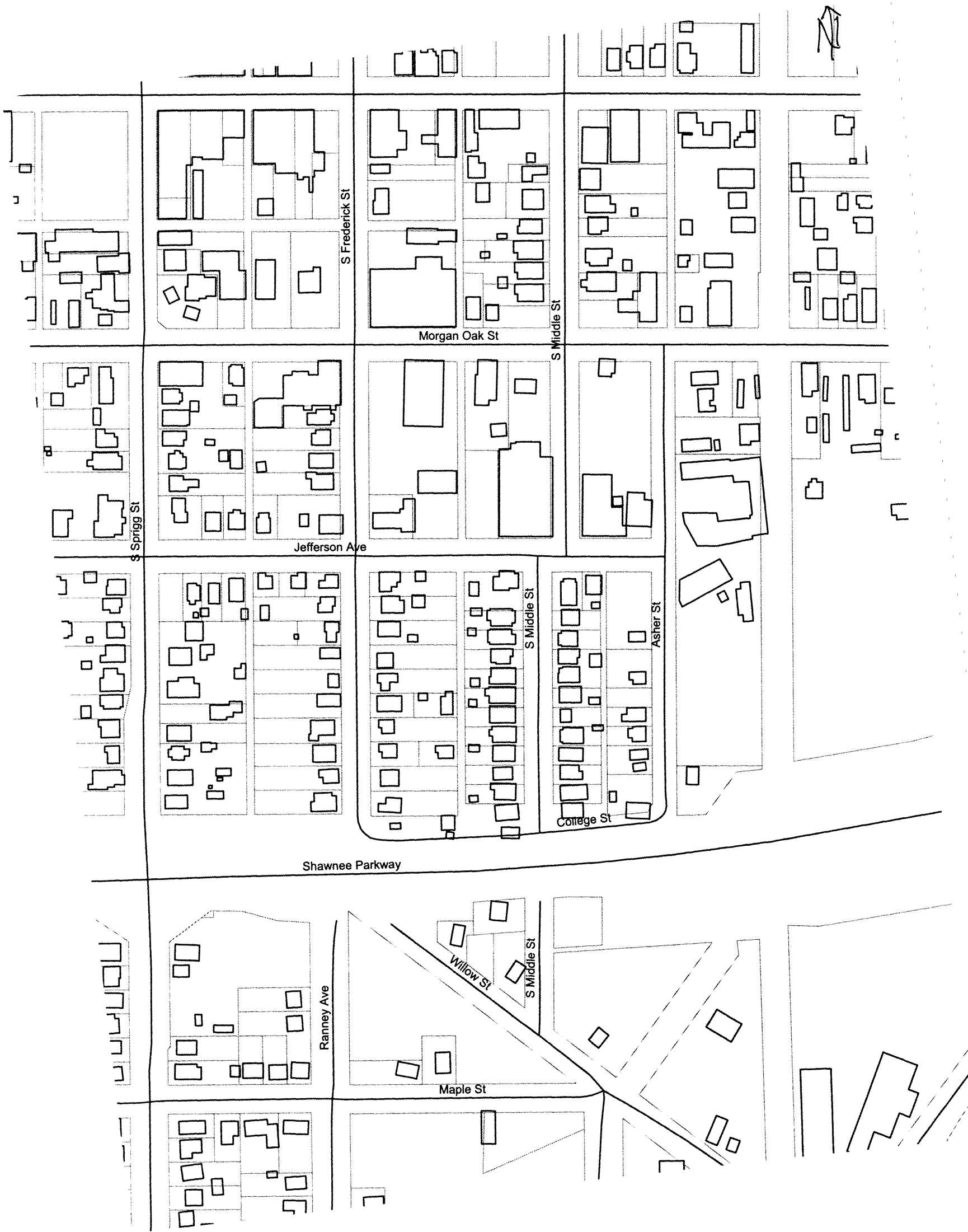

S Frederick St

Morgan Oak St

S Middle St

S Sprigg St

Jefferson Ave

S Middle St

Asher St

College St

Shawnee Parkway

Ranney Ave

Maple St

Willow St

S Middle St



Acknowledgments

The staff of University Printing and Duplicating for all their help in developing all the photographs included in this survey, and well as duplicating and binding the final report.

Cape Girardeau County Employees: For helping with the Property Tax Records of the many buildings included in this survey.

District Homeowners: For their cooperation and assistance.

Employees of Cape Girardeau City Hall, especially Ms. Brenda Schloss, for providing assistance and maps of the survey area.

Cape Girardeau Historic Preservation Commission: For providing assistance and support for continuing survey work in Cape Girardeau.