

Form 10-300  
(Dec. 1968)

UNITED STATES DEPARTMENT OF THE INTERIOR  
NATIONAL PARK SERVICE

## NATIONAL REGISTER OF HISTORIC PLACES INVENTORY - NOMINATION FORM

(Type all entries - complete applicable sections)

STATE: Missouri	
COUNTY: Cole	
FOR NPS USE ONLY	
ENTRY NUMBER	DATE

1. NAME	
COMMON: Governor's Mansion	
AND/OR HISTORIC: 	

2. LOCATION			
STREET AND NUMBER: 100 Madison Street			
CITY OR TOWN: Jefferson City			
STATE Missouri	CODE 65101	COUNTY: Cole	CODE 051

3. CLASSIFICATION			
CATEGORY (Check One)	OWNERSHIP		STATUS
District <input type="checkbox"/> Building <input checked="" type="checkbox"/>	Public <input checked="" type="checkbox"/>	Public Acquisition:	Occupied <input checked="" type="checkbox"/> Yes:
Site <input type="checkbox"/> Structure <input type="checkbox"/>	Private <input type="checkbox"/>	In Process <input type="checkbox"/>	Unoccupied <input type="checkbox"/> Restricted <input type="checkbox"/>
Object <input type="checkbox"/>	Both <input type="checkbox"/>	Being Considered <input type="checkbox"/>	Preservation work in progress <input type="checkbox"/> Unrestricted <input type="checkbox"/>
PRESENT USE (Check One or More as Appropriate)			
Agricultural <input type="checkbox"/>	Government <input checked="" type="checkbox"/>	Park <input type="checkbox"/>	Transportation <input type="checkbox"/> Comments <input type="checkbox"/>
Commercial <input type="checkbox"/>	Industrial <input type="checkbox"/>	Private Residence <input checked="" type="checkbox"/>	Other (Specify) <input type="checkbox"/>
Educational <input type="checkbox"/>	Military <input type="checkbox"/>	Religious <input type="checkbox"/>	
Entertainment <input type="checkbox"/>	Museum <input type="checkbox"/>	Scientific <input type="checkbox"/>	

4. OWNER OF PROPERTY			
OWNERS NAME: State of Missouri, Board of Public Buildings			
STREET AND NUMBER: State Capitol Building			
CITY OR TOWN: Jefferson City	STATE: Missouri	CODE 65101	CODE 24

5. LOCATION OF LEGAL DESCRIPTION			
COURTHOUSE, REGISTRY OF DEEDS, ETC: Office of Recorder of Deeds, Cole County Courthouse			
STREET AND NUMBER: State Capitol Building			
CITY OR TOWN: Jefferson City	STATE: Missouri	CODE 65101	CODE 24
APPROXIMATE ACREAGE OF NOMINATED PROPERTY: 3.31			

6. REPRESENTATION IN EXISTING SURVEYS			
TITLE OF SURVEY: Missouri Historic Sites Catalogue			
DATE OF SURVEY: 1963 Federal <input type="checkbox"/> State <input checked="" type="checkbox"/> County <input type="checkbox"/> Local <input type="checkbox"/>			
DEPOSITORY FOR SURVEY RECORDS: State Historical Society of Missouri			
STREET AND NUMBER: Corner, Hitt and Lowry streets			
CITY OR TOWN: Columbia	STATE: Missouri	CODE 65201	CODE 24

SEE INSTRUCTIONS

STATE: Missouri  
COUNTY: Cole  
ENTRY NUMBER:    
DATE:

UNITED STATES DEPARTMENT OF THE INTERIOR  
NATIONAL PARK SERVICE

NATIONAL REGISTER OF HISTORIC PLACES  
INVENTORY - NOMINATION FORM

(Continuation Sheet)

STATE	
Missouri	
COUNTY	
Cole	
FOR NPS USE ONLY	
ENTRY NUMBER	DATE

(Number all entries)

GOVERNOR'S MANSION

6. Missouri's Contribution to American Architecture (state)

1928

John Albury Bryan

c/o St. Louis Architectural Club, Publisher

St. Louis, Missouri 63130

Code: 24

Missouri State Historical Survey (state)

1963

Missouri State Park Board

P.O. Box 176

1204 Jefferson Building

Jefferson City, Missouri 65101

Code: 24

## 7. DESCRIPTION

CONDITION	(Check One)					
	Excellent <input type="checkbox"/>	Good <input checked="" type="checkbox"/>	Fair <input type="checkbox"/>	Deteriorated <input type="checkbox"/>	Ruins <input type="checkbox"/>	Unexposed <input type="checkbox"/>
INTEGRITY	(Check One)			(Check One)		
	Altered <input checked="" type="checkbox"/> Unaltered <input type="checkbox"/>			Moved <input type="checkbox"/> Original Site <input checked="" type="checkbox"/>		

DESCRIBE THE PRESENT AND ORIGINAL (If known) PHYSICAL APPEARANCE

Three-story mansard roof Victorian residence designed by St. Louis architect George I. Barnett, situated on a bluff overlooking a wide bend in the Missouri River. Brick and stone construction, well finished with mouldings, quoins, and cresting. Red granite columns donated by Governor B. Gratz Brown (1871-1873), first governor to occupy the Mansion. Columns were quarried from his property in Iron County, Missouri. Grounds are enclosed by ornamental iron fence.

First floor includes large entrance hall, reception parlors, library and dining room. Second floor contains large hallway, seven bedrooms and four baths. Third floor has six bedrooms, two baths, billiard room, and the ballroom, which extends the full length of Mansion from north to south. Winding stairway in central hallway has ornate railing and newel post and connects the three floors.

Carriage porch and entrance on south added, 1900-1904.  
Interior remodeled and modernized, 1938, 1956, and 1960.

Building presently under repair. When repair work is completed, building will be in excellent condition.

SEE INSTRUCTIONS

# 8. SIGNIFICANCE

## PERIOD (Check One or More as Appropriate)

Pre-Columbian ☐ 16th Century ☐ 18th Century ☐ 20th Century ☒  
 15th Century ☐ 17th Century ☐ 19th Century ☒

## SPECIFIC DATE(S) (If Applicable and Known)

## AREAS OF SIGNIFICANCE (Check One or More as Appropriate)

Aboriginal	Education	<input type="checkbox"/>	Political	<input checked="" type="checkbox"/>	Urban Planning	<input type="checkbox"/>
Prehistoric	Engineering	<input type="checkbox"/>	Religion/Phi-		Other (Specify)	<input type="checkbox"/>
Historic	Industry	<input type="checkbox"/>	losophy	<input type="checkbox"/>		
Agriculture	Invention	<input type="checkbox"/>	Science	<input type="checkbox"/>		
Art	Landscape	<input type="checkbox"/>	Sculpture	<input type="checkbox"/>		
Commerce	Architecture	<input type="checkbox"/>	Social/Human-			
Communications	Literature	<input type="checkbox"/>	itarian	<input type="checkbox"/>		
Conservation	Military	<input type="checkbox"/>	Theater	<input type="checkbox"/>		
	Music	<input type="checkbox"/>	Transportation	<input type="checkbox"/>		

## STATEMENT OF SIGNIFICANCE (Include Personages, Dates, Events, Etc.)

The primary significance of the Governor's Mansion derives from building's use as the official residence of Missouri's governors, 1871 to present. Secondary significance of Mansion rests in the fact that it is an outstanding example of a three-story mansard roof Victorian residence and was designed by a notable St. Louis architect, George I. Barnett. Mansion faces the Cole County Historical Society Building located at 109 Madison Street. The latter building is included in a row of nineteenth century urban houses which enhance the setting of the Mansion by sustaining the period homogeneity of the neighborhood.

In April, 1871, Governor B. Gratz Brown obtained a state appropriation of \$50,000 for the construction of a new executive mansion. The Mansion replaced an earlier executive residence located slightly to the south of it. The old executive mansion was razed soon after completion of the present structure.

A marker, erected in 1941 by the Daughters of the American Colonists, commemorates the site of the first Capitol and Governor's Mansion in the City of Jefferson.

SEE INSTRUCTIONS

# 9. MAJOR BIBLIOGRAPHICAL REFERENCES

1. Caldwell, Dorothy J. (ed.). Missouri Historic Sites Catalogue. Columbia, Missouri: The State Historical Society of Missouri, 1963.
2. Jefferson City Daily Tribune, April 12, 1871, p. 2, col. 4. Plans for new mansion submitted.
3. \_\_\_\_\_, Oct. 24, 1895, p. 4, col. 3. History of Mansion, including reference to former Governor's Mansion on same site.
4. Jefferson City News and Tribune, Nov. 17, 1957, p. 8. History of State Governor's Mansions.

# 10. GEOGRAPHICAL DATA

LATITUDE AND LONGITUDE COORDINATES DEFINING A RECTANGLE LOCATING THE PROPERTY			O R	LATITUDE AND LONGITUDE COORDINATES DEFINING THE CENTER POINT OF A PROPERTY OF LESS THAN ONE ACRE		
CORNER	LATITUDE	LONGITUDE		LATITUDE	LONGITUDE	
	Degrees Minutes Seconds	Degrees Minutes Seconds		Degrees Minutes Seconds	Degrees Minutes Seconds	
N NW	38° 34' 44"	92° 10' 13"				
E NE	38° 34' 41"	92° 10' 09"				
S SE	38° 34' 38"	92° 10' 12"				
W SW	38° 34' 40"	92° 10' 16"				

LIST ALL STATES AND COUNTIES FOR PROPERTIES OVERLAPPING STATE OR COUNTY BOUNDARIES

STATE:	CODE	COUNTY	CODE
STATE:	CODE	COUNTY:	CODE
STATE:	CODE	COUNTY:	CODE
STATE:	CODE	COUNTY:	CODE

# 11. FORM PREPARED BY

NAME AND TITLE: <u>M. Patricia Holmes, Research Architectural Historian</u>		
ORGANIZATION <u>Missouri State Park Board</u> <u>State Historical Survey and Planning Office</u>	DATE <u>April 25, 1969</u>	
STREET AND NUMBER: <u>P.O. Box 176, 1204 Jefferson Building</u>		
CITY OR TOWN: <u>Jefferson City</u>	STATE <u>Missouri</u> 65101	
	CODE <u>24</u>	

# 12. STATE LIAISON OFFICER CERTIFICATION

As the designated State Liaison Officer for the National Historic Preservation Act of 1966 (Public Law 89-665), I hereby nominate this property for inclusion in the National Register and certify that it has been evaluated according to the criteria and procedures set forth by the National Park Service. The recommended level of significance of this nomination is:

National ☐ State ☒ Local ☐

Name Joseph Jaeger, Jr.

Title Director, Missouri State Park Board, and Missouri State Liaison Officer

Date \_\_\_\_\_

# NATIONAL REGISTER VERIFICATION

I hereby certify that this property is included in the National Register.

Chief, Office of Archeology and Historic Preservation

Date \_\_\_\_\_

ATTEST:

Keeper of The National Register

Date \_\_\_\_\_

SEE INSTRUCTIONS

NATIONAL REGISTER OF HISTORIC PLACES  
INVENTORY - NOMINATION FORM

(Continuation Sheet)

STATE	
Missouri	
COUNTY	
Cole	
FOR NPS USE ONLY	
ENTRY NUMBER	DATE

(Number all entries)

GOVERNOR'S MANSION

9.

5. Official Manual, State of Missouri, 1967-1968,  
James C. Kirkpatrick, Secretary of State, State  
Capitol, Jefferson City, Missouri.
6. State Historical Society of Missouri, Corner, Hitt  
and Lowry streets, Columbia, Missouri, Historic  
Sites Files, ref. Cole County.

**SITE FILE COPY**

**NATIONAL REGISTER OF HISTORIC PLACES  
INVENTORY - NOMINATION FORM**

(Type all entries - complete applicable sections)

STATE: Missouri	
COUNTY: Cole	
FOR NPS USE ONLY	
ENTRY NUMBER 69-05-24-0016	DATE 5/21/69

<b>1. NAME</b>	
COMMON: Governor's Mansion	
AND/OR HISTORIC:	

<b>2. LOCATION</b>			
STREET AND NUMBER: 100 Madison Street			
CITY OR TOWN: Jefferson City			
STATE Missouri	CODE 65101	COUNTY: Cole	CODE 051

<b>3. CLASSIFICATION</b>							
CATEGORY (Check One)		OWNERSHIP		STATUS		ACCESSIBLE TO THE PUBLIC	
District <input type="checkbox"/>	Building <input checked="" type="checkbox"/>	Public <input checked="" type="checkbox"/>	Public Acquisition: <input type="checkbox"/>	Occupied <input checked="" type="checkbox"/>	Yes:		
Site <input type="checkbox"/>	Structure <input type="checkbox"/>	Private <input type="checkbox"/>	In Process <input type="checkbox"/>	Unoccupied <input type="checkbox"/>	Restricted <input type="checkbox"/>		
Object <input type="checkbox"/>		Both <input type="checkbox"/>	Being Considered <input type="checkbox"/>	Preservation work in progress <input type="checkbox"/>	Unrestricted <input type="checkbox"/>		
					No: <input checked="" type="checkbox"/>		
PRESENT USE (Check One or More as Appropriate)							
Agricultural <input type="checkbox"/>	Government <input checked="" type="checkbox"/>	Park <input type="checkbox"/>	Transportation <input type="checkbox"/>	Comments <input type="checkbox"/>			
Commercial <input type="checkbox"/>	Industrial <input type="checkbox"/>	Private Residence <input checked="" type="checkbox"/>	Other (Specify) <input type="checkbox"/>				
Educational <input type="checkbox"/>	Military <input type="checkbox"/>	Religious <input type="checkbox"/>					
Entertainment <input type="checkbox"/>	Museum <input type="checkbox"/>	Scientific <input type="checkbox"/>					

<b>4. OWNER OF PROPERTY</b>			
OWNERS NAME: State of Missouri, Board of Public Buildings			
STREET AND NUMBER: State Capitol Building			
CITY OR TOWN: Jefferson City	STATE: Missouri	CODE 65101	CODE 24

<b>5. LOCATION OF LEGAL DESCRIPTION</b>			
COURTHOUSE, REGISTRY OF DEEDS, ETC: Office of Recorder of Deeds, Cole County Courthouse			
STREET AND NUMBER: State Capitol Building			
CITY OR TOWN: Jefferson City	STATE: Missouri	CODE 65101	CODE 24
APPROXIMATE ACREAGE OF NOMINATED PROPERTY: 3.31			

<b>6. REPRESENTATION IN EXISTING SURVEYS</b>			
TITLE OF SURVEY: Missouri Historic Sites Catalogue			
DATE OF SURVEY: 1963	Federal <input type="checkbox"/>	State <input checked="" type="checkbox"/>	County <input type="checkbox"/> Local <input type="checkbox"/>
DEPOSITORY FOR SURVEY RECORDS: State Historical Society of Missouri			
STREET AND NUMBER: Corner, Hitt and Lowry streets			
CITY OR TOWN: Columbia	STATE: Missouri	CODE 65201	CODE 24

SEE INSTRUCTIONS

STATE: Missouri  
COUNTY: Cole  
ENTRY NUMBER: 69-05-24-0016  
DATE: 5/21/69  
FOR NPS USE ONLY

# 9. MAJOR BIBLIOGRAPHICAL REFERENCES

1. Caldwell, Dorothy J. (ed.). Missouri Historic Sites Catalogue. Columbia, Missouri: The State Historical Society of Missouri, 1963.
2. Jefferson City Daily Tribune, April 12, 1871, p. 2, col. 4. Plans for new mansion submitted.
3. \_\_\_\_\_, Oct. 24, 1895, p. 4, col. 3. History of Mansion, including reference to former Governor's Mansion on same site.
4. Jefferson City News and Tribune, Nov. 17, 1957, p. 8. History of State Governor's Mansions.

# 10. GEOGRAPHICAL DATA

LATITUDE AND LONGITUDE COORDINATES DEFINING A RECTANGLE LOCATING THE PROPERTY			O R	LATITUDE AND LONGITUDE COORDINATES DEFINING THE CENTER POINT OF A PROPERTY OF LESS THAN ONE ACRE		
CORNER	LATITUDE	LONGITUDE		LATITUDE	LONGITUDE	
	Degrees Minutes Seconds	Degrees Minutes Seconds		Degrees	Minutes	Seconds
N NW	38° 34' 44"	92° 10' 13"		°	'	"
E NE	38° 34' 41"	92° 10' 09"		°	'	"
S SE	38° 34' 38"	92° 10' 12"		°	'	"
W SW	38° 34' 40"	92° 10' 16"		°	'	"

LIST ALL STATES AND COUNTIES FOR PROPERTIES OVERLAPPING STATE OR COUNTY BOUNDARIES

STATE:	CODE	COUNTY	CODE
STATE:	CODE	COUNTY:	CODE
STATE:	CODE	COUNTY:	CODE
STATE:	CODE	COUNTY:	CODE

# 11. FORM PREPARED BY

NAME AND TITLE:	
M. Patricia Holmes, Research Architectural Historian	
ORGANIZATION	DATE
Missouri State Park Board	April 25, 1969
State Historical Survey and Planning Office	
STREET AND NUMBER:	
P.O. Box 176, 1201 Jefferson Building	
CITY OR TOWN:	STATE
Jefferson City	Missouri 65101
	CODE
	24

# 12. STATE LIAISON OFFICER CERTIFICATION

# NATIONAL REGISTER VERIFICATION

As the designated State Liaison Officer for the National Historic Preservation Act of 1966 (Public Law 89-665), I hereby nominate this property for inclusion in the National Register and certify that it has been evaluated according to the criteria and procedures set forth by the National Park Service. The recommended level of significance of this nomination is:

National ☐ State ☒ Local ☐

Name

Joseph Jaeger, Jr.

Title Director, Missouri State Park Board, and Missouri State Liaison Officer

Date

I hereby certify that this property is included in the National Register.

Robert Allen Gentry  
Chief, Office of Archeology and Historic Preservation

Date May 21, 1969

ATTEST:

William J. Schenck  
Keeper of The National Register

Date May 21, 1969

SEE INSTRUCTIONS



# SITE FILE COPY

Form 10-300  
(Rev. 6-72)

UNITED STATES DEPARTMENT OF THE INTERIOR  
NATIONAL PARK SERVICE

## NATIONAL REGISTER OF HISTORIC PLACES INVENTORY - NOMINATION FORM

(Type all entries - complete applicable sections)

STATE:	Missouri
COUNTY:	Cole
FOR NPS USE ONLY	
ENTRY DATE	

SITE FILE COPY October, 1974 VERSION

<b>1. NAME</b>	
COMMON:	Governor's Mansion
AND/OR HISTORIC:	

<b>2. LOCATION</b>			
STREET AND NUMBER: 100 Madison Street			
CITY OR TOWN: Jefferson City		CONGRESSIONAL DISTRICT: 8th The Hon. Richard H. Ichord	
STATE Missouri	CODE 29	COUNTY: Cole	CODE 051

<b>3. CLASSIFICATION</b>			
CATEGORY (Check One)	OWNERSHIP		STATUS
<input type="checkbox"/> District <input type="checkbox"/> Site <input type="checkbox"/> Object	<input checked="" type="checkbox"/> Building <input type="checkbox"/> Structure <input type="checkbox"/> Public <input type="checkbox"/> Private <input type="checkbox"/> Both		<input checked="" type="checkbox"/> Occupied <input type="checkbox"/> Unoccupied <input type="checkbox"/> Preservation work in progress
<input type="checkbox"/> In Process <input type="checkbox"/> Being Considered		ACCESSIBLE TO THE PUBLIC Yes: <input checked="" type="checkbox"/> Restricted <input type="checkbox"/> Unrestricted <input type="checkbox"/> No	
PRESENT USE (Check One or More as Appropriate)			
<input type="checkbox"/> Agricultural <input type="checkbox"/> Commercial <input type="checkbox"/> Educational <input type="checkbox"/> Entertainment	<input checked="" type="checkbox"/> Government <input type="checkbox"/> Industrial <input type="checkbox"/> Military <input type="checkbox"/> Museum	<input type="checkbox"/> Park <input type="checkbox"/> Private Residence <input type="checkbox"/> Religious <input type="checkbox"/> Scientific	<input type="checkbox"/> Transportation <input type="checkbox"/> Other (Specify) _____ _____
Comments _____ _____			

<b>4. OWNER OF PROPERTY</b>			
OWNER'S NAME: State of Missouri, Board of Public Buildings			
STREET AND NUMBER: State Capitol Building			
CITY OR TOWN: Jefferson City	STATE: Missouri	CODE 29	

<b>5. LOCATION OF LEGAL DESCRIPTION</b>			
COURTHOUSE, REGISTRY OF DEEDS, ETC: Office of Recorder of Deeds, Cole County Courthouse			
STREET AND NUMBER: Monroe and East High streets			
CITY OR TOWN: Jefferson City	STATE: Missouri	CODE 29	

<b>6. REPRESENTATION IN EXISTING SURVEYS</b>			
TITLE OF SURVEY: Missouri Historic Sites Catalogue			
DATE OF SURVEY: 1963 <input type="checkbox"/> Federal <input checked="" type="checkbox"/> State <input type="checkbox"/> County <input type="checkbox"/> Local			
DEPOSITORY FOR SURVEY RECORDS: State Historical Society of Missouri			
STREET AND NUMBER: Corner, Hitt and Lowry streets			
CITY OR TOWN: Columbia,	STATE: Missouri	CODE 29	

SEE INSTRUCTIONS

STATE:  
Missouri

COUNTY:  
Cole

ENTRY NUMBER

FOR NPS USE ONLY

DATE

**NATIONAL REGISTER OF HISTORIC PLACES  
INVENTORY - NOMINATION FORM**

(Continuation Sheet)

STATE Missouri	
COUNTY Cole	
FOR NPS USE ONLY	
ENTRY NUMBER	DATE

(Number all entries)

6. #1

GOVERNOR'S MANSION

2. Missouri's Contribution to American Architecture  
1928

(state)

John Albury Bryan  
St. Louis Architectural Club, Publisher  
St. Louis, Missouri

Code: 29

3. Missouri State Historical Survey  
1968 & 1974  
Department of Natural Resources  
P.O. Box 176  
Jefferson City, Missouri 65101

(state)

Code: 29

# 9. MAJOR BIBLIOGRAPHICAL REFERENCES

1. Bryan, John Albury. Missouri's Contribution to American Architecture. St. Louis, Missouri: St. Louis Architectural Club, 1928.
2. Brown, Linda L. Data compiled on the history of the Executive Mansion preparatory to updating the National Register Inventory Nomination Form. Miss Brown is News Assistant, Executive Office, State Capitol Building, October, 1973.

# 10. GEOGRAPHICAL DATA

LATITUDE AND LONGITUDE COORDINATES DEFINING A RECTANGLE LOCATING THE PROPERTY			O R	LATITUDE AND LONGITUDE COORDINATES DEFINING THE CENTER POINT OF A PROPERTY OF LESS THAN TEN ACRES		
CORNER	LATITUDE	LONGITUDE		LATITUDE	LONGITUDE	
N-NW	Degrees Minutes Seconds 38° 34' 44"	Degrees Minutes Seconds 92° 10' 12"		Degrees Minutes Seconds 0	Degrees Minutes Seconds 0	
E-NE	38° 34' 41"	92° 10' 07"				
S-SE	38° 34' 37"	92° 10' 11"				
W-SW	38° 34' 40"	92° 10' 16"				

APPROXIMATE ACREAGE OF NOMINATED PROPERTY: less than 10 acres

LIST ALL STATES AND COUNTIES FOR PROPERTIES OVERLAPPING STATE OR COUNTY BOUNDARIES

STATE:	CODE	COUNTY	CODE
STATE:	CODE	COUNTY:	CODE
STATE:	CODE	COUNTY:	CODE
STATE:	CODE	COUNTY:	CODE

# 11. FORM PREPARED BY

NAME AND TITLE: <u>M. Patricia Holmes, Research Associate</u>		
ORGANIZATION <u>Department of Natural Resources</u> <u>State Historical Survey and Planning Office</u>	DATE <u>July 22, 1974</u>	
STREET AND NUMBER: <u>P. O. Box 176</u>		
CITY OR TOWN: <u>Jefferson City</u>	STATE <u>Missouri 65101</u>	CODE <u>29</u>

# 12. STATE LIAISON OFFICER CERTIFICATION

# NATIONAL REGISTER VERIFICATION

As the designated State Liaison Officer for the National Historic Preservation Act of 1966 (Public Law 89-665), I hereby nominate this property for inclusion in the National Register and certify that it has been evaluated according to the criteria and procedures set forth by the National Park Service. The recommended level of significance of this nomination is:

National ☐ State ☒ Local ☐

Name James L. Wilson

Title Director, Department of Natural Resources, and State Historic Preservation Officer

Date \_\_\_\_\_

I hereby certify that this property is included in the National Register.

\_\_\_\_\_  
Director, Office of Archeology and Historic Preservation

Date \_\_\_\_\_

ATTEST:

\_\_\_\_\_  
Keeper of The National Register

Date \_\_\_\_\_

SEE INSTRUCTIONS

NATIONAL REGISTER OF HISTORIC PLACES  
INVENTORY - NOMINATION FORM

(Continuation Sheet)

STATE Missouri	
COUNTY Cole	
FOR NPS USE ONLY	
ENTRY NUMBER	DATE

(Number all entries)

9. #1

GOVERNOR'S MANSION

3. Caldwell, Dorothy J. (ed.). Missouri Historic Sites Catalogue.  
Columbia, Missouri: The State Historical Society of Missouri, 1963.
4. Jefferson City [Missouri] Daily Tribune, April 12, 1871, p. 2, col. 4.  
Plans for new mansion submitted.
5. \_\_\_\_\_, October 24, 1895, p. 4, col. 3. History of mansion, including reference to former Governor's Mansion on same site.
6. Jefferson City [Missouri] News and Tribune, November 17, 1957, p. 8.  
History of State Governor's Mansions.
7. Official Manual, State of Missouri, 1967-1968, James C. Kirkpatrick,  
Secretary of State, State Capitol, Jefferson City, Missouri.
8. State Historical Society of Missouri, Corner, Hitt and Lowry streets,  
Columbia, Missouri, Historic Sites Files, ref. Cole County.

Form 10-301  
(Dec. 1968)

UNITED STATES DEPARTMENT OF THE INTERIOR  
NATIONAL PARK SERVICE

# NATIONAL REGISTER OF HISTORIC PLACES

## PROPERTY MAP FORM

(Type all entries - attach to or enclose with map)

STATE	Missouri		
COUNTY	Cole		
FOR NPS USE ONLY			
ENTRY NUMBER	DATE		
1. NAME			
COMMON:	Governor's Mansion		
AND/OR HISTORIC:			
2. LOCATION			
STREET AND NUMBER:	100 Madison Street		
CITY OR TOWN:	Jefferson City		
STATE:	CODE	COUNTY:	CODE
Missouri	65101	Cole	051
3. MAP REFERENCE			
SOURCE:	U.S.G.S. 7.5' quadrangle Jefferson City		
SCALE:	1:24,000		
DATE:	1939		
4. REQUIREMENTS			
TO BE INCLUDED ON ALL MAPS			
1. Property boundaries where required.			
2. North arrow.			
3. Latitude and longitude reference.			

SEE INSTRUCTIONS

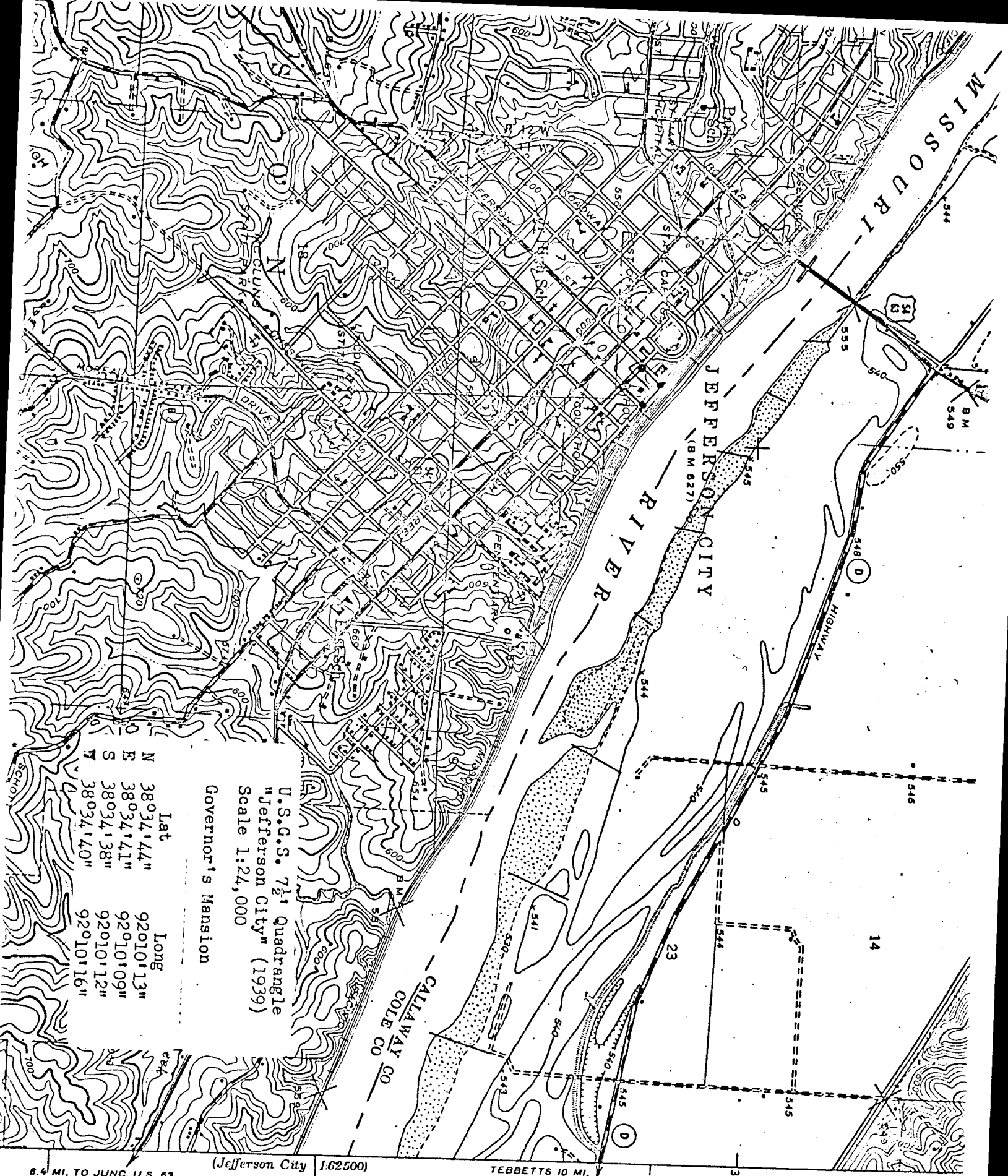

Lat  
 38°34'44" N  
 38°34'41" E  
 38°34'38" S  
 38°34'40" W  
 Long  
 92°10'13" N  
 92°10'09" E  
 92°10'12" S  
 92°10'16" W

U.S.G.S. 7 1/2' Quadrangle  
 "Jefferson City" (1939)  
 Scale 1:24,000  
 Governor's Mansion

8.4 MI. TO JUNC. U.S. 63  
 LINN 17 MI.

(Jefferson City 1:62500)

TEBBETTS 10 MI.  
 MOKANE 16 MI.

TM  
 6 1/2°

# SEE INSTRUCTIONS

Form 10-301  
(Dec. 1968)

UNITED STATES DEPARTMENT OF THE INTERIOR  
NATIONAL PARK SERVICE

## NATIONAL REGISTER OF HISTORIC PLACES

### PROPERTY MAP FORM

(Type all entries - attach to or enclose with map)

1. NAME		STATE	
COMMON: Governor's Mansion		Missouri	
AND/OR HISTORIC:		COUNTY	
2. LOCATION		Cole	
STREET AND NUMBER: 100 Madison Street		FOR NPS USE ONLY	
CITY OR TOWN: Jefferson City		ENTRY NUMBER	
STATE: Missouri		DATE	
CODE 21		COUNTY: Cole	
3. MAP REFERENCE		CODE 051	
SOURCE: State Highway Department Map, Jefferson City, Missouri 65101			
SCALE: Not to scale			
DATE: n.d.			
4. REQUIREMENTS			
TO BE INCLUDED ON ALL MAPS			
1. Property boundaries where required.			
2. North arrow.			
3. Latitude and longitude reference.			

Form 10-301  
(Dec. 1968)

UNITED STATES DEPARTMENT OF THE INTERIOR  
NATIONAL PARK SERVICE

# NATIONAL REGISTER OF HISTORIC PLACES

## PROPERTY MAP FORM

(Type all entries - attach to or enclose with map)

### 1. NAME

COMMON: Governor's Mansion

AND/OR HISTORIC:

### 2. LOCATION

STREET AND NUMBER:

100 Madison Street

CITY OR TOWN:

Jefferson City

STATE:

Missouri 65101

### 3. MAP REFERENCE

SOURCE:

Sketch made by Division of Public Buildings  
Jefferson City, Missouri 65101

SCALE:

Not to scale

DATE:

1965

### 4. REQUIREMENTS

TO BE INCLUDED ON ALL MAPS

1. Property boundaries where required.
2. North arrow.
3. Latitude and longitude reference.

STATE

Missouri

COUNTY

Cole

FOR NPS USE ONLY

ENTRY NUMBER

DATE

CODE

21

COUNTY:

Cole

CODE

051

SEE INSTRUCTIONS



NATIONAL REGISTER OF HISTORIC PLACES  
INVENTORY - NOMINATION FORM

(Continuation Sheet)

STATE	
COUNTY	
FOR NPS USE ONLY	
ENTRY NUMBER	DATE

(Number all entries)

STATE CAPITOL GROUP  
JEFFERSON CITY,  
MO.

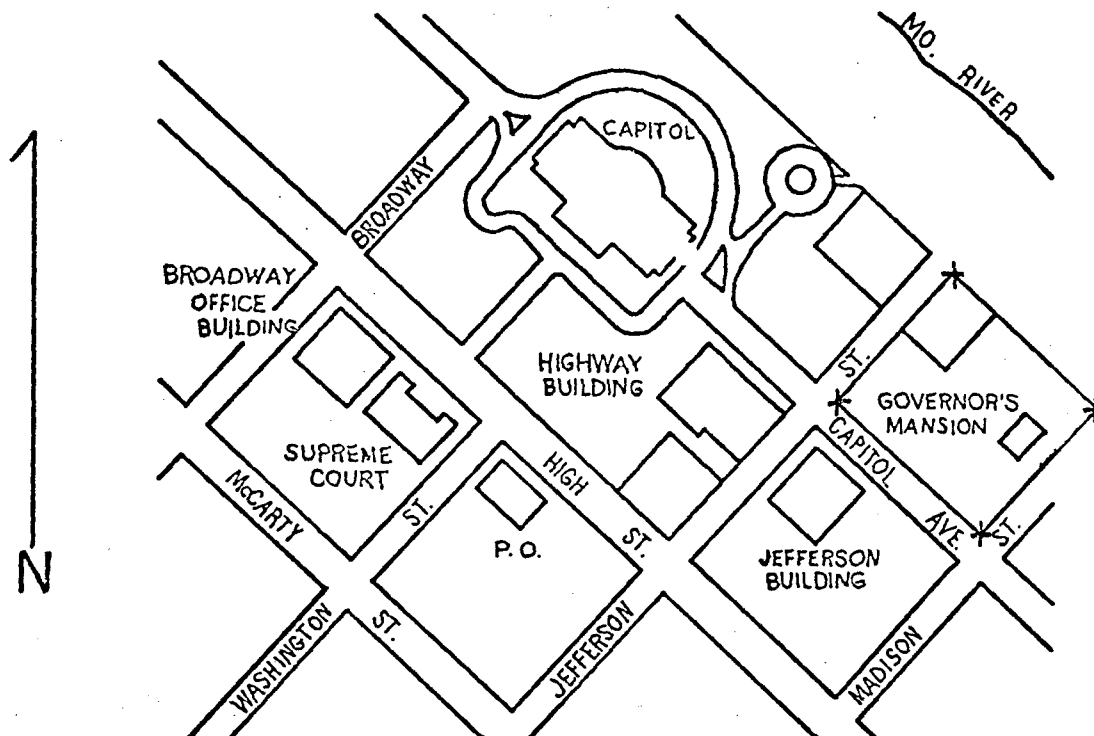

Map excerpted from  
STATE HIGHWAY DEPT. MAP  
JEFFERSON CITY, MO., n.d.

SCALE NOT KNOWN

MSHS, 4-24-69  
Martha Godfrey

NATIONAL REGISTER OF HISTORIC PLACES  
INVENTORY - NOMINATION FORM

(Continuation Sheet)

STATE	
COUNTY	
FOR NPS USE ONLY	
ENTRY NUMBER	DATE

(Number all entries)

GOVERNOR'S MANSION  
JEFFERSON CITY, MO.

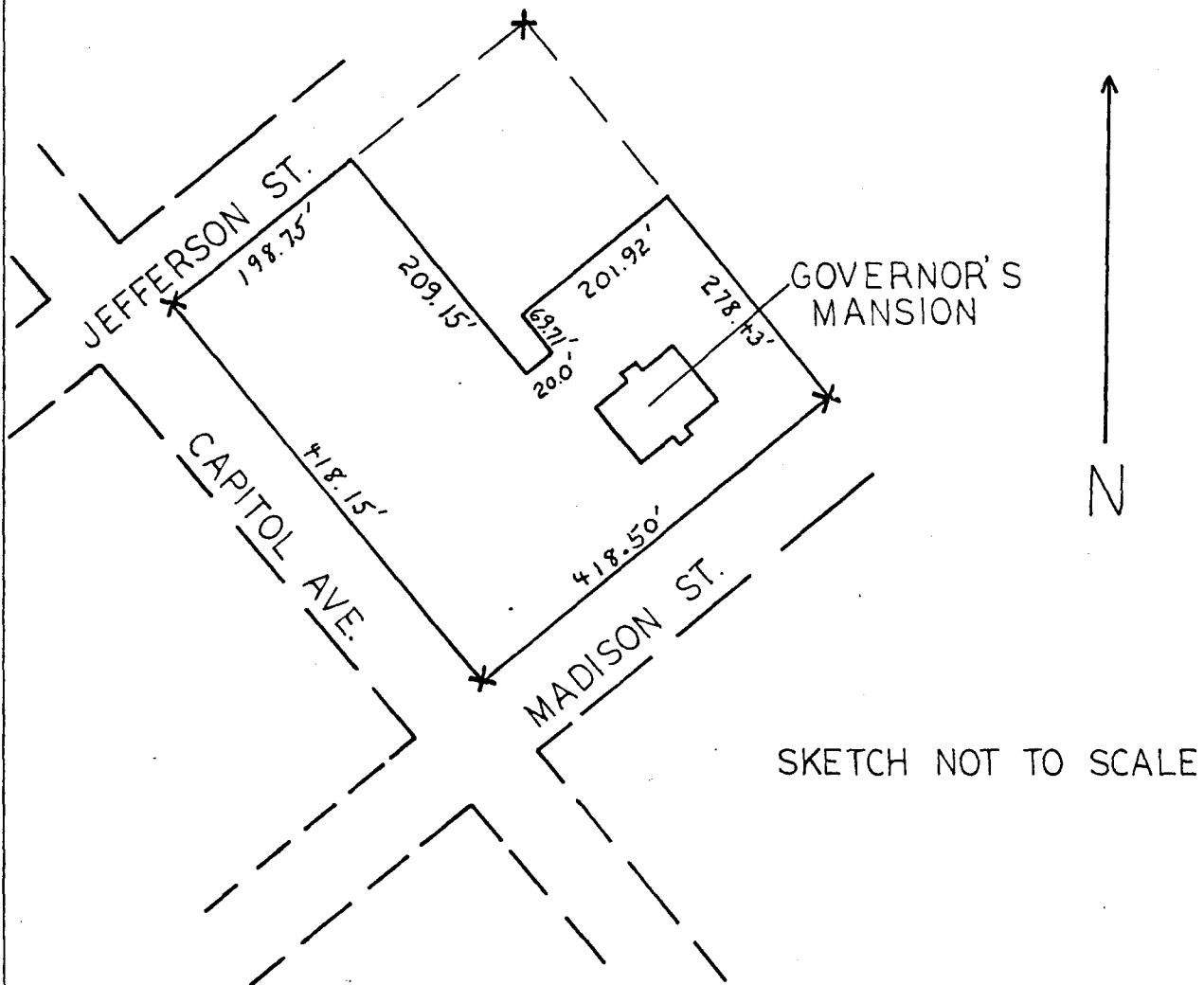

DRAWING FROM A SKETCH  
MADE BY DIVISION OF PUBLIC  
BUILDINGS, JEFFERSON CITY, MO.  
1965.

MSHS, 4-23-69  
Steven Teczar

Go  
by  
15  
In

8746

FORM 10-301 A  
(6/72)

UNITED STATES DEPARTMENT OF THE INTERIOR  
NATIONAL PARK SERVICE

**NATIONAL REGISTER OF HISTORIC PLACES  
PROPERTY PHOTOGRAPH FORM**

*(Type all entries - attach to or enclose with photograph)*

<b>1. NAME</b> COMMON Governor's Mansion		AND/OR HISTORIC	NUMERIC CODE (Assigned by NPS)
<b>2. LOCATION</b>			
STATE Missouri	COUNTY Cole	TOWN Jefferson City	
STREET AND NUMBER 100 Madison Street			
<b>3. PHOTO REFERENCE</b> PHOTO CREDIT Office of the Governor		DATE October, 1974	NEGATIVE FILED AT Copy Negative, October 1974, Department of Natural Resources, P.O. Box 176, Jefferson City, Mo. 65101
<b>4. IDENTIFICATION</b> DESCRIBE VIEW, DIRECTION, ETC.			

Interior view of the mansion showing carved marble fireplace in first floor parlor.



FORM 10-301 A  
(6/72)

UNITED STATES DEPARTMENT OF THE INTERIOR  
NATIONAL PARK SERVICE  
**NATIONAL REGISTER OF HISTORIC PLACES**  
**PROPERTY PHOTOGRAPH FORM**

(Type all entries - attach to or enclose with photograph)

<b>1. NAME</b>		
COMMON Governor's Mansion	AND/OR HISTORIC	NUMERIC CODE (Assigned by NPS)
<b>2. LOCATION</b>		
STATE Missouri 65101	COUNTY Cole	TOWN Jefferson City
STREET AND NUMBER 100 Madison Street		
<b>3. PHOTO REFERENCE</b>		
PHOTO CREDIT Office of the Governor	DATE October, 1974	NEGATIVE FILED AT Copy Negative, October 1974, Department of Natural Resources, P. O. Box 1 Jefferson City, Mo. 65101
<b>4. IDENTIFICATION</b>		
DESCRIBE VIEW, DIRECTION, ETC.		

Interior view of the mansion showing grand stairway.

SITE FILE COPY





# SITE FILE COPY

FORM 10-301 A  
(6/72)

UNITED STATES DEPARTMENT OF THE INTERIOR  
NATIONAL PARK SERVICE  
**NATIONAL REGISTER OF HISTORIC PLACES**  
**PROPERTY PHOTOGRAPH FORM**

(Type all entries - attach to or enclose with photograph)

1. NAME COMMON		AND/OR HISTORIC		NUMERIC CODE (Assigned by NPS)	
Governor's Mansion					
2. LOCATION					
STATE	Missouri	COUNTY	Cole	TOWN	Jefferson City
STREET AND NUMBER		100 Madison Street			
3. PHOTO REFERENCE		DATE		NEGATIVE FILED AT	
M. Patricia Holmes		April 21, 1970		Dept. of Natural Resources P. O. Box 176 Jefferson City, Mo. 65101	
4. IDENTIFICATION					
DESCRIBE VIEW, DIRECTION, ETC.					

View from the south-southeast, looking north-northwest, showing the primary south-east facade. The architectural design features a mansard roof, ornamental cresting, neo-classic dormers and window treatment, and polished granite portico columns matching the red brick in color--an effect which was lost while the house was painted white.





SEE INSTRUCTIONS

# PROPERTY PHOTOGRAPH FORM

(Type all entries - attach to or enclose with photograph)

		FOR NPS USE ONLY	
		ENTRY NUMBER	DATE
1. NAME			
COMMON:		Governor's Mansion	
AND/OR HISTORIC:			
2. LOCATION			
STREET AND NUMBER:		100 Madison Street	
CITY OR TOWN:		Jefferson City	
STATE:	CODE	COUNTY:	CODE
Missouri	65101	21	Cole
3. PHOTO REFERENCE			
PHOTO CREDIT: M. Patricia Holmes, State Historical Survey, Missouri State Park Board			
DATE OF PHOTO: 19 August 1968			
NEGATIVE FILED AT: Missouri State Park Board, P. O. Box 176			
1201 Jefferson Building, Jefferson City, Missouri 65101			
4. IDENTIFICATION			
DESCRIBE VIEW, DIRECTION, ETC.			
Looking northwest at southeast face of building. Note mansard roof and red granite columns.			

