

ARCHITECTURAL SURVEY OF MIDTOWN

MARCH 1977 ST. LOUIS, MISSOURI

LANDMARKS ASSOCIATION OF ST. LOUIS INC.

LEGEND:

- NATIONAL SIGNIFICANCE
- ▨ STATE SIGNIFICANCE
- ▩ CITY SIGNIFICANCE
- ▧ NEIGHBORHOOD SIGNIFICANCE
- ▦ ARCHITECTURAL MERIT - DEMOLITION WOULD DIMINISH THE INTEGRITY OF THE NEIGHBORHOOD
- LITTLE OR NO ARCHITECTURAL MERIT - DEMOLITION WOULD BE INCONSEQUENTIAL OR ADVANTAGEOUS

DEMOLITION WOULD BE A MAJOR CULTURAL LOSS

- LISTED ON THE NATIONAL REGISTER OF HISTORIC PLACES
- HISTORIC DISTRICT BOUNDARY
- ① OWNERS OF RECORD - KEYED TO ITEM #4
- ◁ PHOTO # AND CAMERA ANGLE

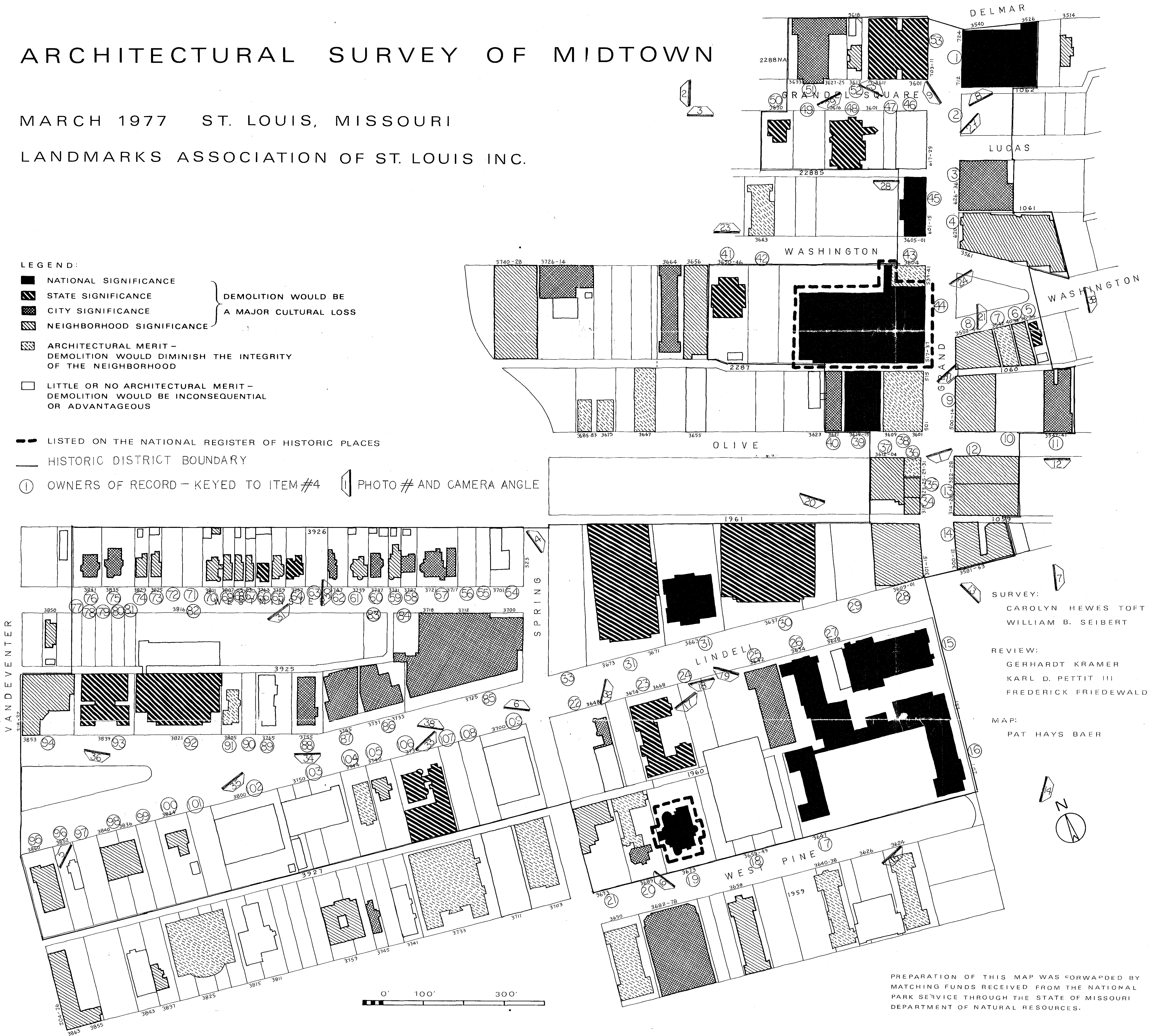

SURVEY:
CAROLYN HEWES TOFT
WILLIAM B. SEIBERT

REVIEW:
GERHARDT KRAMER
KARL D. PETTIT III
FREDERICK FRIEDEWALD

MAP:
PAT HAYS BAER

PREPARATION OF THIS MAP WAS FORWARDED BY MATCHING FUNDS RECEIVED FROM THE NATIONAL PARK SERVICE THROUGH THE STATE OF MISSOURI DEPARTMENT OF NATURAL RESOURCES.