

United States Department of the Interior
National Park Service

National Register of Historic Places Registration Form

1. Name of Property

historic name Keith, David, House

other names/site number Keith-Greensfelder House; Harris, Nannie Q. House

2. Location

street & number 116 North Woodlawn [N/A] not for publication

city or town Kirkwood [N/A] vicinity

state Missouri code MO county St. Louis code 189 zip code 63122

3. State/Federal Agency Certification

As the designated authority under the National Historic Preservation Act, as amended, I hereby certify that this nomination request for determination of eligibility meets the documentation standards for registering properties in the National Register of Historic Places and meets the procedural and professional requirements set forth in 36 CFR Part 60. In my opinion, the property meets does not meet the National Register criteria. I recommend that this property be considered significant nationally statewide locally. (See continuation sheet for additional comments .)

 12 August 07

Signature of certifying official/Title Claire F. Blackwell/Deputy SHPO

Date

Missouri Department of Natural Resources

State or Federal agency and bureau

In my opinion, the property meets does not meet the National Register criteria.
(See continuation sheet for additional comments .)

Signature of certifying official/Title

Date

State or Federal agency and bureau

4. National Park Service Certification

I hereby certify that the property is:

entered in the National Register.
See continuation sheet .

determined eligible for the
National Register.
See continuation sheet .

determined not eligible for the
National Register.

removed from the National
Register.

other, (explain):

Signature of the Keeper

Date of Action

Keith, David, House
St. Louis County, Missouri
Historic Resources of Kirkwood, Missouri

5. Classification

Ownership of Property	Category of Property	Number of Resources Within Property		
		Contributing	Non-contributing	
<input checked="" type="checkbox"/> private	<input type="checkbox"/> building(s)	1	1	buildings
<input type="checkbox"/> public-local	<input type="checkbox"/> district	0	0	sites
<input type="checkbox"/> public-State	<input type="checkbox"/> site	0	0	structures
<input type="checkbox"/> public-Federal	<input type="checkbox"/> structure	0	0	objects
	<input type="checkbox"/> object	1	1	Total

Name of related multiple property listing.

Number of contributing resources previously listed in the National Register.

Historic Resources of Kirkwood, Missouri

N/A

6. Function or Use

Historic Functions

DOMESTIC/ single dwelling

Current Functions

DOMESTIC/ single dwelling
DOMESTIC/secondary structure

7. Description

Architectural Classification

Late Victorian/ Italianate

Materials

foundation Stone
 walls Wood

 roof Asphalt
 other Wooden Porches

Narrative Description See continuation sheet [x].

See continuation sheet []

Keith, David, House
St. Louis County, Missouri
Historic Resources of Kirkwood, Missouri

8. Statement of Significance

Applicable National Register Criteria

A Property is associated with events that have made a significant contribution to the broad patterns of our history.

B Property is associated with the lives of persons significant in our past.

C Property embodies the distinctive characteristics of a type, period, or method of construction or represents the work of a master, or possesses high artistic values, or represents a significant and distinguishable entity whose components lack individual distinction.

D Property has yielded, or is likely to yield, information important in prehistory or history.

Criteria Considerations

Property is:

A owned by a religious institution or used for religious purposes.

B removed from its original location.

C a birthplace or grave.

D a cemetery.

E a reconstructed building, object, or structure.

F a commemorative property.

G less than 50 years of age or achieved significance within the past 50 years.

Narrative Statement of Significance

See continuation sheet [x].

9. Major Bibliographic References

Bibliography

See continuation sheet [x].

Previous documentation on file (NPS):

preliminary determination of individual listing (36 CFR 67) has been requested

previously listed in the National Register

previously determined eligible by the National Register

designated a National Historic Landmark

recorded by Historic American Buildings Survey

recorded by Historic American Engineering Record

Areas of Significance

Architecture

Period of Significance

ca. 1855

Significant Dates

ca. 1855

Significant Person(s)

N/A

Cultural Affiliation

N/A

Architect/Builder

Unknown

Primary location of additional data:

State Historic Preservation Office

Other State Agency

Federal Agency

Local Government

University

Other:

Name of repository:

Kirkwood Community Development Office

Keith, David, House
St. Louis County, Missouri
Historic Resources of Kirkwood, Missouri

10. Geographical Data

Acreage of Property 0.359

UTM References

A. Zone	Easting	Northing	B. Zone	Easting	Northing
15	726750	4273380			
C. Zone	Easting	Northing	D. Zone	Easting	Northing

[] See continuation sheet

Verbal Boundary Description

(Describe the boundaries of the property on a continuation sheet.)

Boundary Justification

(Explain why the boundaries were selected on a continuation sheet.)

11. Form Prepared By

name/title See Continuation Sheet

organization _____ date _____

street & number _____ telephone _____

city or town _____ state _____ zip code _____

Additional Documentation

Submit the following items with the completed form:

Continuation Sheets

Maps

A **USGS map** (7.5 or 15 minute series) indicating the property's location.

A **Sketch map** for historic districts and properties having large acreage or numerous resources.

Photographs

Representative **black and white photographs** of the property.

Additional Items

(Check with the SHPO or FOP for any additional items)

Property Owner

(Complete this item at the request of SHPO or FPO.)

name Mr. and Mrs. Don Marquess

street & number 116 North Woodlawn Ave. telephone _____

city or town Kirkwood state MO zip code 63122

United States Department of the Interior
National Park Service
National Register of Historic Places
Continuation Sheet

Section number 7 Page 1

Keith, David, House
St. Louis County, Missouri
Historic Resources of Kirkwood, Missouri

Summary: The David Keith house, at 116 North Woodlawn Avenue, is a two story Italianate style house with a symmetrical five bay facade and a one-story central bay front porch. Constructed ca. 1855, the highly intact house is an early example of Property Type B. Italianate Houses. It meets the registration requirements for that property type set forth in the MPS Cover document "Historic Resources of Kirkwood, Missouri." The box-shaped house has a front-facing centered gable which projects from a low-pitched hip roof with wide, overhanging eaves which feature paired brackets. The symmetrically arranged facade has a small, one-story central bay portico. Classically inspired elements include the porch columns, denticulated cornice, and pedimented window surrounds. Typical of the Kirkwood Italianate Houses property type is the wide, shiplap siding with wood quoins; this is one of the earliest houses to utilize that type of wall cladding. A three-car garage, constructed in 1953, is at the rear of the lot and is non-contributing. Additions to the rear of the house do not detract from its integrity of design, materials, workmanship, setting, and location.

Elaboration: The two-story house has a small, front-facing centered gable, which projects from the very low-pitched hipped roof. These roofs have wide overhanging eaves with a wide frieze board decorated with dentils. The eaves of the hip roof also have paired brackets and jig-sawn scrollwork beneath. As was typical of many of the extant Italianate homes in Kirkwood, the house is clad with wide, shiplap siding, accented with wood quoins, for an overall effect of tooled stone.

The house faces west to North Woodlawn street. The main section of the house is cubic, and the facade is five bays wide across the front. The centered front entry has a one-story, one-bay wide flat roofed porch. The porch has overhanging eaves, a wide entablature with dentils and decorative brackets, a pair of slender round columns, and two engaged columns. The capitals are Tuscan in derivation. The recessed front door has a rectangular single light transom. The trim around the doorway is like that of the windows, with a flat pedimented top and eared side boards.

The windows are two-over-two, double-hung wood sash. The elaborated surrounds have integral pedimented crowns and eared side trim. The attic window in the centered front gable pediment is fixed, with a round-arched top. There are two, flat-roofed, polygonal bays – one near the front of the south side wall, and another near the back of the north side wall. Both bays have the same type of wide, overhanging eaves, brackets, and dentils found on the front porch and main eaveline. The south elevation also features a centered, exterior fireplace.

Additions to the rear (east) of the main section of the house form an "L". These additions are one-story, flat-roofed, and have beveled siding on the north and south elevations. The walls facing into the "L" or to the rear have been clad with narrower, wood clapboards. A modern raised deck with brick foundation is set within the rear "L". The rear additions have been in place since before 1926; they show up on the Sanborn map of the house published then.

The front door opens to a relatively wide formal stair hall, which retains its early or original wood floors, plaster walls and long U-shaped staircase. (See photo 7.) The staircase features a large

United States Department of the Interior
National Park Service

National Register of Historic Places
Continuation Sheet

Section number 7 Page 2

Keith, David, House
St. Louis County, Missouri
Historic Resources of Kirkwood, Missouri

tapered turned newel post, with a balustrade of delicate spindles. Much of the original door and window trim is intact, and in very good condition. The trim around many of the interior openings is very like that found on the outside of the house, with simple pedimented lintels which overhang the side trim slightly, for an "eared" effect. (See photo 8.) There is also an interior entrance to the vaulted stone cellar; the cellar is reached via a trap door which blends into the early wood floor. (See photos 9 and 10.)

The lot is over a third of an acre, and has many mature deciduous shade trees which enframe the house. Small to medium size coniferous trees have been planted on the north side of the property, which includes paved drive leading to a non-contributing, three-car cinderblock garage at the rear. A curving concrete walkway leads from the driveway at the north side to the brick steps of the front porch. Foundation plantings include trimmed evergreen shrubs, deciduous shrubs, and perennial plants.

The Keith house is highly intact, and in excellent condition. It has seen no exterior alterations of note in over a century, and is immediately recognizable as one of the oldest houses in the core of Kirkwood today. △

United States Department of the Interior
National Park Service

National Register of Historic Places
Continuation Sheet

Section number 7 Page 3

Keith, David, House
St. Louis County, Missouri
Historic Resources of Kirkwood, Missouri

Figure One. Site plan and photo key.

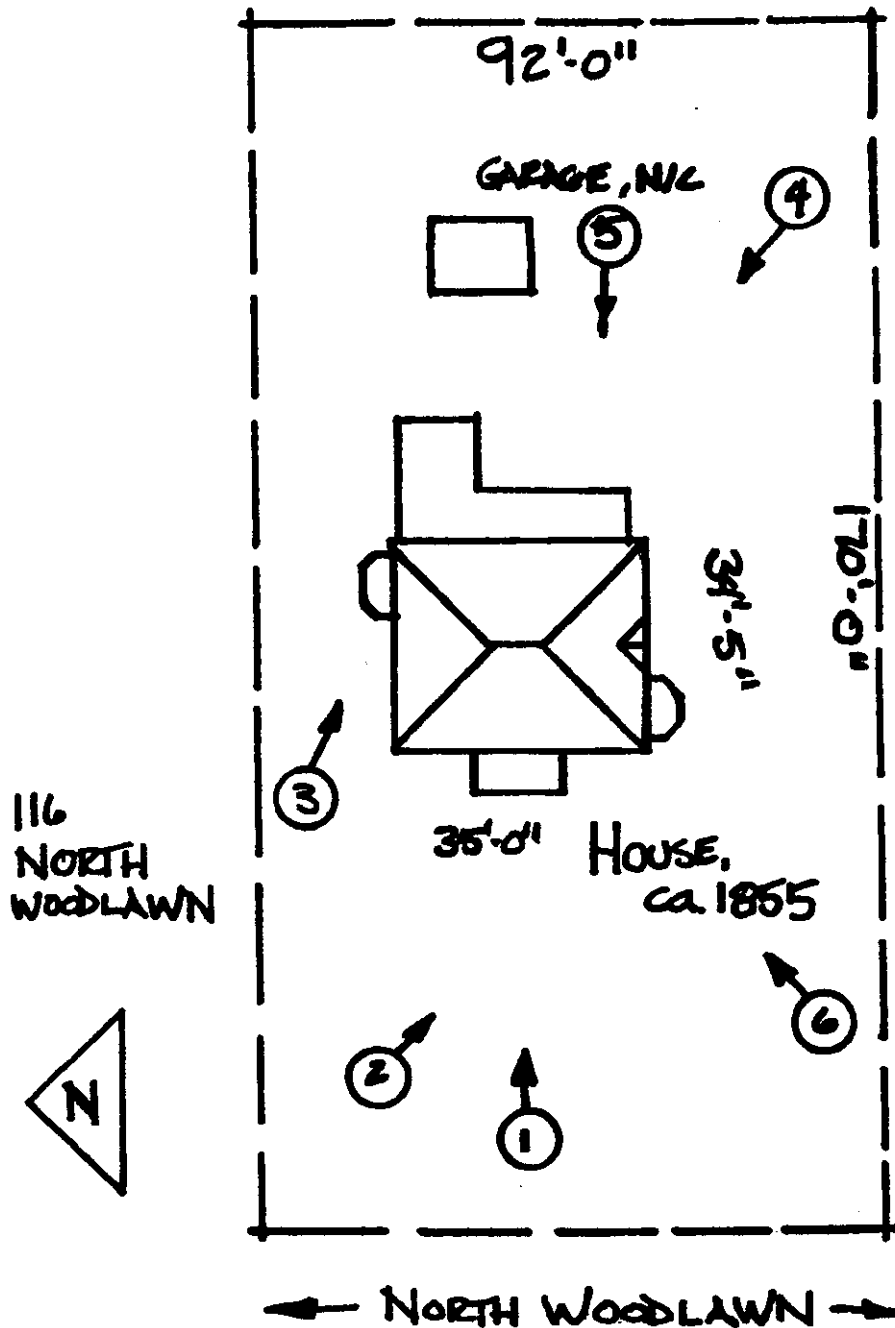

United States Department of the Interior
National Park Service
National Register of Historic Places
Continuation Sheet

Section number 8 Page 4

Keith, David, House
St. Louis County, Missouri
Historic Resources of Kirkwood, Missouri

Summary: The David Keith House, 116 N. Woodlawn, is significant under Criterion C in the area of ARCHITECTURE. Constructed just a few years after the town was platted, this is one of the earliest surviving examples of the Italianate style left in the historic core of Kirkwood, and one of the oldest houses of any type. Its low-pitch hip roof with widely overhanging eaves, cornice line brackets, denticulated frieze board, and wood siding with matching quoins which imitate stone are all typical of Property Type B.: Italianate Houses. The house meets the registration requirements for that property type set forth in the MPS Cover document "Historic Resources of Kirkwood, Missouri," and falls under the context "The Creation of Kirkwood, a Planned Railroad Suburb--1851-1864." Although this high-style house is clearly of the Italianate property type, it also has characteristics often identified with the Greek Revival style. Typically Greek Revival elements include a symmetrical facade and conservative cubic massing, as well as straight topped windows surrounded by pedimented and "eared" trim. The presence of such features is not surprising, as the Greek Revival style had been popular for decades at the time the house was built. The house was built ca. 1855 by or for David Keith, and the period of significance for the property corresponds to the construction date. The only other resource on the property is a modern three car garage, which is a non-contributing building. The house is in excellent condition, and exhibits a high degree of integrity of location, design, materials, workmanship, feeling and association.

Elaboration: The Keith house is a very early example of the Italianate House property type.¹ It was built at a time of transition between the Greek Revival and Italianate styles, a fact which is reflected by different stylistic elements of the house. The Greek Revival style had dominated American architecture for decades, while the Italianate was just coming into favor. As one national study of house styles noted, few pre-1855 examples of the Italianate style can be found.² The Keith house thus stands as a highly innovative house for its time. It seems likely that it was a trend-setter in the community, serving as a model for other property owners who were planning for houses in the new suburb. It is the oldest known resource to utilize the distinctive siding and quoin system which emulates stone work, and may have been the house to introduce such a treatment to local builders. Other Italianate features of note include the prominent bracketed cornice and polygonal windows bays, which enliven the otherwise cubic form.

The relatively early construction date of the Keith House is reflected by the presence of a few design features which are more typical of Greek Revival houses in Kirkwood than local Italianate

¹ See MPS Cover document "Historic Resources of Kirkwood, Missouri, Section F, Associated Property Types," for more discussion of the Italianate House property type.

² McAlester, Lee and Virginia, A Field Guide to American Houses, (New York: Alfred A. Knopf, 1986). p. 214.

United States Department of the Interior
National Park Service
National Register of Historic Places
Continuation Sheet

Section number 8 Page 5

Keith, David, House
St. Louis County, Missouri
Historic Resources of Kirkwood, Missouri

examples. The facade of the house, for example exhibits a symmetrical Classicism which is more common to Greek Revival houses in the area than to Italianate dwellings. In Kirkwood, almost all Italianate houses have an irregular form and asymmetrical facade. The pedimented front cross gable and columned front porch are also features commonly found on Greek Revival houses, as is the pedimented and "eared" door and window trim found on both the interior and exterior of the house. It should be noted that many of those features can also be found on early Italianate houses in the community, and that overall, the style of the house is most accurately described as Italianate.

The house has been credited in local landmark files as having been built by or for David Keith in 1850.³ As that date precedes the creation of both Kirkwood and the street which this house faces, the construction date here has been set at ca. 1855, two years after streets were platted and lots in Kirkwood were first offered for sale. David Keith was known to have been living in the community around that time. He was especially active in the early development of the Presbyterian Church of Kirkwood. In 1857, the Kirkwood Association gave him and two other men a lot upon which the congregation soon after built their first church. He was still in the area and active in the church a decade later. He was one of eleven men who signed the articles of incorporation for the Presbyterian congregation in December of 1867, and he later helped convey the church lot to the newly incorporated church.⁴

A later owner of this land was Lizzie McLagan, who bought forty acres, including this house lot, in 1863.⁵ By 1878, the forty acres had been subdivided, with this house occupying about a quarter of the block.⁶ The house and land were owned by Nannie Q. Harris at that time. Nannie Harris was the wife of Nicholas C. Harris, a plug tobacco manufacturer with his own company, N.C. Harris and Company, who was residing in St. Louis in 1875.⁷ It does not appear that the Harris family ever lived full time in Kirkwood, however. One history of St. Louis which was written in 1909 noted that N. C. Harris had built a house in the city, and that "Mrs. (Nannie) Harris still occupies her home on Westminster Place."⁸ The Kirkwood house may have been a country retreat, or simply an

³ "Historic Kirkwood Landmarks", Kirkwood: (Kirkwood Landmarks Commission, 2001) p. 15.

⁴ June Wilkinson Dahl, A History of Kirkwood, Missouri: 1861-1965, (Kirkwood, MO.: The Kirkwood Historical Society, 1965) p. 114.

⁵ Book 273, page 397, at the Recorder of Deeds Office of St. Louis.

⁶ Julius Pitzman, Atlas of St. Louis City and County, 1878, (Philadelphia: A. B. Holcombe and Co., 1878).

⁷ Gould's St. Louis Directory, 1875.

⁸ Walter Stevens, St. Louis, the Fourth City, Vol 2. (St. Louis: S. J. Clarke Publishing Co, 1909) p. 323.

**United States Department of the Interior
National Park Service**

**National Register of Historic Places
Continuation Sheet**

Section number 8 Page 6

**Keith, David, House
St. Louis County, Missouri
Historic Resources of Kirkwood, Missouri**

investment for the Harrises.

St. Louis County deed records show that John A. and Fannie McElroy owned the property in the 1880s, and sold it to Anna M. Hallstrom in 1893. Sarah and Joseph B. Greensfelder bought the property in 1907. Joseph Greensfelder was a well-known justice of the peace in nearby Clayton, who was known as the "marrying justice."⁹ He also helped found the Kirkwood Savings Bank, and served as its first president. Locally, the house is known as the Keith-Greensfelder House.

The Keith House continues in its original single family function, and it exhibits a very high level of integrity and craftsmanship. It is an important early high-style house, and one of the oldest in the community today. [△]

⁹ "Historic Kirkwood Landmarks", p. 15

United States Department of the Interior
National Park Service
National Register of Historic Places
Continuation Sheet

Section number 9 Page 7

Keith, David, House
St. Louis County, Missouri
Historic Resources of Kirkwood, Missouri

Bibliography

- Dahl, June Wilkinson. A History of Kirkwood, Missouri: 1861-1965. Kirkwood, MO.: The Kirkwood Historical Society, 1965.
- Edward's Annual Directory of St. Louis. 1865-1867.
- Johnson, Berkeley E. Atlas of St. Louis County. Clayton, MO: C. B. Black, 1893.
- "Historic Kirkwood Landmarks," Kirkwood: Kirkwood Landmarks Commission, 2001.
- McAlester, Lee and Virginia. Field Guide to American Houses. New York: Alfred Knopf, 1986.
- Northwest Publishing Company. Plat Book of St. Louis County. Des Moines: IA, Northwest Publishing Company, 1909.
- Pitzman, Julius. Atlas of St. Louis City and County, 1878. Philadelphia: A. B. Holcombe and Co., 1878.
- Sanborn Fire Insurance Company, Map of Kirkwood, 1926.

United States Department of the Interior
National Park Service

National Register of Historic Places
Continuation Sheet

Section number 10, photographs Page 8

Keith, David, House
St. Louis County, Missouri
Historic Resources of Kirkwood, Missouri

Verbal Boundary Description

A tract of land in the Northwest quarter of Section 6, Township 44 North, Range 6 East in St. Louis County, Missouri and described as: Beginning at a point in the East line of Woodlawn Avenue, distant North 1 degree 25 minutes east, 176.0 feet from its intersection with the North line of Argonne Drive; thence South 87 degrees 43 minutes East, 170 feet; thence North 1 degree 25 minutes East, 95.75 feet; thence north 87 degrees, 42 minutes West, 64.43 feet; thence South 88 degrees 4 minutes West, 105.74 feet to the East line of Woodlawn Avenue; thence along said East line, South 1 degree 25 minutes West, 87.95 feet to the point of beginning, having a total acreage of 0.359 acres.

Boundary Justification

The boundaries current boundaries encompass all of the land currently associated with the house.

Photographs

The following information is the same for all photographs:

Keith, David, House
116 North Woodlawn
Kirkwood, St. Louis County, MO

1,6, taken by Debbie Sheals, 406 West Broadway, Columbia, MO 65203; date: 2002
2-5, 7-10 taken by Linda Stockmann, 139 South Kirkwood Rd, Kirkwood, MO, 63122; date: 1990
(The house was field checked in 2002 to ensure the 1990 photos are still accurate.)
Negatives are on file with the City of Kirkwood Dept of Planing and Development, 139 South Kirkwood Road, Kirkwood, MO 63122, 314-822-5808.

List of Photographs

See photo key for indication of camera angles.

1. Facade, west elevation.
2. Facade from northwest.
3. North elevation and window bay.
4. Southeast corner.
5. East elevation.
6. Southwest corner.
7. Stair Hall.
8. Window bay interior.
9. Trap door to cellar.
10. Cellar, with vaulted ceiling.

United States Department of the Interior
National Park Service
National Register of Historic Places
Continuation Sheet

Section number 11 Page 9

Keith, David, House
St. Louis County, Missouri
Historic Resources of Kirkwood, Missouri

11. Form Prepared By

Name Linda Stockman
organization Kirkwood Landmark Commission date 1990
street & number 139 South Kirkwood Road telephone (314) 822-5808
city or town Kirkwood state Missouri zip code 63122

Name Deon K. Wolfenbarger
organization Three Gables Preservation date 1992
street & number 9550 N.E. Cookingham Drive telephone (816) 792-1275
city or town Kansas City state Missouri zip code 64157

Name Debbie Sheals
organization Independent Contractor date May, 2002
street & number 406 West Broadway telephone 573-874-3779
city or town Columbia state Missouri zip code 65203



ONE SIXTEEN



ONE SIXTEEN















