

MISSISSIPPI RIVER

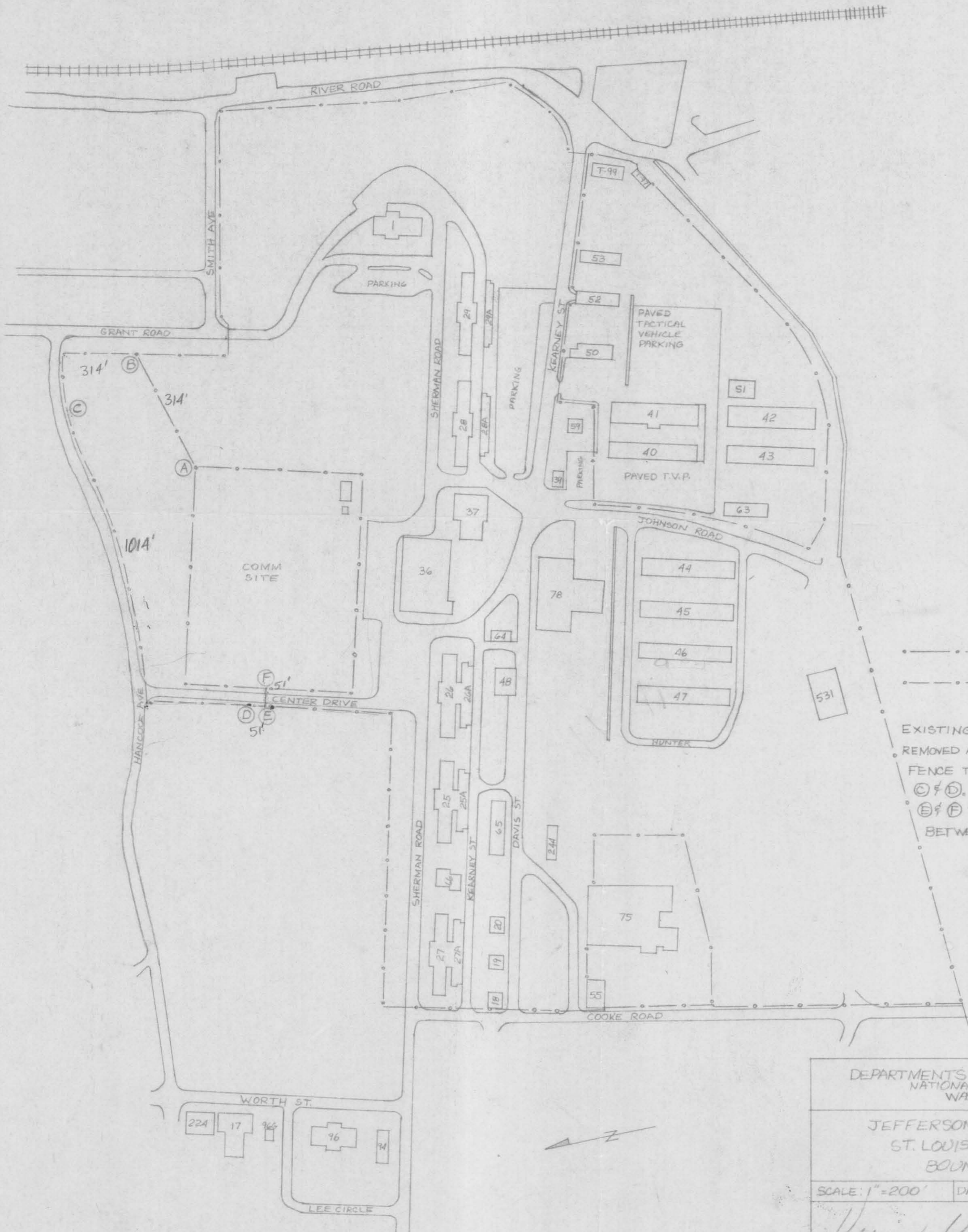

- EXISTING FENCE, CHAIN LINK.
- - - - - PROPOSED FENCE, CHAIN LINK.

EXISTING FENCE BETWEEN A & B TO BE REMOVED AND RESET BETWEEN B & C. NEW FENCE TO BE INSTALLED BETWEEN C & D. EXISTING FENCE BETWEEN E & F TO BE REMOVED AND RESET BETWEEN D & E.

DEPARTMENTS OF THE ARMY AND AIR FORCE
NATIONAL GUARD BUREAU
WASHINGTON, D.C.

JEFFERSON BARRACKS ANG BASE
ST. LOUIS COUNTY, MISSOURI
BOUNDARY FENCE

SCALE: 1" = 200'	DATE: 30 APR 71	DRAWN BY: CEN
<i>Vernon V. Cook</i> BASE CIVIL ENGINEER		PROJECT NO NGB-71-3 SHEET 1 OF 1