

United States Department of the Interior
National Park Service

National Register of Historic Places Registration Form

This form is for use in nominating or requesting determinations for individual properties and districts. See instructions in *How to Complete the National Register of Historic Places Registration Form* (National Register Bulletin 16A). Complete each item by marking "x" in the appropriate box or by entering the information requested. If an item does not apply to the property being documented, enter "N/A" for "not applicable." For functions, architectural classification, materials, and areas of significance, enter only categories and subcategories from the instructions. Place additional entries and narrative items on continuation sheets (NPS Form 10-900a). Use a typewriter, word processor, or computer, to complete all items.

1. Name of Property

historic name Harold/Knoernschild Farmstead Historic District
other names/site number Centennial Farm

2. Location

street & number 199 Jackson Street n/a
 not for publication
city or town Augusta n/a
 vicinity
state Missouri code MO county St. Charles code 183 zip code 63332

3. State/Federal Agency Certification

As the designated authority under the National Historic Preservation Act, as amended, I hereby certify that this nomination request for determination of eligibility meets the documentation standards for registering properties in the National Register of Historic Places and meets the procedural and professional requirements set forth in 36 CFR Part 60. In my opinion, the property meets does not meet the National Register criteria. I recommend that this property be considered significant nationally statewide locally. (See continuation sheet for additional comments.)

Claire F. Blackwell 9 August 1994
Signature of certifying official/Title Claire F. Blackwell Date
Deputy SHPO
Missouri Department of Natural Resources
State of Federal agency and bureau

In my opinion, the property meets does not meet the National Register criteria. (See continuation sheet for additional comments.)

Signature of certifying official/Title Date

State or Federal agency and bureau

4. National Park Service Certification

I hereby certify that the property is:

<input type="checkbox"/> entered in the National Register. <input type="checkbox"/> See continuation sheet.	Signature of the Keeper	Date of Action
<input type="checkbox"/> determined eligible for the National Register <input type="checkbox"/> See continuation sheet.	_____	_____
<input type="checkbox"/> determined not eligible for the National Register.	_____	_____
<input type="checkbox"/> removed from the National Register.	_____	_____
<input type="checkbox"/> other, (explain:)	_____	_____

Harold/Knoernschild Farmstead
Name of Property

St. Charles Co. MO
County and State

5. Classification

Ownership of Property
(Check as many boxes as apply)

- private
- public-local
- public-State
- public-Federal

Category of Property
(Check only one box)

- building(s)
- district
- site
- structure
- object

Number of Resources within Property
(Do not include previously listed resources in the count.)

Contributing	Noncontributing	
4		buildings
		sites
		structures
		objects
4	0	Total

Name of related multiple property listing
(Enter "N/A" if property is not part of a multiple property listing.)

Historic Resources of Augusta, MO

Number of contributing resources previously listed
in the National Register

0

6. Function or Use

Historic Functions
(Enter categories from instructions)

AGRICULTURE /Agricultural outbldg.
DOMESTIC/single dwelling

Current Functions
(Enter categories from instructions)

AGRICULTURE/agricultural outbuildin
DOMESTIC/single dwelling

7. Description

Architectural Classification
(Enter categories from instructions)

no style

Materials
(Enter categories from instructions)

foundation stone

walls WOOD

BRICK

roof METAL

other ASPHALT

Narrative Description

(Describe the historic and current condition of the property on one or more continuation sheets.)

Harold/Knoernschild Farmstead
Name of Property

St. Charles Co., MO
County and State

8. Statement of Significance

Applicable National Register Criteria
(Mark "x" in one or more boxes for the criteria qualifying the property for National Register listing.)

- A** Property is associated with events that have made a significant contribution to the broad patterns of our history.
- B** Property is associated with the lives of persons significant in our past.
- C** Property embodies the distinctive characteristics of a type, period, or method of construction or represents the work of a master, or possesses high artistic values, or represents a significant and distinguishable entity whose components lack individual distinction.
- D** Property has yielded, or is likely to yield, information important in prehistory or history.

Criteria Considerations
(Mark "x" in all the boxes that apply.)

Property is:

- A** owned by a religious institution or used for religious purposes.
- B** removed from its original location.
- C** a birthplace or grave.
- D** a cemetery.
- E** a reconstructed building, object, or structure.
- F** a commemorative property.
- G** less than 50 years of age or achieved significance within the past 50 years.

Areas of Significance
(Enter categories from instructions)

Ethnic Heritage: European
Architecture

Period of Significance

ca. 1836-ca. 1920

Significant Dates

ca. 1836-1882
ca. 1860
ca. 1900

Significant Person

(Complete if Criterion B is marked above)

n/a

Cultural Affiliation

n/a

Architect/Builder

unknown

Narrative Statement of Significance
(Explain the significance of the property on one or more continuation sheets.)

9. Major Bibliographical References

Bibliography

(Cite the books, articles, and other sources used in preparing this form on one or more continuation sheets.)

Previous documentation on file (NPS):

- preliminary determination of individual listing (36 CFR 67) has been requested
- previously listed in the National Register
- previously determined eligible by the National Register
- designated a National Historic Landmark
- recorded by Historic American Buildings Survey # _____
- recorded by Historic American Engineering Record # _____

Primary location of additional data:

- State Historic Preservation Office
- Other State agency
- Federal agency
- Local government
- University
- Other

Name of repository:

Harold/Knoernschild Farmstead
Name of Property

St. Charles Co. MO
County and State

10. Geographical Data

Acreage of Property 2.5 acres

UTM References

(Place additional UTM references on a continuation sheet.)

1	1 5	6 8 4 3 0 0	4 2 7 1 3 8 5
	Zone	Easting	Northing
2			

3			
	Zone	Easting	Northing
4			

See continuation sheet

Verbal Boundary Description

(Describe the boundaries of the property on a continuation sheet.)

Boundary Justification

(Explain why the boundaries were selected on a continuation sheet.)

11. Form Prepared By

name/title Mary M. Stiritz

organization _____ date 5 January 1994

street & number 12 Wydown Terr. telephone 314-721-6289

city or town St. Louis state MO zip code 63105

Additional Documentation

Submit the following items with the completed form:

Continuation Sheets

Maps

A USGS map (7.5 or 15 minute series) indicating the property's location.

A Sketch map for historic districts and properties having large acreage or numerous resources.

Photographs

Representative black and white photographs of the property.

Additional Items

(Check with the SHPO or FPO for any additional items)

Property Owner

(Complete this item at the request of SHPO or FPO.)

name Robert and Ellen Knoernschild

street & number 199 Jackson St. telephone _____

city or town Augusta state MO zip code 63332

Paperwork Reduction Act Statement: This information is being collected for applications to the National Register of Historic Places to nominate properties for listing or determine eligibility for listing, to list properties, and to amend existing listings. Response to this request is required to obtain a benefit in accordance with the National Historic Preservation Act, as amended (16 U.S.C. 470 et seq.).

Estimated Burden Statement: Public reporting burden for this form is estimated to average 18.1 hours per response including time for reviewing instructions, gathering and maintaining data, and completing and reviewing the form. Direct comments regarding this burden estimate or any aspect of this form to the Chief, Administrative Services Division, National Park Service, P.O. Box 37127, Washington, DC 20013-7127; and the Office of Management and Budget, Paperwork Reduction Project (2601-0047), Washington, DC 20503.

United States Department of the Interior
National Park Service

National Register of Historic Places Continuation Sheet

Section number 7 Page 3 Harold/Knoernschild Farmstead District
St. Charles County, MO

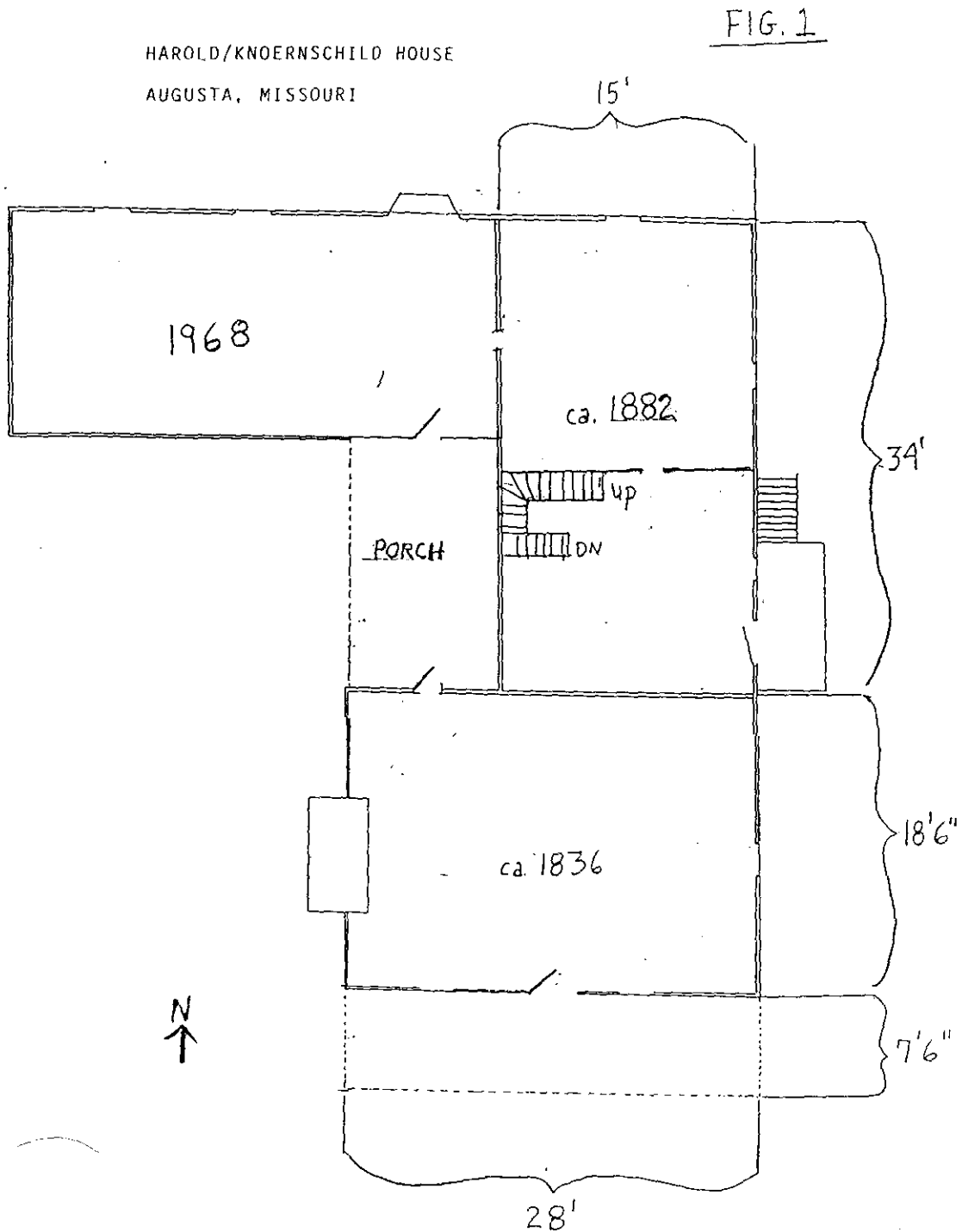

United States Department of the Interior
National Park Service

National Register of Historic Places Continuation Sheet

Section number 8 Page 4 Harold/Knoernschild Farmstead District
St. Charles County, MO

The Harold/Knoernschild Farmstead District is eligible for listing in the National Register under Criteria A and C and is significant in the following areas: ETHNIC HERITAGE: EUROPEAN Farm vineyards contributed to the growth and success of Augusta's wine industry which is an activity closely associated with the cultural traditions of Missouri Germans. German-born owner Christian Knoernschild figured prominently in the development of the local wine industry as one of the original incorporators and Directors of the Augusta Wine Company, a co-op founded by Augusta vintners to compete with larger wineries (See Historic Context, "German American Culture in Augusta, 1833-1944", subtheme: "Wine Industry, ca. 1850-1917"). ARCHITECTURE: The two-story log farmhouse built circa 1836 by Virginia-born Leonard Harold, founder of Augusta, is noteworthy for its early date and method of construction which are associated with pioneer settlement in the area. The one story brick addition to the house, erected circa 1882 by Christian Knoernschild, typifies Missouri German building traditions expressed in the use of segmentally arched openings, brick denticulation, and unembellished exterior (Property Type: Vernacular Residence). The agricultural outbuildings (circa 1860 barn, and early 20th century storage buildings) exhibit traditional forms, materials and methods of construction of their periods, and evoke farm life in the 19th and early 20th centuries (Property Type: Vernacular Residence, subtype: Outbuildings) (See subtheme, "Architecture ca. 1836-1943"). The period of significance was terminated in 1920, the approximate year that the last historic building was erected.

Compared to the typical small, temporary, log cabin of early settlement, the Leonard Harold house reflects the owner's economic success and established place in society by its substantial size and well-finished appearance. Rising two stories, the log house features a fine stone chimney with hearths on both stories, and a two-story, full facade porch with chamfered posts. At an early date the house was covered with weatherboarding, leaving logs exposed only on the front elevation which is sheltered by the porch roof. When the house was built (circa 1836), Harold, who had resided in the Augusta area since 1810, was a prosperous farmer and extensive landholder.(1) Among his holdings was a tract of 360 acres, part of which he laid out as the Town of Mt. Pleasant (renamed Augusta).

In 1854, Harold sold his farmstead to Bavarian-born Christian Knoernschild, who had emigrated to Ohio in 1847 but moved to a farm near Augusta in 1849. For many years the Harold log house met the

United States Department of the Interior
National Park Service

National Register of Historic Places Continuation Sheet

Section number 7 Page 1 Harold/Knoernschild Farmstead District
St. Charles County, MO

The Harold/Knoernschild Farmstead Historic District is located at 199 Jackson Street on the northwest side of the Town of Augusta, Missouri. The complex consists of a circa 1836 log farmhouse with circa 1882 brick addition (Property Type: Vernacular Residence); a circa 1860 frame barn; and two frame subordinate farm outbuildings dating to the early 20th century (Property Type: Vernacular Residence, subtype: Outbuildings). The buildings survive with minor alterations which do not substantially detract from the overall integrity of design and materials.

Farmhouse (Fig.1; Photos #2,#3).

Facing south, the two-story, three-bay, log section of the house measures approximately 28 feet wide by 18 1/2 feet deep; the two-story porch extends 7 1/2 feet from the house and is sheltered by a continuation of the principal gabled roof. The house rests on a stone basement. A massive stone chimney located on the west elevation opens to hearths on both floors. Weatherboarding covers all exterior walls except for the south (front) facade where logs are exposed. The original plan of the house is not known; at one time a partition (now removed) divided the first floor into two rooms; the second floor still retains a partition wall.

Joining the north (rear) wall of the log house (which originally featured a two-story back porch) is a circa 1882 brick addition with side-gabled roof. Resting on a stone basement, the brick addition features a hall-parlor plan with loft also divided into two rooms. A small gabled roof shelters the front door; original wood porch posts have been replaced with iron supports and railing standing on a concrete replacement floor. Segmental brick arches head all openings; brick dentils trim the front facade. In 1968, a one-story kitchen/dining/utility wing was constructed on the west side of the brick addition.

Barn (Photo #4, left).

Measuring approximately 64 X38 feet the barn employs post and beam construction with hand hewn oak and walnut timbers. The exterior walls are board and batten. The gabled roof, sheathed with corrugated tin, features a small ventilator cupola. Wide wagon doors are installed on opposing east and west elevations; four pedestrian doors are located on the east elevation and two on the south, gable end. Fenestration is irregular, consisting of small, multipane glazing.

United States Department of the Interior
National Park Service

National Register of Historic Places Continuation Sheet

Section number 7 Page 2 Harold/Knoernschild Farmstead District
St. Charles County, MO

Wagon shed (Photo #4, right).

Resting on a stone foundation, the circa 1900 vertical board building measures approximately 15 X 20 feet. The gabled roof is covered with tin. The west end of the building is open for wagon entry; the east end is enclosed for storage of grain.

Plow shed (Photo #5, left foreground).

Measuring approximately 11 X 18 feet, the circa 1920 vertical board building rests on a concrete foundation. The gabled roof is covered with tin sheathing. Two pairs of double doors give entry on the west elevation. Small windows with 6/6 lights are featured on the north gable end and on the east wall.

United States Department of the Interior
National Park Service

National Register of Historic Places Continuation Sheet

Section number 8 Page 5 Harold/Knoernschild Farmstead District
St. Charles County, MO

basic needs of the Knoernschild family while attention was focused on construction of the barn. Characteristically the most important building on a farm, to which the most money and care were given, the barn contributed directly to the economic security and success of the farmstead. Erected circa 1860, the Knoernschild barn features post and beam construction with hand hewn timbers of oak and walnut. Around 1882, Knoernschild enlarged the log house with a 1 1/2 story addition constructed of brick made from clay dug and fired on the farm land. The addition exhibits typical Missouri German vernacular traditions such as the hall-parlor plan, dormered side-gabled roof, segmentally arched openings, and simple, planar walls sparsely trimmed with brick dentils. Two ancillary multipurpose farm outbuildings, built by descendants of Christian Knoernschild, provided additional storage space for equipment in the early 20th century. The circa 1900 wagon shed/grain storage building and circa 1920 plow and tool shed employ traditional vertical board construction with tin-covered gabled roofs.

In 1867, Christian Knoernschild was elected Vice-President of the Board when the Augusta Wine Company incorporated that year. Organized to facilitate the making and sale of wine by farmers who raised grapes on a small scale and did not have private cellars or wineries, the company built a communal winery and cellar for the processing of grapes delivered by individual stockholders (see Walnut Street Historic District). Part of the Old World agricultural heritage of Missouri Germans, vineyards consisted of only a small acreage of the total improved farm land. The agricultural census of 1870 reported Christian Knoernschild produced a modest 100 gallons of wine. However in the 1880 census, Knoernschild reported three acres in vineyards (out of 75 tilled acres), 80 gallons of wine made, and 13,000 pounds of grapes sold in 1879. Since no business records of the Augusta Wine Co. survive and 1880 was the last federal agricultural census taken, it can only be assumed that the Knoernschild farm maintained vineyards until Prohibition.

The Knoernschild farmstead, now named Centennial Farm, is owned and operated today by the fifth generation of the Christian Knoernschild family.

NOTES

- 1) Robert and Ellen Knoernschild, Before There Were Germans: Augusta's Anglo-American Settlers, (Augusta, MO: n.p., 1993)

United States Department of the Interior
National Park Service

National Register of Historic Places Continuation Sheet

Section number 9,10 Page 6 Harold/Knoernschild Farmstead District
St. Charles County, MO

9. Major Bibliographic References

Knoernschild, Robert and Ellen. Before There Were Germans: Augusta's Anglo-American Settlers. Augusta, MO: N.p., 1993.

Mallinckrodt, Anita M. Historic Augusta, MO. Augusta, MO: Augusta Historical Society, 1994.

(see Section I, "Historic Resources of Augusta, Missouri" MPS, for additional references.)

10. Geographical Data

Verbal Boundary Description: District boundaries are indicated by the heavy broken line on the map entitled "Architectural Survey of Augusta," scale 1"=100'.

Boundary Justification: Boundaries were drawn to encompass all of the significant properties associated with the farmstead during its period of significance, including the house, circa 1860 barn, circa 1900 wagon shed, and circa 1920 plow shed.

United States Department of the Interior
National Park Service

National Register of Historic Places Continuation Sheet

Section number 10 Page 7 Harold/Knoernschild Farmstead District
St. Charles County, MO

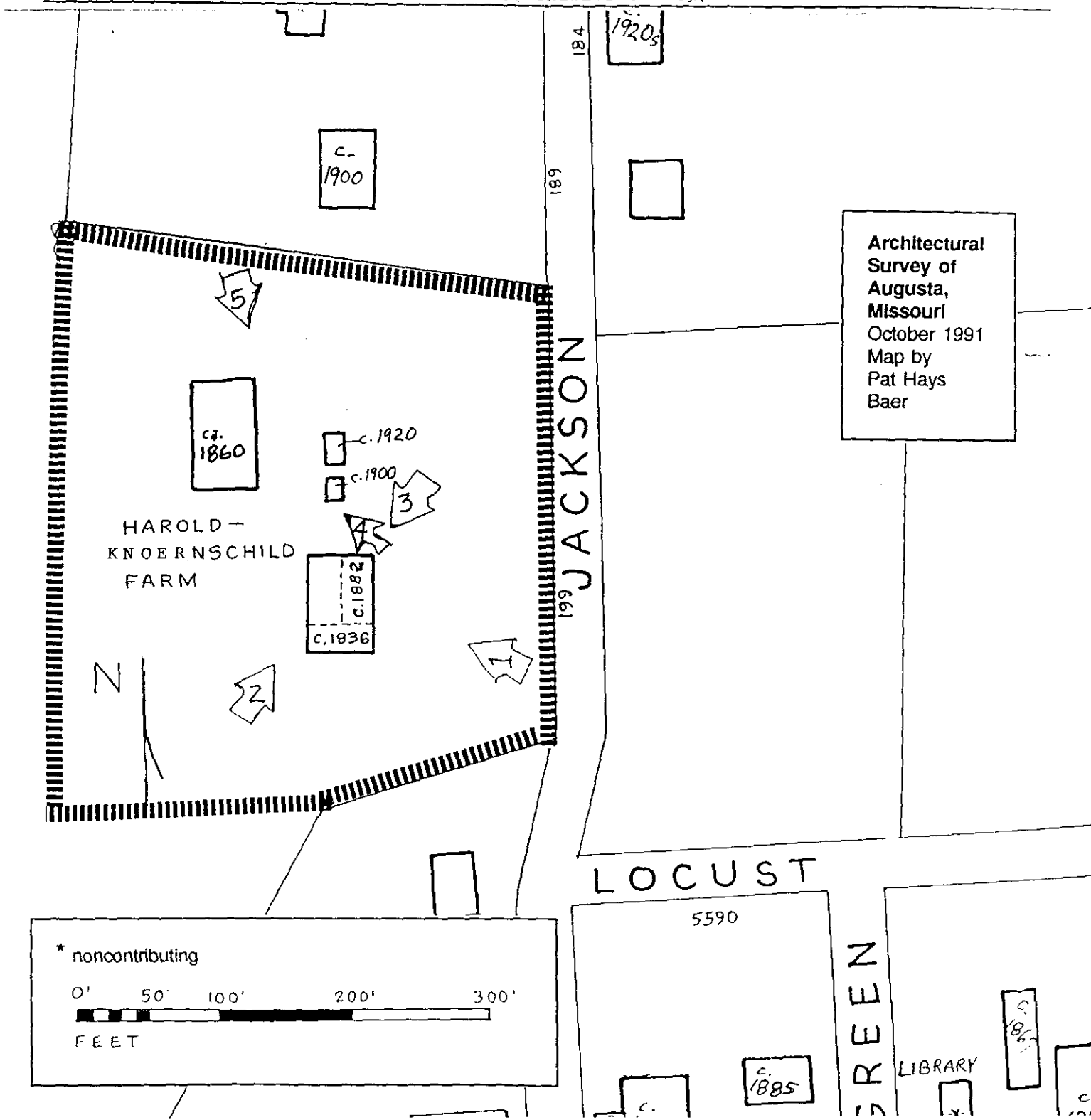

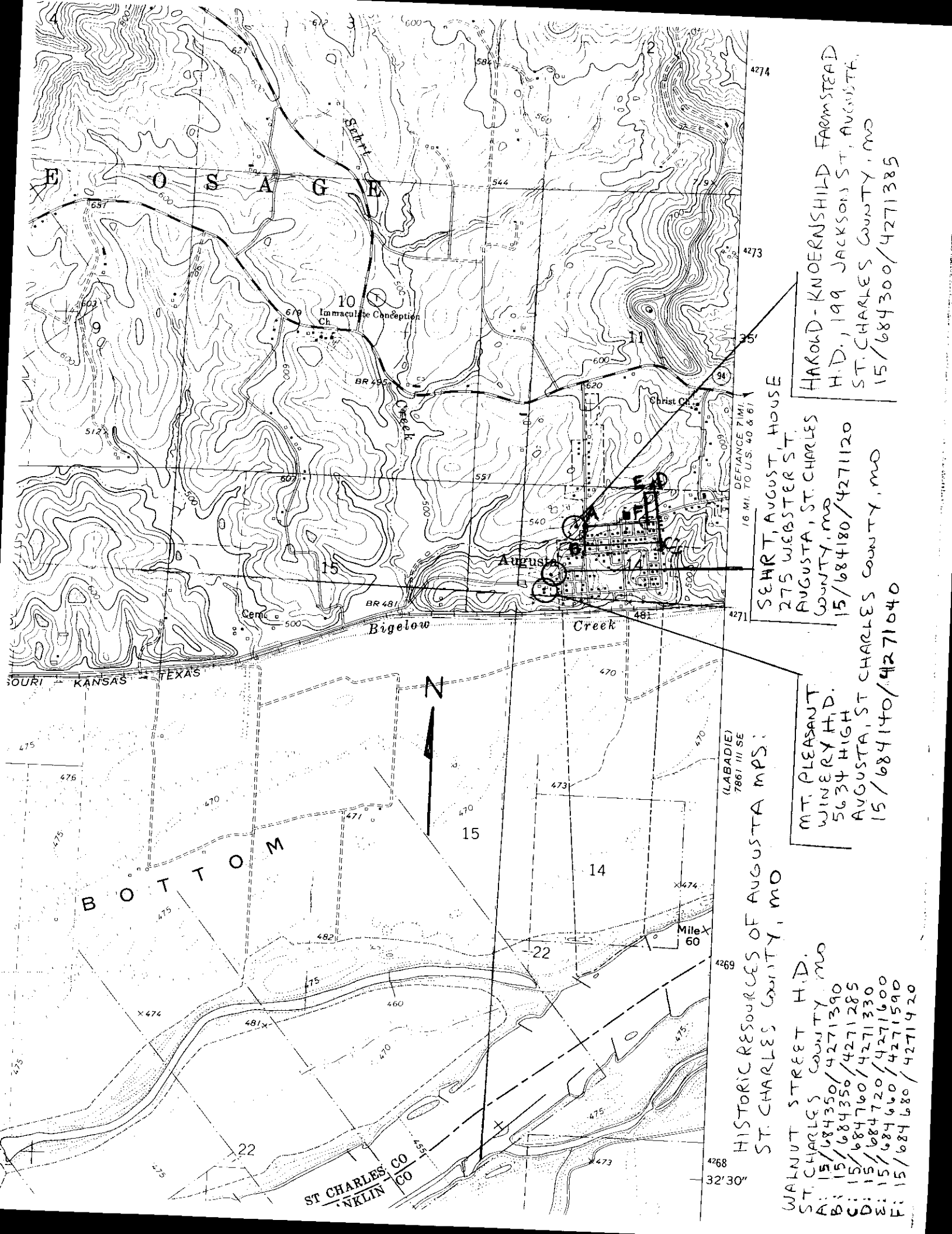

HAROLD-KNOERNSHILD FARMSTEAD
 H.D., 199 JACKSONS ST, AUGUSTA,
 ST. CHARLES COUNTY, MO
 15/684300/4271385

SEHRT, AUGUST HOUSE
 275 WEBSTER ST
 AUGUSTA, ST. CHARLES
 COUNTY, MO
 15/684180/4271120

MT. PLEASANT
 WINERY H.D.
 5634 HIGH
 AUGUSTA, ST CHARLES
 15/684140/4271040

HISTORIC RESOURCES OF AUGUSTA MPS:
 ST. CHARLES COUNTY, MO

WALNUT STREET H.D.
 ST. CHARLES COUNTY, MO
 A: 15/684350/4271390
 B: 15/684350/4271285
 C: 15/684760/4271330
 D: 15/684720/4271600
 E: 15/684660/4271590
 F: 15/684680/4271420

ST CHARLES CO
 WINKLIN CO

32'30"

1.6 MI. TO U.S. 40 & 61
 DEFILANCE 71MI.

- 1) Harold/Knoernschild Farmstead Hist. District
- 2) Augusta, MO
- 3) MARY STIRITZ
- 4) Dec 1993
- 5) MO Dept. Natural Resources
- 6) General view of Farm
camera facing west
- 7) #1



- 1) Harold/Knoenschild Farmstead
(Leonard Harold Log house)
- 2) Augusta, MD
- 3) MARY STIRITZ
- 4) Dec. 1993
- 5) MO Dept Natural Resources
- 6) Primary (south) + west ELEU's.
camera facing NE
- 7) # 2

5/6



- 1) HAROLD KNOENSCCHILD Farmstead
(G. Knoernschild House (addition))
- 2) Augusta, MO
- 3) MARY STIRITZ
- 4) Dec. 1993
- 5) MO Dept. Natural Resources
- 6) North + East ELEV's. of house
camera facing SW
- 7) # 3

+2
+5/6
4.5



- 1) Harold / Knoerhschild FARMSTEAD
BARN (left) + wagonshed
- 2) Augusta, MO
- 3) MARY STIRITZ
- 4) Dec. 1993
- 5) MO Dept. Natural Resources
- 6) south + east elev's.
camera facing NW
- 7) # 4



- 1) HAROLD/KNOERNSCHILD FARMSTEAD (outbuildings)
- 2) Augusta, MO
- 3) MARY STIRITZ
- 4) Dec. 1993
- 5) MO Dept. Natural Resources
- 6) North & West elev's,
camera facing SE
- 7) # 5

