

SECTION IV. CREATING AN LWCF BOUNDARY MAP

When applying for a LWCF grant, project sponsors must submit a signed and dated project boundary map which clearly delineates the area to be protected under the LWCF Act. **Land identified within the LWCF boundary must be retained in perpetuity for public outdoor recreation use.** Generally this area includes the entire park where recreation is being developed, except in unusual cases where it can be shown that a facility within an area is clearly self-sustaining (and accessible) without reliance on the surrounding area. The project area must be readily accessible through a public corridor (i.e. parking lot, street, permanent public easement, etc.). **Maps should be no bigger than 11" x 17"**. Maps may be drawn on a satellite or aerial image. **Full-color images are preferred.** Use the checklist below to ensure all the required elements have been included on your LWCF boundary map, and refer to the boundary map template on page 21 that shows a numeric legend of the corresponding elements. The numerical grid provided is for reference only to help identify each element and does not need to be reproduced on the boundary map you submit with your application.

- 1. Title the map as "LWCF Boundary Map."
- 2. Include the official name of the park, site or project.
- 3. Include a north arrow.
- 4. Provide a signature and date on the map by the individual authorized in the resolution.
- 5. Include the date of map preparation.
- 6. Clearly indicate dimensions of the park area with measurements in feet on each side to effectively illustrate the area that will be under LWCF protection. **Use a bright and bold color for the LWCF boundary and use a dash and dot system to delineate the area.** The map needs to indicate entrance/access point(s) that are connected to city or county roads.
- 7. If applicable, identify any pre-existing uses (buildings/non-outdoor recreation facilities) that do not support outdoor recreation and that should be excluded from LWCF protection. Include the square footage of the non-supporting facility or area footprint. Subtract this square footage from the total square feet of the area to be protected under by the LWCF boundary.
- 8. If applicable, include any area or resource upon which the project is dependent, even if the area/resource was not included in the project scope. An example of this would be an existing parking lot that provides the sole access to a picnic area that is being developed with a LWCF grant. The parking lot would need to be included in the LWCF boundary and its footprint added to the total square footage.
- 9. If applicable, indicate any outstanding rights and interest in the area, including easements, deed/lease restrictions, reversionary interests, rights-of-way, utility corridors, potential mortgages, etc.
- 10. Indicate adjacent street names, bodies of water and any other features that could be used as identifying landmarks.
- 11. If applicable, indicate any areas under lease with term of at least 25 years remaining on the lease.
- 12. Indicate assessor's parcel number(s).
- 13. Provide the latitude and longitude of the main project entrance. Use decimal degrees (ex: 38.5573/-92.15260)
- 14. Indicate the location of the project area (use a different color and dash & dot system to delineate the area then what was used for the boundary. Add a key or legend to the map.
- 15. Convert the total square footage to acreage and indicate total acreage within the LWCF boundary. The acreage identified on the boundary map must be consistent with the acreage identified in Question 15 on the application form.

LWCF BOUNDARY MAP TEMPLATE

1 LWCF Boundary Map

2 Memorial Park

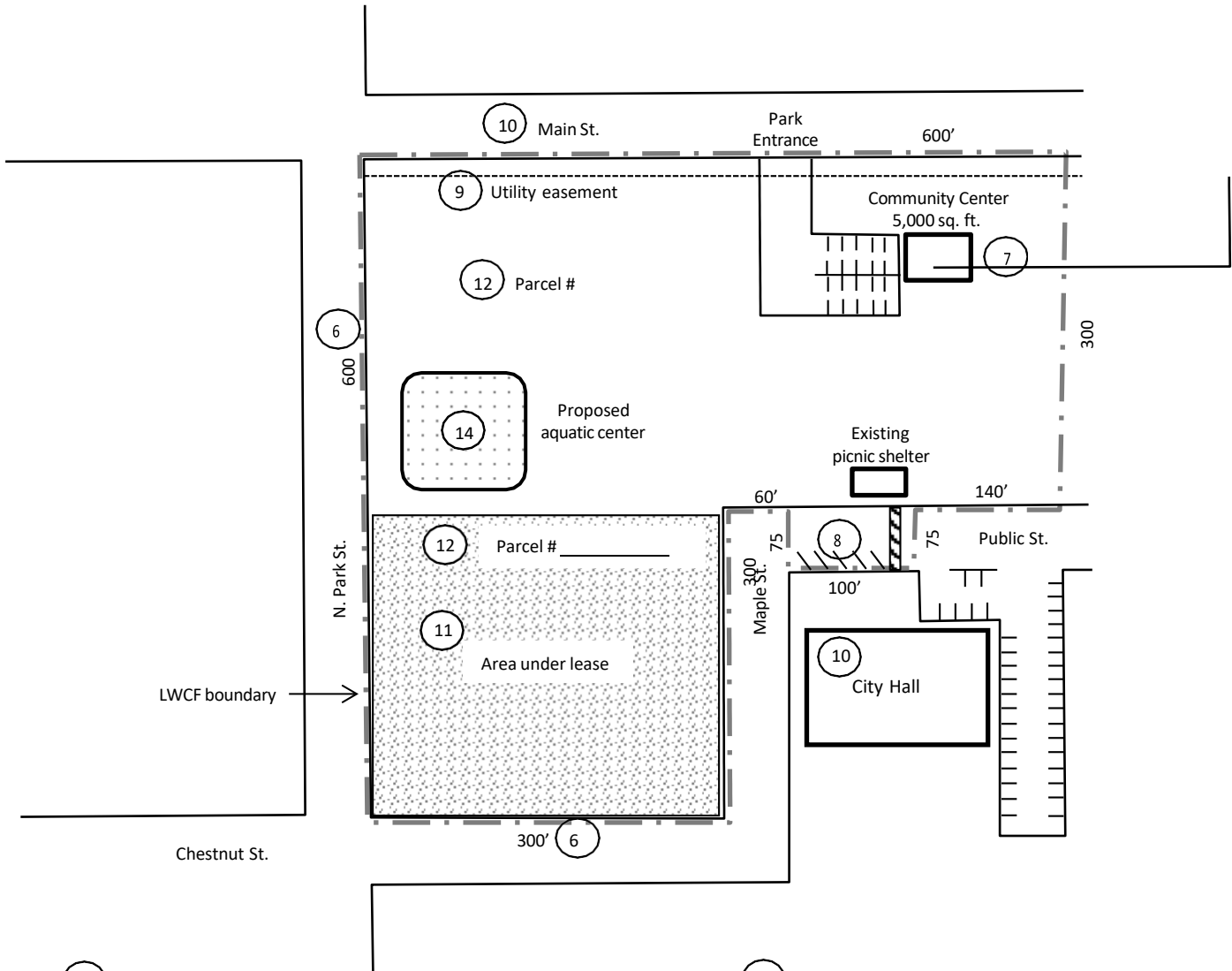

4 _____

Signature & date of authorized individual

13 _____

Latitude & longitude of park entrance

5 _____

Date of map preparation

15 _____

LWCF boundary acreage